

# Power Contacts

## Female

- ❖ 20A max current rating.
- ❖ Solder Contacts are removable using extraction tool Z80-290 (see page 79).



### VERTICAL PC TAIL

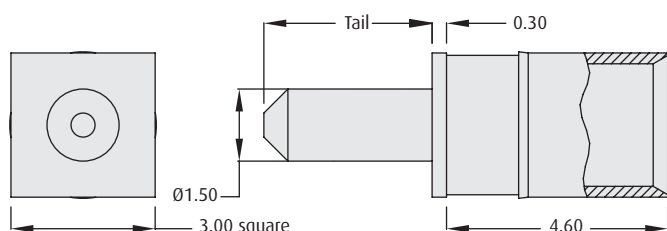

TAIL LENGTH	ORDER CODE (LOOSE)	PART CODE (FITTED)
3.5mm	<b>M80-321</b>	<b>321</b>
5.0mm	<b>M80-322</b>	<b>322</b>

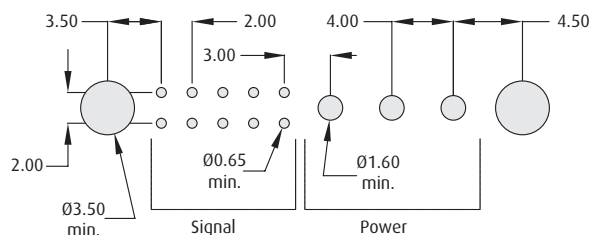

### SOLDER STRAIGHT

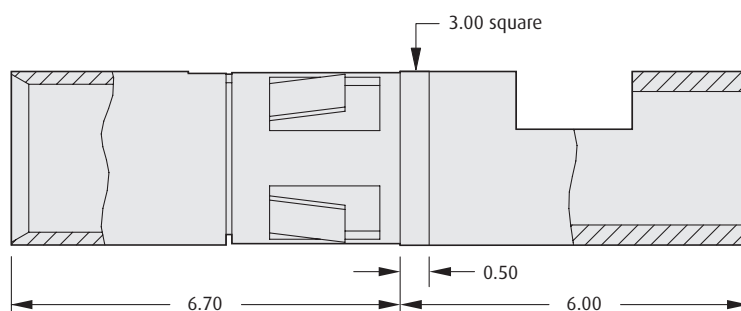

CABLE DIAMETER (MAX)	AWG	CURRENT RATING	ORDER CODE (LOOSE)	PART CODE (WITH ASSEMBLY)
2.3mm	12	20A	<b>M80-325</b>	<b>325</b>
2.0mm	14	15A	<b>M80-326</b>	<b>326</b>
1.5mm	16	10A	<b>M80-327</b>	<b>327</b>

All dimensions in mm.

[www.harwin.com](http://www.harwin.com)

