

10 9 8 7 6 5 4 3 2 1

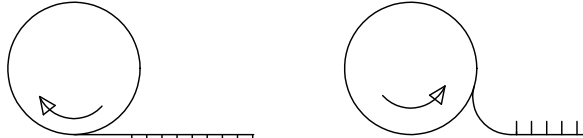

'A' WINDING REEL
PER ES 339

'B' WINDING REEL
PER ES 339

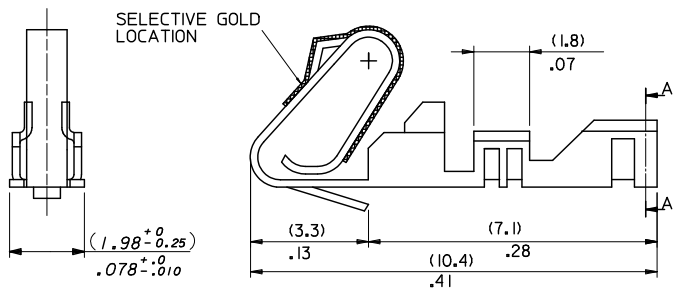

97-00-0001	4809C-(P918)BF	CHAIN	(P918)	(2.45-1.75)/.096-.069
PART No	ENG No	FORM	FINISH (SEE NOTE-2)	DIM . A
'A' WINDING PER E.S. 339				

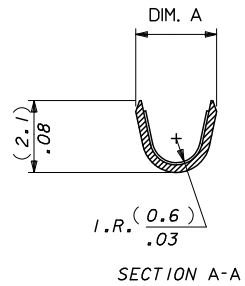

SECTION A-A

4809C-(*) * *
 INSULATION CRIMP WIDTH
 BLANK: DIM. A = (2.1)/.083 REF.
 M: DIM. A = (2.2)/.087 REF.
 FORM:
 BLANK = CHAIN FORM, TOP FEEDING REEL
 L = LOOSE FORM
 BF = CHAIN FORM, BOTTOM FEEDING REEL

08-55-0112	4809C-(555)	CHAIN	(555)	(2.45-1.75)/.096-.069
08-50-0030	4809C-(P918)M	CHAIN	(P918)	(2.35-2.05)/.093-.081
08-50-0031	4809C-(P918)	CHAIN	(P918)	(2.45-1.75)/.096-.069
08-50-0032	4809C-(P918)L	LOOSE	(P918)	(2.45-1.75)/.096-.069
PART No	ENG No	FORM	FINISH (SEE NOTE-2)	DIM . A
'B' WINDING PER E.S. 339 (CHAIN ONLY)				

- NOTES:
1. MATERIAL (0.20±0.01)/.008±.0004 THICK BRASS.
 2. FINISH: (555) - SELECTIVE GOLD (0.00038)/0.000015 MIN., OVERALL NICKEL (0.00076)/0.000030 MIN.
 (P918) - HOT TIN DIP: (0.00102-0.00305)/0.000040-.000120
 3. THIS PART CONFORMS TO MOLEX PRODUCT SPEC. PS-99020-0088.
 4. SAME AS SD-4809-* EXCEPT WITH CAT EARS.
 5. FOR 22-30 GAUGE WIRE & (1.57)/.062 DIA. INSULATION MAX.
 6. THIS PART CONFORMS TO CLASS B REQUIREMENTS OF COSMETIC SPECIFICATION PS-45499-002.

CORRECT PLATING EC NO: UCP2011-2131 DRAWN: STEWART 2011/01/18 CHECKED: W. PFER 2011/01/26 APPR: F. SMITH 2011/02/04	QUALITY SYMBOLS	GENERAL TOLERANCES (UNLESS SPECIFIED)	DIMENSION STYLE	SCALE	DESIGN UNITS	THIRD ANGLE PROJECTION
	▽=0	mm INCH	MM/IN	NTS	METRIC	
	▽=0	4 PLACES ± --- ± ---	DRAWN BY DATE			
	▽=0	3 PLACES ± --- ± .010	AOD 1999/02/20			
		2 PLACES ± 0.25 ± .020	CHECKED BY DATE			
		1 PLACE ± 0.51 ± ---	DMORIARTY 2004/10/18			
		ANGULAR ± ---°	APPROVED BY DATE			
			JDENNEHY 2004/10/19			
		DRAFT WHERE APPLICABLE MUST REMAIN WITHIN DIMENSIONS	MATERIAL NO.	DOCUMENT NO.		
			SEE CHART	SD-4809C-****		
			SIZE B			
			THIS DRAWING CONTAINS INFORMATION THAT IS PROPRIETARY TO MOLEX INCORPORATED AND SHOULD NOT BE USED WITHOUT WRITTEN PERMISSION			

9 8 7 6 5 4 3 2 1