

4

3

2

1

THIS DRAWING IS UNPUBLISHED. RELEASED FOR PUBLICATION
 © COPYRIGHT - By - ALL RIGHTS RESERVED.

LOC	DIST	REVISIONS			
P	LTR	DESCRIPTION	DATE	DWN	APVD
D1		REVISED PER ECO-11-004917	11MAR11	RK	HMR

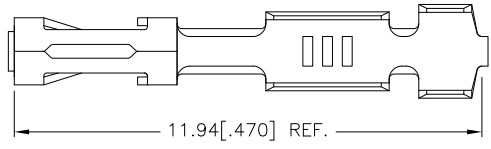

- 1 GOLD FLASH OVER NICKEL, 0.00038[.000015] GOLD IN CONTACT AREAS.
- 2 0.00076[.000030] GOLD OVER 0.00127[.000050] NICKEL.
- 3 GOLD FLASH OVER NICKEL, 0.00076[.000030] GOLD IN CONTACT AREA.
- 4 PREPLATED:(HALT)0.00198[.000078]-0.00401[.000158] BRIGHT TIN
- 5 GOLD FLASH OVER ENTIRE RECPT BOX (AREA L), 0.00076[.000030] GOLD ON CONTACT AREA, ALL OVER 0.00127[.000050] NICKEL ENTIRE CONTACT.
- 6 GOLD FLASH OVER ENTIRE CONTACT, 0.00127[.000050] GOLD ON CONTACT AREA, ALL OVER 0.00127[.000050] NICKEL.

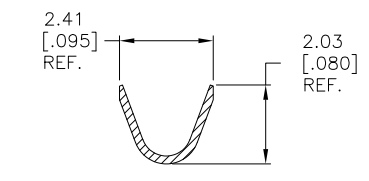
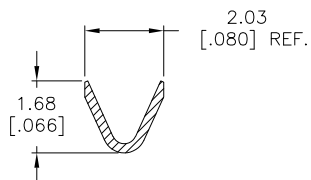
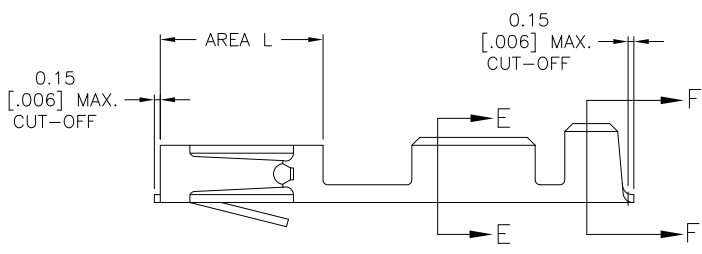

OBSOLETE	6	87046-6
OBSOLETE	5	87046-5
	4	87046-4
	3	87046-3
	2	87046-2
	1	87046-1
FINISH REF		PART NUMBER

SECTION E-E
 WIRE RANGE : #20 - #24

SECTION F-F
 INSULATION RANGE: ϕ 1.75[.069] MAX.

THIS DRAWING IS A CONTROLLED DOCUMENT.		DWN E. BRANDBERG 18-JAN-96	TE Connectivity	
DIMENSIONS: mm [INCHES]		CHK S. SHUEY 18-JAN-96	CONTACT, MOD IV-1/2, CRIMP SNAP-IN, LOOSE PIECE	
TOLERANCES UNLESS OTHERWISE SPECIFIED:		APVD D. TROUT 18-JAN-96	NAME	
0 PLC	± -	PRODUCT SPEC	108-25021	
1 PLC	± -	APPLICATION SPEC	114-25003	
2 PLC	± -	WEIGHT	-	
3 PLC	± -	SIZE	A3	CAGE CODE 00779
4 PLC	± -	DRAWING NO	C=87046	
ANGLES	± -	RESTRICTED TO	-	
MATERIAL BeCu	FINISH SEE TABLE	CUSTOMER DRAWING	SCALE 10:1	SHEET 1 OF 1
			REV D1	