

4

3

2

1

THIS DRAWING IS UNPUBLISHED. RELEASED FOR PUBLICATION
 © COPYRIGHT 19 BY AMP INCORPORATED. ALL RIGHTS RESERVED.

LOC	QTY	REV	DESCRIPTION	DATE	BY	APPD
FT	60	F	LWR			
		A	REV & REDRAW ON CAD PER EC 0320-70-97	11 MAR 97	-	-

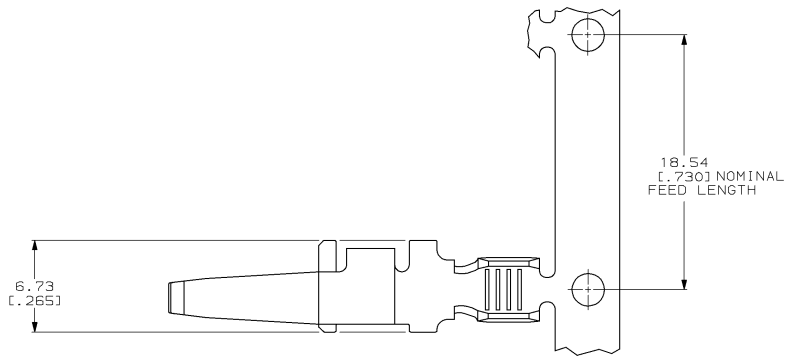

- 1 ALL DIMENSIONS ARE MAXIMUM UNLESS OTHERWISE SPECIFIED.
- 2 COPPER ALLOY.
- 3 2.54µm [0.00100] MIN TIN.
- 4. WIRE BARREL WILL ACCEPT ONE 10 OR 12 AWG STRANDED WIRE OR COMBINATIONS OF 12,18,16 AND 14 AWG WIRE.
- 5. THIS TERMINAL IS USED WITH HOUSING 556137 AND MOUNTING ADAPTER 557313-1.
- 6. APPLICATOR REEL: 567256-3 FOR "T" TERMINATOR, 567256-4 FOR AMP-0-ELECTRIC™ MODEL "K" MACHINE 565435-5.
- 7. HAND TOOL-LOOSE PIECE.

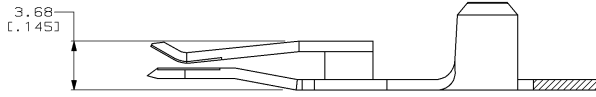

200 TERMINALS PER BOX	LOOSE PIECE	556136-2
2000 TERMINALS ON 24" DIA REEL	ON STRIP	556136-1
PACKAGING	DESCRIPTION	PART NUMBER

THIS DRAWING IS A CONTROLLED DOCUMENT.		DWG: N. BINNER 11 MAR 97 CHK: S. STONE 14 MAR 97 APPD: M. MALONIS 17 MAR 97	AMP AMP Incorporated Harrisburg, PA 17105-3608
DIMENSIONS: mm (INCHES)	DIMENSIONS SPECIFIED: 0 PLC -- 1 PLC -- 2 PLC -- 3 PLC -- 4 PLC -- ANGLES --	NAME: M. MALONIS PRODUCT SPEC: 108-1373 APPLICATION SPEC: 114-6051 WEIGHT: -	TERMINAL, 12-10 AWG, FOLDED CRIMP, WTN, AMPINERGY™ SIZE: A2 CASE CODE: 00779 DRAWING NO: 556136
MATERIAL: 1	FINISH: 1	CUSTOMER DRAWING	SCALE: 5:1 SHEET: 1 OF 1 REV: A

556136
 B