

4

3

2

1

THIS DRAWING IS UNPUBLISHED. RELEASED FOR PUBLICATION
 BY AMP INCORPORATED. ALL RIGHTS RESERVED.

LOC	QTY	REVISIONS			
FT	60	REV	DESCRIPTION	DATE	BY
		C	REV, EC 0210-0674-95	10-25-95	LM/ JJA
		D	REV PER EC 0320-68-97	08 MAR 97	MB MM
		E	REV PER EC 061C-95-98	14 JUL 98	CO MC

- △ ALL DIMENSIONS SHOWN ARE MAXIMUM UNLESS OTHERWISE SPECIFIED.
- △ MATERIAL: 2.54μm [0.00100] MINIMUM TIN PLATED COPPER ALLOY 0.74-0.79 [0.030±.001] THICK.
- 3. WIRE BARREL ACCEPTS ONE 14, 16 OR 18 AWG STRANDED COPPER WIRE.
- △ CONTACTS ON REEL SHALL BE CRIMPED USING APPLICATOR TOOL PN 567403.
- △ LOOSE PIECE CONTACTS SHALL BE CRIMPED USING TOOLS AND DIE SETS LISTED BELOW.
 HAND TOOL: AMP PART NO. 69710
 PNEUMATIC TOOL: AMP PART NO. 69365
 DIE SET 14 AWG: AMP PART NO. 58492-1
 DIE SET 16-18 AWG: AMP PART NO. 58493-1

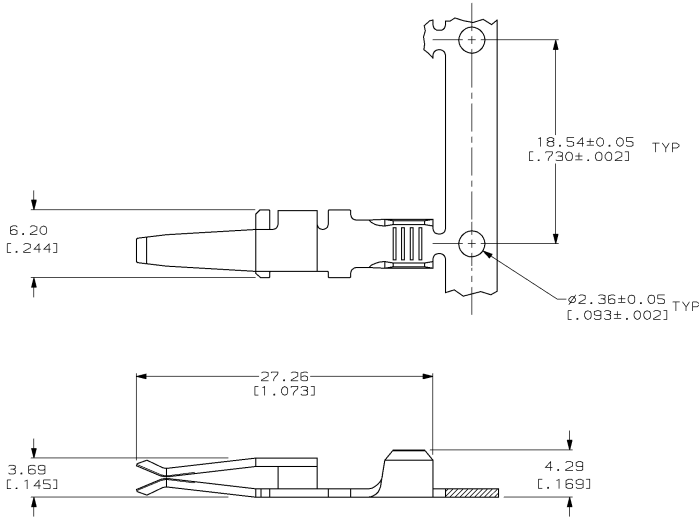

REEL △	556883-2
LOOSE PIECE △	556883-1
DESCRIPTION	PART NO
AMP	
AMP Incorporated Harrisburg, PA 17105-3608	
DIN D. STRAUSSER 8-23-91	5-29-91
CHK D. FOX 8-23-91	
APP M. MILLER 8-28-91	NAME
PRODUCT SPEC 108-1349	CONTACT, DUAL BEAM, 14-18 AWG, WTB, AMPINERGY™
APPLICATION SPEC 114-6044	SIZE CASE CODE DRAWING NO
WEIGHT	A2 00779 C-556883
CUSTOMER DRAWING	SCALE 4:1 SHEET 1 OF 1 REV F

AMP 1471-B REV 02KAY84
 14-JUL-98 11:42:00 amp05568 /home/ssp/v305a/61614/sep14023/amp05568/a.dmsd

556883
 B

A