

DRAWING MADE IN THIRD ANGLE PROJECTION
 THIS DRAWING IS UNPUBLISHED. RELEASED FOR PUBLICATION
 © COPYRIGHT 19 BY AMP INCORPORATED, HARRISBURG, PA. ALL INTERNATIONAL RIGHTS RESERVED. AMP PRODUCTS MAY BE COVERED BY U.S. AND FOREIGN PATENTS AND/OR PATENTS PENDING.

LOC	DIST	ZONE	LTR	REVISIONS	DATE	APPD
CM	53			A	REV PER EC 0730-3607-91	1-6-94 RV RS

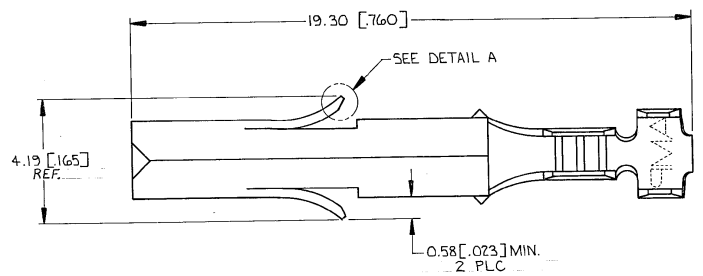

1. WIRE RANGE: 0.05 - 0.15 mm²
 [30-26 AWG]
 INSULATION RANGE: 0.81 - 1.45 DIA.
 [032-.057]
2. DIMENSIONS IN BRACKETS ARE IN INCHES.

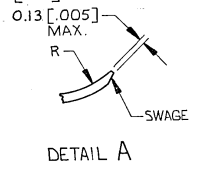
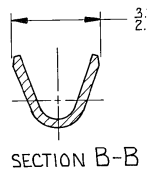
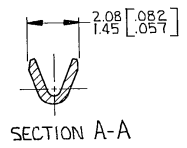
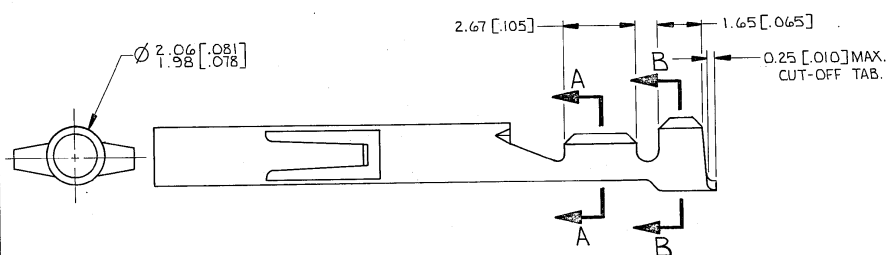

METRIC

770673 -1
PART NO

UNLESS OTHERWISE SPECIFIED DIMENSIONS ARE IN mm TOLERANCES ON 2 PL DEC ± 3 PL DEC ±0.13 [005] ANGLES ±	DR P. Cellio 2-26-90	AMP AMP INCORPORATED Harrisburg, Pa. 17105	
	CHK R. Sweeney 3-2-90 APPD R. Small 3-2-90		
MATERIAL 0.30 [012] BRASS	PRODUCT SPEC	NAME SOCKET, UNIVERSAL MATE-N-LOK™ LOOSE PIECE	
FINISH PRE-TIN	APPLICATION SPEC	SIZE C	FSCM NO 00779
WEIGHT		SCALE 10:1	DRAWING NO 770673 SHEET 1 OF 1

CUSTOMER DRAWING