

DRAWING MADE IN THIRD ANGLE PROJECTION

© COPYRIGHT 1975 BY AMP INCORPORATED, HARRISBURG, PA. ALL INTERNATIONAL RIGHTS RESERVED. AMP INCORPORATED PRODUCTS COVERED BY U. S. AND FOREIGN PATENTS AND/OR PATENTS PENDING.

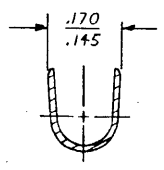
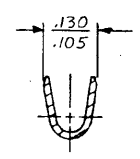
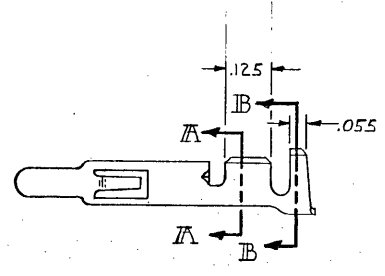
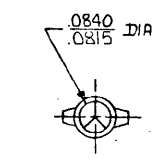
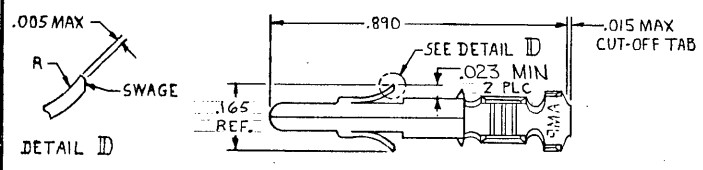

REVISIONS						
P	F	ZONE	LTR	DESCRIPTION	DATE	APPROVED
✓			B	REVISED & UPDATED M-6457	6-5-81	MSF/SH
✓			C	REVISED AG 57	10/21/82	MSF/SH
✓			C1	RESTORED	4/9/83	KO/RS
✓			D	REVISED PER CM-3286	2-7-91	PC/RS
✓			E	REV PER EC 0730-3607-91	1-7-94	RV/RS
✓			F	REV PER EC 0730-0156-94	8-24-94	RV/RS

PRE-TIN	.012 BRASS	350669-1
FINISH	MATERIAL	PART NO

UNLESS OTHERWISE SPECIFIED DIMENSIONS ARE IN INCHES. TOLERANCES ON: DECIMALS ± .015 ANGLES ±	CONTRACT NO	AMP AMP INCORPORATED Harrisburg, Pa.	
	DR M.FENER 5-6-81	NAME PIN, (LOOSE PIECE)	
WIRE RANGE 20-14 AWG	CHK S. Weide 6/9/81	UNIVERSAL MATE-N-LOK	
INSULATION RANGE .130 DIA MAX	APPD R. Belcher 6-10-81	SIZE B	CODE IDENT NO 00779
	DSGN APPD	DRAWING NO 350669	
	OTHER APPD	SCALE 4-1	SHEET 4

AMP 1470-15 REV 8-79

CUSTOMER DRAWING