

15 DRAWING MADE IN THIRD ANGLE PROJECTION

© COPYRIGHT 1973 BY AMP INCORPORATED, HARRISBURG, PA. ALL INTERNATIONAL RIGHTS RESERVED, AMP INCORPORATED PRODUCTS COVERED BY U. S. AND FOREIGN PATENTS AND/OR PATENTS PENDING.

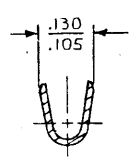

SECTION A-A

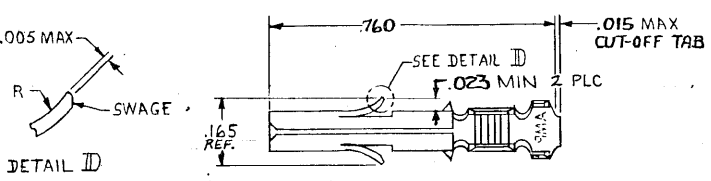
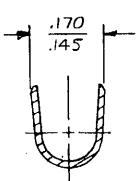
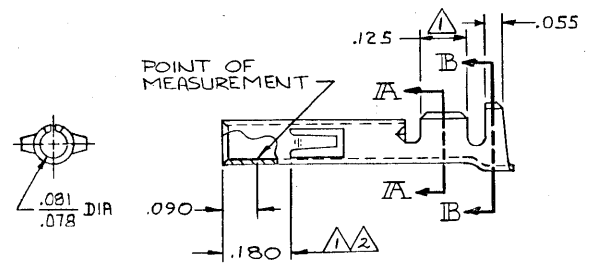

SECTION B-B

- ① .000030 THICK GOLD OVER NICKEL ON INSIDE OF RECEPTACLE AND WIRE BARREL; REMAINDER OF CONTACT IS NICKEL PLATED.
- ② .000030 THICK GOLD OVER NICKEL ON INSIDE OF RECEPTACLE; REMAINDER OF CONTACT IS NICKEL PLATED.

		REVISIONS				
R	F	ZONE	LYR	DESCRIPTION	DATE	APPROVED
✓	✓		M	REDRAWN & UPDATED M-6457	6-5-81	MSF/S.H.
✓	✓		N	ADDED .090, .180 DIMS, POINT OF MEAS., M-7357	5/14/83	TW/DH
✓	✓		P	REVISED AG 57	7/2/83	RS
✓	✓		P	RESTORED	7/3/84	RS
			R	REV PER EC 0730-3607-91	1-5-93	RV/RS

GOLD	②	.012 BRASS	350550-7
		.012 PH. BRZ	350550-6
PRE-TIN		.012 PH. BRZ	350550-3
GOLD	①	.012 BRASS	350550-2
PRE-TIN			350550-1
FINISH		MATERIAL	PART NO

UNLESS OTHERWISE SPECIFIED DIMENSIONS ARE IN INCHES. TOLERANCES ON: DECIMALS $\pm .015$ ANGLES $\pm 1^\circ$	CONTRACT NO	<b>AMP</b>   AMP INCORPORATED Harrisburg, Pa.	
	DR	M. Fehér 4-21-81	
	CHK	D.S. Heide 6/9/81	
	APPD	D. Polchub 6-10-81	
WIRE RANGE	20-14 - AWG	NAME	SOCKET, (LOOSE PIECE) UNIVERSAL MATE-N-LOK
INSULATION RANGE	.130 DIA MAX	SIZE	B
		CODE IDENT NO	00779
		DRAWING NO	350550
		SCALE	4-1
		SHEET	-1-

CUSTOMER DRAWING