

DRAWING MADE IN THIRD ANGLE PROJECTION  
 THIS DRAWING IS UNPUBLISHED. RELEASED FOR PUBLICATION .19  
 © COPYRIGHT 19 BY AMP INCORPORATED. ALL INTERNATIONAL RIGHTS RESERVED.

LOC		DIST		ZONE		LTR		REVISIONS		DATE	APPD
CM	53	P	F			L		REV PER EC 0730-0245-95		1-25-95	JH

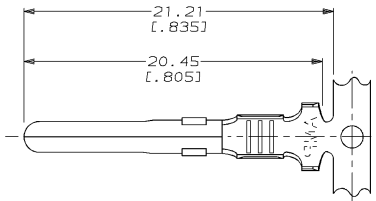

1. WIRE RANGE: 2 WIRES OF 0.8 - 0.9 mm<sup>2</sup> [18 AWG] OR 1 WIRE OF 0.8 - 0.9 mm<sup>2</sup> [18 AWG] AND 1 WIRE OF 1.25 - 1.4 mm<sup>2</sup> [16 AWG].
2. INSULATION RANGE: 2 WIRES OF 2.92 [.115] MAX DIA EACH, STACKED.
3. DIMENSIONS IN BRACKETS ARE IN INCHES.

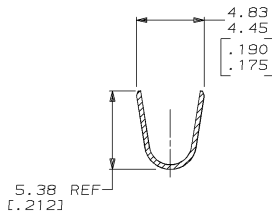
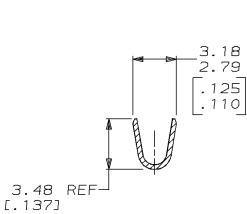
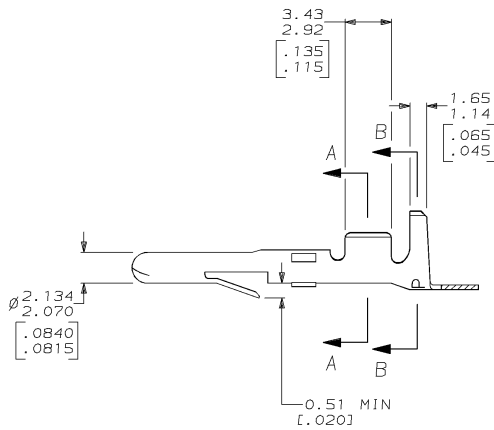

**METRIC**

THIS DRAWING IS A CONTROLLED DOCUMENT FOR AMP INCORPORATED. IT IS SUBJECT TO CHANGE AND THE CONTROLLING ENGINEERING ORGANIZATION SHOULD BE CONTACTED FOR THE LATEST REVISION.

PRE-TIN	0.30 [.012] PH BRZ	350558-4
PRE-TIN	0.30 [.012] BRASS	350558-1
FINISH	MATERIAL	PART NO

DO NOT SCALE PRINT. UNLESS SPECIFIED DIMENSIONS IN mm [INCHES] TOLERANCES ON : 2 PLC DEC ± - 3 PLC DEC ± 0.13 (.005) ANGLES ± -	DR 1-20-93 T. BECK CHK 1-20-93 R. SWING APPD 1-25-93 C. MARTIN	<b>AMP</b> AMP Incorporated Harrisburg, PA 17105-3608	
MATERIAL SEE TABLE	APPD 1-25-93 C. MARTIN PRODUCT SPEC -	NAME PIN, MATE-N-LOK™	
FINISH SEE TABLE	APPLICATION SPEC -	SIZE C 00779	DRAWING NO C=350558
WEIGHT -	SCALE 5:1	SHEET 1 OF 1	

AMP 1471-6 REV 3-92  
 25-JAN-96 14:06:30 amp18726 /home/amp18726/u.cm-73-245-95

CUSTOMER DRAWING

350558

A