

4

3

2

1

THIS DRAWING IS UNPUBLISHED. RELEASED FOR PUBLICATION
 (C) COPYRIGHT IS BY AMP INCORPORATED. ALL RIGHTS RESERVED.

LOC	DIST	REVISIONS			
		DESCRIPTION	DATE	BY	APP'D
CM	53				
		E REV 8 REDWN PER EC 061B-0217-9B	290CT98	TB	RS

1. WIRE RANGE: 0.5 - 2 mm² (20 - 14 AWG)
 2. INSULATION RANGE: 2.54 - 4.57
- ⚠️ FRICTION FIT ON A 3.56 DIAMETER PIN.

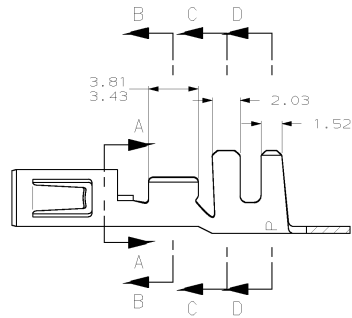
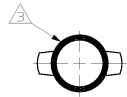
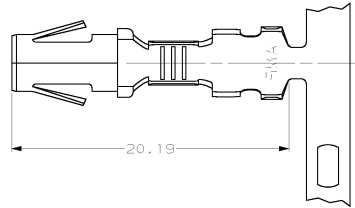

SECTION A-A

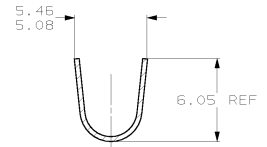

SECTION C-C

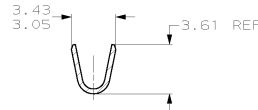

SECTION B-B

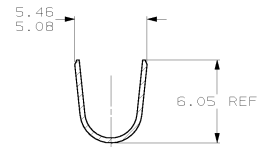

SECTION D-D

MM	IN	MM	IN	MM	IN	MM	IN
1.52	.060	3.43	.135	4.57	.180	20.19	.795
0.36	.014	3.05	.120	3.81	.150	6.05	.238
0.35	.014	2.54	.100	3.61	.142	5.46	.215
0.13	.005	2.03	.080	3.56	.140	5.08	.200

CONVERSION TABLE

METRIC

PRE TIN	0.36 PH BRZ	61626-2
PRE TIN	0.35 BRASS	61626-1
FINISH	MATERIAL	PART NUMBER

THIS DRAWING IS A CONTROLLED DOCUMENT.

DATE	290CT1998	BY	TJ BECK
CHKD	290CT1998	APP'D	SWING
REV	100X1998	DATE	100X1998
DESIGNED BY	J. MARTIN	PROJECT SPEC	
APPROVED BY		APPLICATION SPEC	
MATERIAL	SEE TABLE	FINISH	SEE TABLE
WEIGHT	-	CUSTOMER DRAWING	

AMP AMP Incorporated
Harrisburg, PA 17105-3608

SOCKET, .140 PIN & SOCKET CONNECTOR

SCALE: 5:1 SHEET 1 OF 1 REV E