

1/4 DRAWING MADE IN THIRD ANGLE PROJECTION

© COPYRIGHT 1974 BY AMP INCORPORATED, HARRISBURG, PA. ALL INTERNATIONAL RIGHTS RESERVED. AMP INCORPORATED PRODUCTS COVERED BY U. S. AND FOREIGN PATENTS AND/OR PATENTS PENDING.

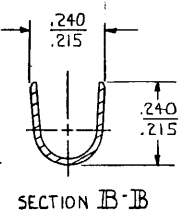
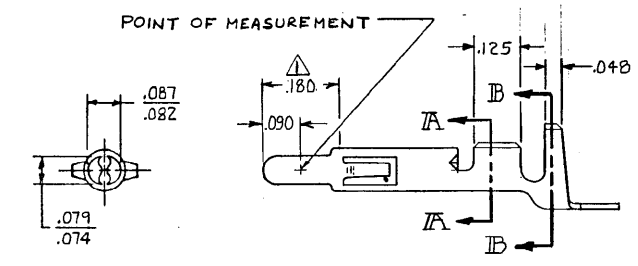
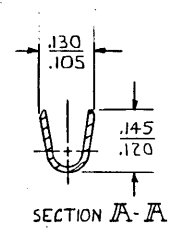
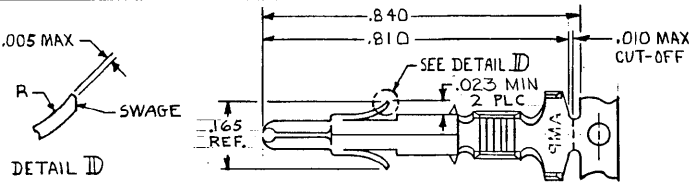

REVISIONS						
P	F	ZONE	LTR	DESCRIPTION	DATE	APPROVED
✓	✓		L	REDRAWN W/O CHANGE	M-6A57	6-5-81 MSF/AH
✓	✓		M	REVISED	M-7350	7/28/83 pas/SH
✓			N	REVISED	AG 57	7/27/83 [Signature]
✓			P	ADDED -8 PER TTI 84-23		7/10/84 MC JW
✓			R	REV PER ECN CM 51		12/14/84 TB/RS
✓			R1	RESTORED		4/11/85 MC 1/6
✓			S	REV PER ECN CM-956		3-17-87 [Signature] TB
✓			T	REVISED PER CM-1728		9-6-88 [Signature] TB
✓			U	REV PER EC 0730-3607-91		1-7-94 RV RS
✓			V	RLSD -11 PER ECO730-0088-96		4-30/96 JH RS

LOOSE PIECE (REF)	MATERIAL	FINISH	PART NO
350700-1	PRE-TIN		1-350700-1
350707-7	.012 BRASS	GOLD	350700-7
	.012 PH BR2	PRE-TIN	350700-3
350707-2	.012 BRASS	GOLD	350700-2
350707-1		PRE-TIN	350700-1

- ⚠ PLATED WITH .000030 GOLD, OVER .000050 NICKEL UNDERPLATE.
- ⚠ GOLD OVER NICKEL ON ENTIRE STAMPING; .000030 GOLD MINIMUM AT POINT OF MEASUREMENT IN CONTACT AREA, GOLD FLASH MINIMUM IN WIRE BARREL.
- ⚠ PACKAGED AND SOLD IN PALLET LOADS ONLY, 44 REELS PER PALLET (110,000 CONTACTS).

UNLESS OTHERWISE SPECIFIED DIMENSIONS ARE IN INCHES. TOLERANCES ON: DECIMALS ±.015 ANGLES ±.015	CONTRACT NO	AMP AMP INCORPORATED Harrisburg, Pa.	
	DR	NAME	
WIRE RANGE	CHK	SPLIT PIN, UNIVERSAL MATE-N-LOK	
20-14 AWG	APPD	SIZE	CODE IDENT NO
INSULATION RANGE	DSGN APPD	B	00779
.200 DIA MAX	OTHER APPD	DRAWING NO	350700
		SCALE	4-1
		SHEET	1 OF 1

CUSTOMER DRAWING