

8	7	6	5	4	3	2	1
DATE APPROVED BY: [Signature]	REVISIONS FOR FACILITIES:						
BY: [Signature]	BY: [Signature]	BY: [Signature]	BY: [Signature]	BY: [Signature]	BY: [Signature]	BY: [Signature]	BY: [Signature]

REV	DATE	DESCRIPTION	BY	CHK	APP
GP	00				
C		ADDED - 3 PER EC 8515-0324-02	LOREMAN	OLD	RFM
H		REVISED PER EC 8515-0459-02	LOREMAN	OLD	RFM
J		REVISED PER EC 8515-0524-03	HUGHES	JB	CF
K		REVISED PER EC 8515-0539-03	HUGHES	JB	CF

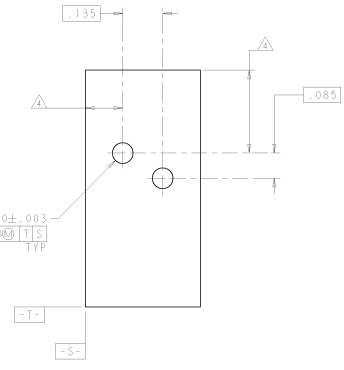
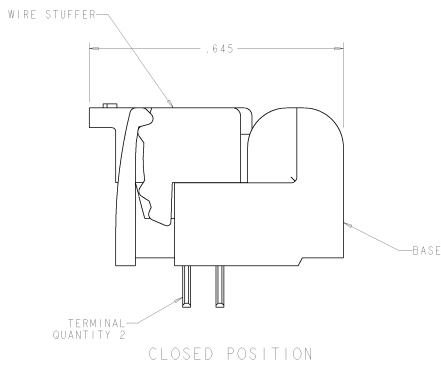
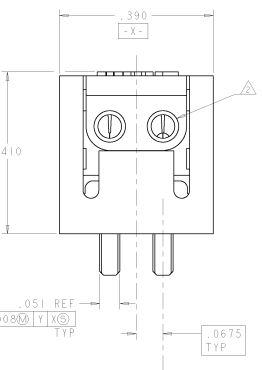
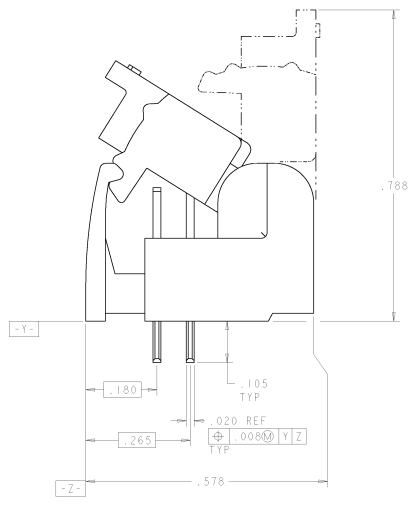
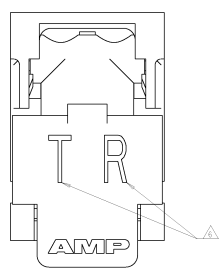

- △ MATERIAL: BASE - HIGH TEMPERATURE MOLDING COMPOUND, BLACK.  
WIRE STUFFER: - HIGH TEMPERATURE MOLDING COMPOUND.  
TERMINAL - COPPER ALLOY, PLATED WITH 3.81μm MINIMUM THICK TIN OVER 1.27μm MINIMUM THICK NICKEL UNDERPLATE.
- △ EACH WIRE ENTRY HOLE ACCEPTS ONE UNSTRIPPED SOLID COPPER 22-26 AWG WIRE WITH WIRE INSULATION DIAMETER RANGE FROM .060 THROUGH .040. OTHER WIRE SIZES AND TYPES SHALL BE SUBMITTED TO AMP ENGINEERS FOR APPLICATION APPROVAL.
- 3. SOLDER TABS PROVIDED FOR PERMANENT BOARD MOUNTING.
- △ LOCATION OF HOLE PATTERN DETERMINED BASED ON CUSTOMER REQUIREMENTS.
- △ T AND R DESIGNATIONS NOT ON TAN STUFFER FOR 1339222-3, OR 1339222-4

SUGGESTED PRINTED CIRCUIT BOARD MOUNTING DIMENSIONS VIEWED FROM SOLDER SIDE

COLOR	CODE	PART NUMBER
-	-	CLEAR 1339222-4
-	-	TAN 1339222-3
RED	GREEN	CLEAR 1339222-2
RED	GREEN	TAN 1339222-1
R	T	WIRE STUFFER PART NUMBER

ALL DIMENSIONS UNLESS OTHERWISE SPECIFIED ARE IN INCHES AND DECIMAL FRACTIONS.		ALL DIMENSIONS UNLESS OTHERWISE SPECIFIED ARE IN MILLIMETERS.	
FINISH: [Symbol] INCHES: [Symbol] MILLIMETERS: [Symbol]	MATERIAL: [Symbol] FINISH: [Symbol]	PART NUMBER: 1339222-4 DESCRIPTION: ASSEMBLY, SINGLE PAIR, SINGLE ENTRY, PIVOT II CONNECTOR	DATE: 000000 BY: [Symbol] CHECKED: [Symbol]