

THIS DRAWING IS UNCLASSIFIED
 UNLESS INDICATED OTHERWISE
 ALL RIGHTS RESERVED

REV	DATE	DESCRIPTION	BY	CHK	APP
0					
D		REVISED PER 0638-1122-04		SS	CS

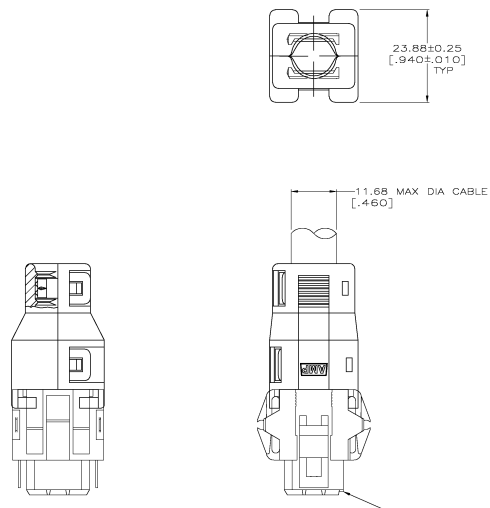

ASSEMBLED VIEW

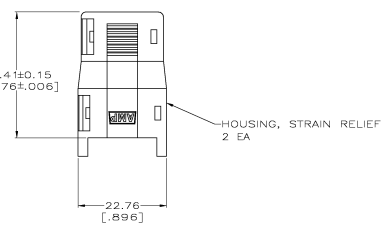
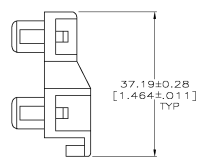
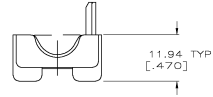
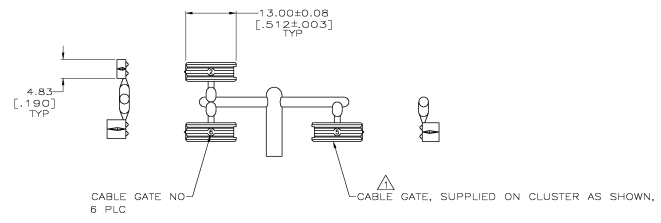

△ A VARIETY OF CABLE GATES ARE PROVIDED TO ACCOMMODATE A VARIETY OF CUSTOMER CABLE SIZES.
 △ PLUG SHOWN FOR REFERENCE ONLY, STRAIN RELIEF CAN BE USED ON EITHER PLUG OR RECEPTACLE.

207601-1
 PART NUMBER

THIS DRAWING IS A CONTROLLED DOCUMENT.		REV. 11/21/02	DATE 11/21/02	BY	CHK	APP
DESIGNER	DESIGNED BY	DATE	BY	CHK	APP	
DRG NO.	REV.	DATE	BY	CHK	APP	
REV. 1	1	11/21/02				
REV. 2	2	06/28/04				
REV. 3	3	06/28/04				
REV. 4	4	06/28/04				
REV. 5	5	06/28/04				
REV. 6	6	06/28/04				
REV. 7	7	06/28/04				
REV. 8	8	06/28/04				
REV. 9	9	06/28/04				
REV. 10	10	06/28/04				
REV. 11	11	06/28/04				
REV. 12	12	06/28/04				
REV. 13	13	06/28/04				
REV. 14	14	06/28/04				
REV. 15	15	06/28/04				
REV. 16	16	06/28/04				
REV. 17	17	06/28/04				
REV. 18	18	06/28/04				
REV. 19	19	06/28/04				
REV. 20	20	06/28/04				
REV. 21	21	06/28/04				
REV. 22	22	06/28/04				
REV. 23	23	06/28/04				
REV. 24	24	06/28/04				
REV. 25	25	06/28/04				
REV. 26	26	06/28/04				
REV. 27	27	06/28/04				
REV. 28	28	06/28/04				
REV. 29	29	06/28/04				
REV. 30	30	06/28/04				
REV. 31	31	06/28/04				
REV. 32	32	06/28/04				
REV. 33	33	06/28/04				
REV. 34	34	06/28/04				
REV. 35	35	06/28/04				
REV. 36	36	06/28/04				
REV. 37	37	06/28/04				
REV. 38	38	06/28/04				
REV. 39	39	06/28/04				
REV. 40	40	06/28/04				
REV. 41	41	06/28/04				
REV. 42	42	06/28/04				
REV. 43	43	06/28/04				
REV. 44	44	06/28/04				
REV. 45	45	06/28/04				
REV. 46	46	06/28/04				
REV. 47	47	06/28/04				
REV. 48	48	06/28/04				
REV. 49	49	06/28/04				
REV. 50	50	06/28/04				
REV. 51	51	06/28/04				
REV. 52	52	06/28/04				
REV. 53	53	06/28/04				
REV. 54	54	06/28/04				
REV. 55	55	06/28/04				
REV. 56	56	06/28/04				
REV. 57	57	06/28/04				
REV. 58	58	06/28/04				
REV. 59	59	06/28/04				
REV. 60	60	06/28/04				
REV. 61	61	06/28/04				
REV. 62	62	06/28/04				
REV. 63	63	06/28/04				
REV. 64	64	06/28/04				
REV. 65	65	06/28/04				
REV. 66	66	06/28/04				
REV. 67	67	06/28/04				
REV. 68	68	06/28/04				
REV. 69	69	06/28/04				
REV. 70	70	06/28/04				
REV. 71	71	06/28/04				
REV. 72	72	06/28/04				
REV. 73	73	06/28/04				
REV. 74	74	06/28/04				
REV. 75	75	06/28/04				
REV. 76	76	06/28/04				
REV. 77	77	06/28/04				
REV. 78	78	06/28/04				
REV. 79	79	06/28/04				
REV. 80	80	06/28/04				
REV. 81	81	06/28/04				
REV. 82	82	06/28/04				
REV. 83	83	06/28/04				
REV. 84	84	06/28/04				
REV. 85	85	06/28/04				
REV. 86	86	06/28/04				
REV. 87	87	06/28/04				
REV. 88	88	06/28/04				
REV. 89	89	06/28/04				
REV. 90	90	06/28/04				
REV. 91	91	06/28/04				
REV. 92	92	06/28/04				
REV. 93	93	06/28/04				
REV. 94	94	06/28/04				
REV. 95	95	06/28/04				
REV. 96	96	06/28/04				
REV. 97	97	06/28/04				
REV. 98	98	06/28/04				
REV. 99	99	06/28/04				
REV. 100	100	06/28/04				

MP 482 REV 01/06/02