

THIS DRAWING IS UNPUBLISHED. RELEASED FOR PUBLICATION
 © COPYRIGHT 19 BY AMP INCORPORATED. ALL RIGHTS RESERVED.

LOC		DIST		REVISIONS			
W	LTR	DESCRIPTION	DATE	DWG	APPD	BY	SY
AG	0	REVISED ECR-10-006444	39MAR10	AZ	SY		

1. USED IN AMP-DUAC/PL™ RECEPTACLE HOUSINGS. ONE REQUIRED PER HOUSING.
 2. INSTALL LATCH ASSEMBLY AFTER CUSTOMER SUPPLIED BACKSHELL. (USE OF BACKSHELL IS REQUIRED).
 3. LATCH ASSEMBLY AVAILABLE WITH STANDARD LEVER ARM, 794150-1.
- ⚠ MATERIAL: LATCH ARM - PBT, GLASS REINFORCED
 COLOR - NATURAL
 SPRING - STAINLESS STEEL.

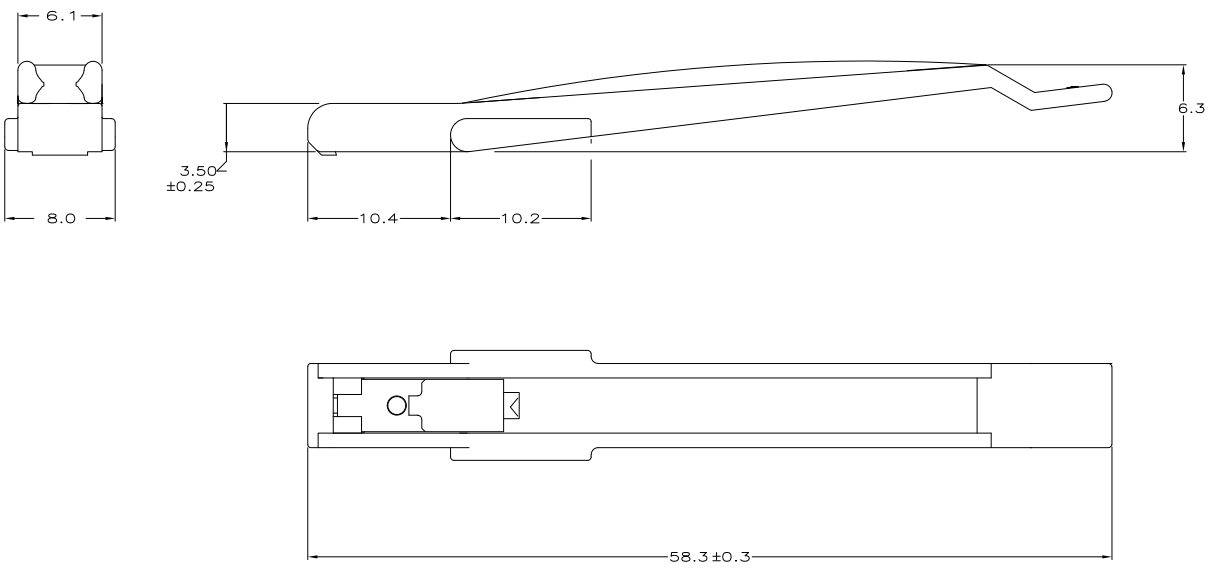

794149-1
 PART NUMBER

THIS DRAWING IS A CONTROLLED DOCUMENT.		DWG. S. WHITAKER 8-15-97	AMP Incorporated Harrisburg, PA 17105-3608
DIMENSIONS: mm		CHK. R. SWING 8-15-97	
TOLERANCES UNLESS OTHERWISE SPECIFIED:		APPD. E. BEILES 8-15-97	LATCH ASSEMBLY, EXTENDED, AMP-DUAC/PL™ POWER CONNECTOR
0. PL.C ±.2	PRODUCT SPEC. 108-1646	NAME	
1. PL.C ±0.2	APPLICATION SPEC. 114-6067	SIZE	
2. PL.C ±0.13	WEIGHT	CAGE CODE	
3. PL.C ±.2	FINISH	DRAWING NO. A200779	DRAWING NO. 794149
4. PL.C ±.2	MATERIAL	CUSTOMER DRAWING	RESTRICTED TO
5. PL.C ±.2	FINISH	SCALE 5:1	SHEET 1 OF 1

