

DRAWING MADE IN KOREAN PROJECTION

DIMENSIONS IN MM

CUSTOMER DRAWING

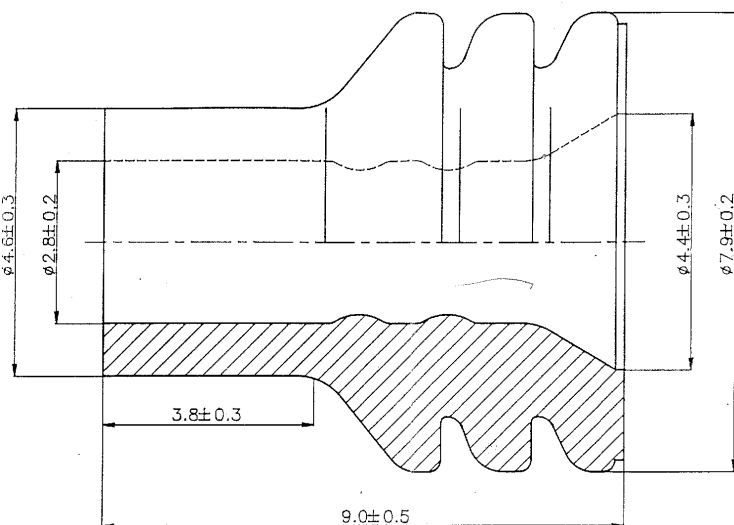
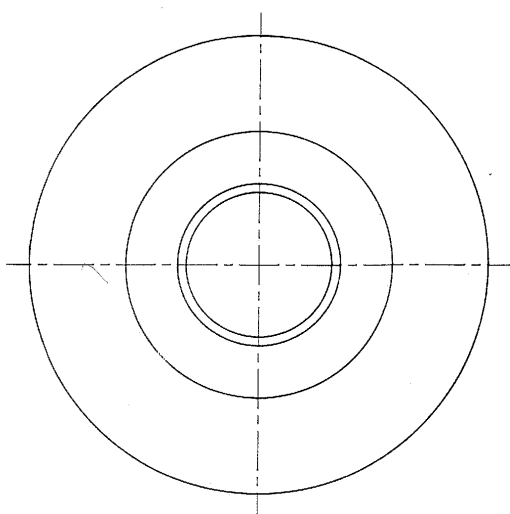

**\* NOTE \***

- 1. APPLICABLE CONTACT P/N :  
175088-1 , 175091-1
- 2. APPLICABLE HSG P/N :  
6-176143-6 , 6-176146-6

BLACK	85011-1
COLOR	PART NO.

GENERAL TOLERANCES	
10 MAX	±0.2
10 OVER 30 MAX	±0.25
30 OVER 100 MAX	±0.3
ANGLES	±3°

© 19 AMP MFG KOREA ALL RIGHT RESERVED AMP PRODUCTS COVERED BY PATENTS AND OR PATENTS PENDING		AMP * AMP MFG KOREA	
WIRE RANGE (AWG WIRE) 2.0 - 3.0mm <sup>2</sup>	INSULATION DIA 3.1 - 3.3mm	NAME RUBBER PLUG FOR 187 SEALED CONNECTOR	
MATERIAL NBR	FINISH/COLOR SEE TABLE	TOLERANCES 0.03 < 10 ±0.2 10 ≤ 30 ±0.25 30 ≤ 100 ±0.3 ANGLE 3°	SIZE LOC NO A3 DS 85011
OR JK SONG REL CS LEE	APP CS LEE REL CH HAN	SCALE 15/1	REV 0 SHEET 1/1

DO NOT SCALE PRINT

AMP-ME-0021REV 7/92