

© Copyright 1978 by AMP Incorporated, Harrisburg, Pa. All International Rights Reserved. AMP Incorporated products covered by U. S. and Foreign Patents and/or Patents Pending.

- 1. SHEET METAL SCREWS NOT SUPPLIED. INSERT IS ATTACHED TO STRAIN RELIEF AS AN ADDITIONAL ADJUSTMENT FOR SMALL WIRE BUNDLES, IT SHOULD BE CUT OFF AND POSITIONED AS SHOWN BY DOTTED LINES.
- 2. TWO REQUIRED PER CONNECTOR.
- 3. DETACHABLE INSERT MAY SEPARATE FROM STRAIN RELIEF BODY DURING SHIPPING.

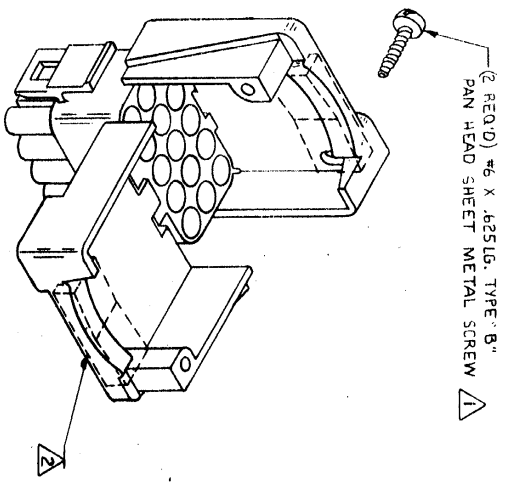
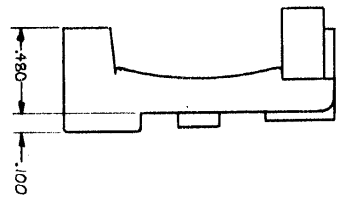
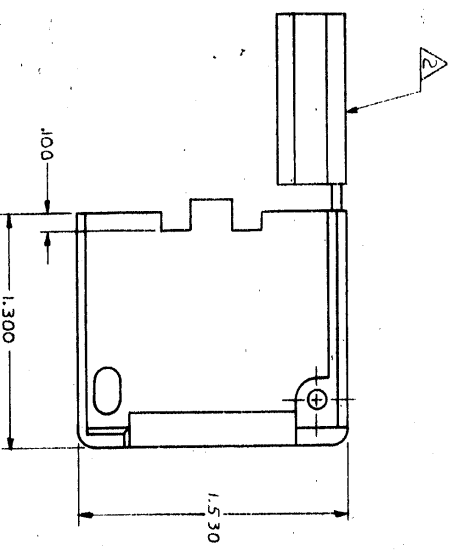
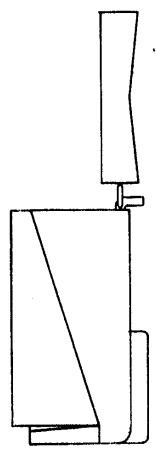

REVISIONS		DATE	APPROVED
1	REVISED AND REDRAWN PER M-5186	3-27-79	MS/AM
2	RESTORATION	4-18-79	MS/AM
3	REV PER ECN CM 705	5/16/79	MS/AM

WIRE BUNDLE	
WITHOUT INSERT	.950 MAX
WITH INSERT	.200 MIN

UNLESS OTHERWISE SPECIFIED DIMENSIONS ARE IN INCHES. TOLERANCES ON: ANGLES ±.015	
MATERIAL	SEE TABLE
FINISH	SEE TABLE

CONTRACT NO.	
DR	3-12-79
CHK	MS/AM
APPRO	3/27/79
APPRO	4/18/79
OSGN APPRO	5/16/79
OTHER APPRO	

NATURAL	NYLON 94V-2	1-540724-0/3
COLOR	MATERIAL	PART NO

NAME	
STRAIN RELIEF FOR 15 CIRCUIT UNIVERSAL MATE-N-LOK™ CONNECTOR	

SIZE CODE IDENT NO/DRAWING NO	00779	640724
SCALE	2-1	SHEET 1 OF 1