

IEC Appliance Inlet C14 with Fuseholder 1-pole

Types 6200, 6205

Types 6200, 6205



1-pole  
Type 6202: for protection class II

1-pole



**Description**

- Panel Mount:  
Screw-on version from front or rear side, snap-in version from front side
- 2 Functions:  
Appliance Inlet Protection class I, Fuseholder for fuse-links 5 x 20 mm 1-pole
- Solder terminals or quick connect terminals

**Approvals**

- VDE Certificate Number: 40011091
- UL File Number: E93617
- CSA File Number: 38456

**Characteristics**

- Unwired
- Plug removal necessary for fuse-link replacement  
The fuseholder is accessible from the equipment front  
With spare fuse compartment
- Qualified for use in equipment according IEC/EN 60950

**Other versions on request**

- Types for rivet mounting available upon request

**References**

**Weblinks**

[General Product Information](#), [Approvals](#), [RoHS](#), [CHINA-RoHS](#), [Mating Connectors](#), [e-Store](#), [SCHURTER-Stock-Check](#), [Distributor-Stock-Check](#), [Accessories](#)

**Technical Data**

Ratings IEC	10A / 250VAC; 50Hz
Ratings UL/CSA	10A / 250VAC; 60Hz
Dielectric Strength	> 2 kVAC between L-N > 2 kVAC between L/N-PE (1 min/50Hz)
Allowable Operation Temp.	-25°C to 70°C
Degree of Protection	from front side IP 40 acc. to IEC 60529
Protection Class	Suitable for appliances with protection class 1 acc. to IEC 61140
Terminal	Solder terminals or quick connect terminals, tin-plated
Panel Thickness s	Screw: max 6 mm Mounting screw torque max 0.5 Nm Snap-in: 1/1.5/2.0/2.5/3 mm
Material: Housing	Thermoplastic, black, UL 94V-0

Appliance Inlet	C14 acc. to IEC/EN 60320-1, UL 498, CSA C22.2 no. 42 (for cold conditions) pin-temperature 70 °C, 10A, Protection Class 1
Fuseholder	1-pole, Shocksafe category PC2 acc. to IEC 60127-6, for fuse-links 5 x 20 mm
Rated Power Acceptance @ Ta 23 °C	5 x 20: 2W (1 pole)
Power Acceptance @ Ta > 23°C	Admissible power acceptance at higher ambient temperature see derating curves

**Dimensions**

Screw-on mounting types 6200/05

44 mm  
Snap-in mounting types 6200/05

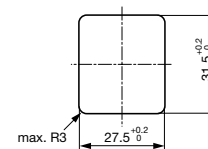
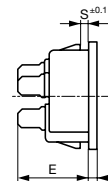
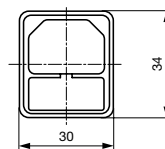
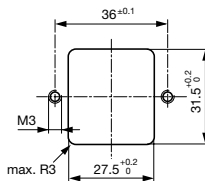
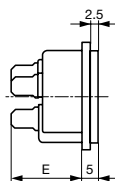
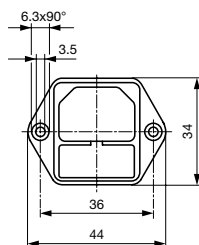

E: Solder terminals 20.5 mm  
E: Quick connect terminals 23.5 mm

E: solder terminals 22.5 mm  
E: quick-connect terminals 25.5 mm  
S: 1.0/1.5/2.0/2.5/3.0 mm

## Diagrams

6200/05

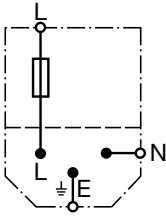

## Derating Curves

1-pole

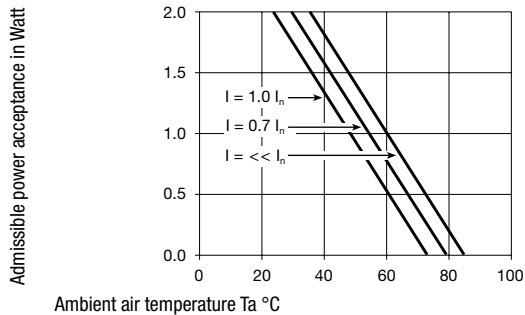

2-pole

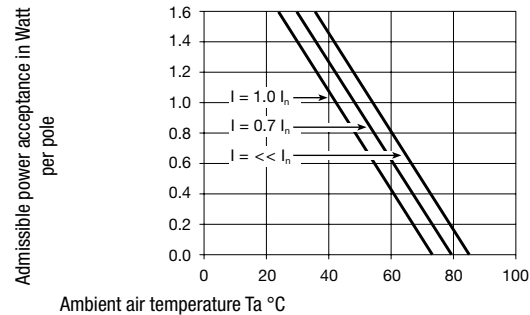

## Variants

Socket and fuse-carrier included



Protection Class	Panel mounting	Panel Thickness s [mm]	Fuseholder	Terminal	Internally wired	Order Number
1	Screw	-	1-pole	Quick connect terminals 4.8 x 0.8 mm		6205.2200
1	Screw	-	1-pole	Quick connect terminals 6.3 x 0.8 mm		6205.2300
1	Screw	-	1-pole	Solder terminals		6205.2100
1	Snap-in	1.5	1-pole	Quick connect terminals 4.8 x 0.8 mm		6205.4215
1	Snap-in	2	1-pole	Quick connect terminals 4.8 x 0.8 mm		6205.4220
1	Snap-in	3	1-pole	Quick connect terminals 4.8 x 0.8 mm		6205.4230
1	Snap-in	1	1-pole	Quick connect terminals 6.3 x 0.8 mm		6205.4310
1	Snap-in	2	1-pole	Quick connect terminals 6.3 x 0.8 mm		6205.4320
1	Snap-in	3	1-pole	Quick connect terminals 6.3 x 0.8 mm		6205.4330
1	Snap-in	1	1-pole	Solder terminals		6205.4110
1	Snap-in	1	1-pole	Solder terminals		6205.4210
1	Snap-in	1.5	1-pole	Solder terminals		6205.4115
1	Snap-in	1.5	1-pole	Solder terminals		6205.4315
1	Snap-in	2	1-pole	Solder terminals		6205.4120
1	Snap-in	2.5	1-pole	Solder terminals		6205.4125
1	Snap-in	2.5	1-pole	Solder terminals		6205.4225
1	Snap-in	2.5	1-pole	Solder terminals		6205.4325
1	Snap-in	3	1-pole	Solder terminals		6205.4130

Packaging unit 50 Pcs

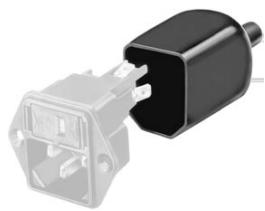
Accessories

Description	
	Assorted Covers
	Rear Cover
	0859.0047
	4311.9403

Mating Outlets/Connectors

Category / Description	
	<a href="#">Appliance Outlet Overview complete</a>
	IEC Appliance Outlet F, Screw-on Mounting, Front Side, Solder Terminal
	IEC Appliance Outlet F, Snap-in Mounting, Front Side, Solder or Quick-connect Terminal
	IEC Appliance Outlet F or H, Screw-on Mounting, Front Side, Solder, PCB or Quick-connect Terminal
	IEC Appliance Outlet F or H, Screw-on Mounting, Front Side, Solder or Quick-connect Terminal
	4787
	4788
	5091
	5092
	<a href="#">Appliance Outlet further types to 6205</a>
	<a href="#">Connector Overview complete</a>
	IEC Connector C15, Rewireable, Straight
	IEC Connector C15A, Rewireable, Straight
	IEC Connector C15A, Rewireable, Straight
	IEC Connector C15A, Rewireable, Angled
	IEC Connector C13, Rewireable, Angled
	0101
	0102
	0102-G
	0112
	4012
	<a href="#">Connector further types to 6205</a>
	...
	<a href="#">Power Cord Overview complete</a>
	Power Cord with IEC Connector C13, Angled
	Power Cord with IEC Connector C13, Angled
	Power Cord with IEC Connector C13, Angled
	Power Cord with IEC Connector C13, Angled
	Power Cord with IEC Connector C13
	Power Cord with IEC Connector C13
	0311
	3011
	3012
	3013
	3020
	<a href="#">Power Cord further types to 6205</a>
	...