

IEC Appliance Inlet C14 with Fuseholder 1- or 2-pole, mates to Felcom

Plug removal necessary for fuse replacement



Appliance inlet with fuseholder



Description

- Component: Snap-in version from front side
- 2 Functions: Appliance Inlet Protection class I, Fuseholder for fuse-links 5 x 20 mm 1- or 2-pole
- For PCB mounting, fits to Felcom

Approvals

- CSA File Number: 38456

Characteristics

- Individual components soldered on a printed circuit board
- Plug removal necessary for fuse-link replacement
- Fuse drawer meets requirements of medical standard IEC/EN 60601-1
- The fuseholder is accessible from the equipment front
- Qualified for use in equipment according IEC/EN 60950

References

Weblinks

[General Product Information](#), [Approvals](#), [RoHS](#), [CHINA-RoHS](#), [Mating Connectors](#), [e-Store](#), [SCHURTER-Stock-Check](#), [Distributor-Stock-Check](#), [Accessories](#)

Technical Data

Ratings IEC	10A / 250VAC; 50Hz
Ratings UL/CSA	10A / 250VAC; 60Hz
Allowable Operation Temp.	-25°C to 70°C
Degree of Protection	from front side IP 40 acc. to IEC 60529
Protection Class	Suitable for appliances with protection class 1 acc. to IEC 61140
Terminal	For PCB mounting
Panel Thickness s	Snap-in: 1/1.2/1.5/2/2.5/3 mm
Material: Housing	Thermoplastic, black, UL 94V-0

Appliance Inlet	C14 acc. to IEC/EN 60320-1, UL 498, CSA C22.2 no. 42 (for cold conditions) pin-temperature 70 °C, 10A, Protection Class 1
Fuseholder	1 or 2 pole, Shocksafe category PC2 acc. to IEC 60127-6, for fuse-links 5 x 20mm
Rated Power Acceptance @ Ta 23 °C	5 x 20: 2W (1 pole)/ 1.6W (2-pole) per pole
Power Acceptance @ Ta > 23°C	Admissible power acceptance at higher ambient temperature see derating curves

Dimensions

Appliance inlet with fuseholder

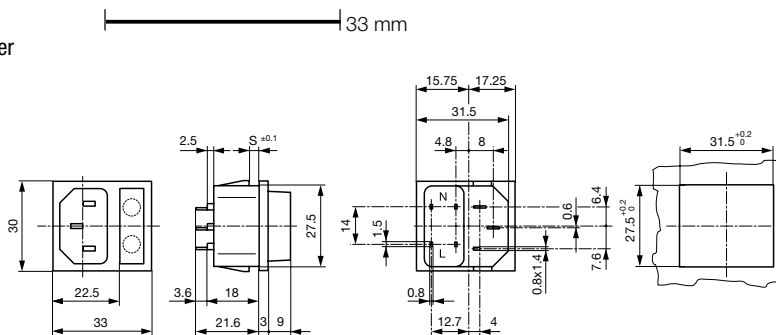

Appliance inlet with fuseholder

Variants

Type	Panel Thicknesses [mm]	Line Switch	Fuseholder	Inlet	Outlet	Order Number
Fuseholder	1	-	1-pole	C14	-	6250.5510
Fuseholder	1	-	2-pole	C14	-	6255.5510
Fuseholder	1.2	-	1-pole	C14	-	6250.5512
Fuseholder	1.2	-	2-pole	C14	-	6255.5512
Fuseholder	1.5	-	1-pole	C14	-	6250.5515
Fuseholder	1.5	-	2-pole	C14	-	6255.5515
Fuseholder	2	-	1-pole	C14	-	6250.5520
Fuseholder	2	-	2-pole	C14	-	6255.5520
Fuseholder	2.5	-	1-pole	C14	-	6250.5525
Fuseholder	2.5	-	2-pole	C14	-	6255.5525
Fuseholder	3	-	1-pole	C14	-	6250.5530
Fuseholder	3	-	2-pole	C14	-	6255.5530

Packaging unit 50 Pcs

Mating Outlets/Connectors

Category / Description



Appliance InletOverview complete

IEC Appliance inlet C16 0169

Appliance Inletfurther types to6250 / 6255



Appliance OutletOverview complete

IEC Appliance Outlet F, Screw-on Mounting, Front Side, Solder Terminal 4787

IEC Appliance Outlet F, Snap-in Mounting, Front Side, Solder or Quick-connect Terminal 4788

IEC Appliance Outlet F or H, Screw-on Mounting, Front Side, Solder, PCB or Quick-connect Terminal 5091

IEC Appliance Outlet F or H, Screw-on Mounting, Front Side, Solder or Quick-connect Terminal 5092

Appliance Outletfurther types to6250 / 6255



ConnectorOverview complete

IEC Connector C15, Rewireable, Straight 0101

IEC Connector C15A, Rewireable, Straight 0102

IEC Connector C15A, Rewireable, Straight 0102-G

IEC Connector C15A, Rewireable, Angled 0112

IEC Connector C13, Rewireable, Angled 4012

Connectorfurther types to6250 / 6255

...

Power CordOverview complete



Power Cord with IEC Connector C13, Angled 0311

Power Cord with IEC Connector C13, Angled 3011

Power Cord with IEC Connector C13, Angled 3012

Power Cord with IEC Connector C13, Angled 3013

Power Cord with IEC Connector C13 3020

Power Cordfurther types to6250 / 6255

...

Power Supply or Interconnection CordOverview complete

Divers Power Supply and Interconnection Cords 10 A Kabelverbindung/10 A

Power Supply or Interconnection Cordfurther types to6250 / 6255