

THESE DRAWINGS ARE THE PROPERTY OF QUALTEK ELECTRONICS AND NOT TO BE REPRODUCED FOR OR COMMUNICATED TO A THIRD PARTY WITHOUT THE EXPRESS WRITTEN PERMISSION OF AN OFFICER OF QUALTEK ELECTRONICS.

REVISION			
REV.	DESCRIPTION	DATE	APPROVED
B	RoHS Compliancy	06-01-06	DP

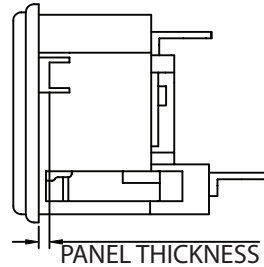
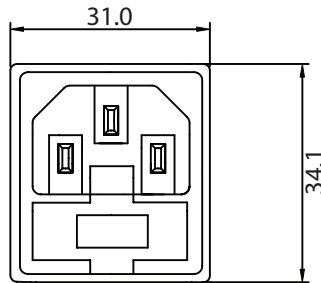

- 1.0
- 1.5
- 2.0
- 3.0

PART NO.	DIM A	TERMINAL
723A-*/28	38.0	2
723A-*/48	39.0	4
723A-*/63	39.0	5

\*\* DENOTES PANEL THICKNESS

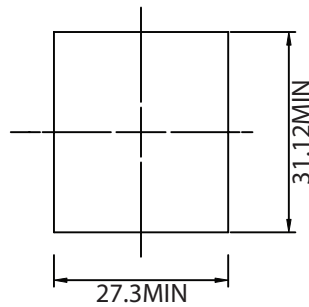
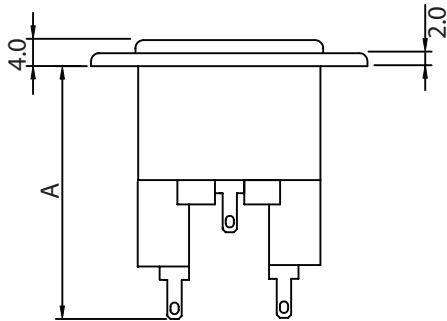

PANEL CUTOUT

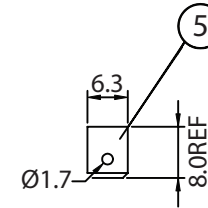
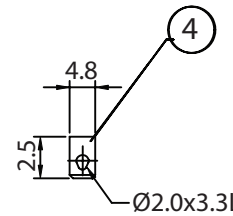
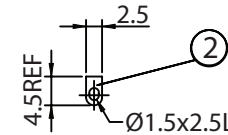

NOTES:

MATERIAL:

MOULDING: NYLON, FLAMMABILITY RATING UL 94V-0  
 CONTACTS: BRASS, PINS NICKEL PLATED, TAGS TIN PLATED  
 RATING: 10A 250V AC  
 CONTACT RESISTANCE: <15m OHM(POLE)  
 INSULATION RESISTANCE: >10<sup>3</sup> OHM AT 500V DC  
 AC BREAKDOWN:  
 POLE-POLE: 6kV  
 POLES-PANEL: 5.0kV  
 OPERATING TEMPERATURE: -20° C TO +70° C  
 MAX. PIN TEMPERATURE: +65° C  
 DOUBLE FUSED 5x20mm  
 APPROVALS: UL,CSA,VDE  
 RoHS COMPLIANT

**CONTROLLED**

Dim range (mm)	Tolerance +/- (mm)	Qualtek Electronics Corp. PPC DIVISION		
		Part Number: 723A SERIES	RoHS Compliant	
0-1	0.15	Description: AC RECEPTACLE		
1-6	0.20		UNIT: mm	REV. B
6-18	0.30			
18-50	0.50	Drawn / Date	Checked / Date	Approved / Date
50-120	0.70	B.Zhang 12-30-02	12-30-02	JJH / 12-30-02
120-250	0.90			
250-500	1.20			