

IEC Appliance Inlet C20, Snap-in Mounting, Front Side, Solder or Quick-connect Terminal



C20



70° C

**Description**

- Panel Mount:
- Snap-in, from front side
- Appliance Inlet, Pin temperature 70 °C, Protection class I
- Solder terminals or quick connect terminals

Approvals

- VDE Certificate Number: 40030341
- UL File Number: E96454

Other versions on request

- Types for enhanced glow wire test requirements acc. IEC 60695-2-11 to -13 for the use in unattended household equipment acc. IEC 60335-1
- Variant with notch for V-Lock mating Cordsets

ReferencesAlternative: protection class II version [4794](#)**Weblinks**

[General Product Information](#), [Approvals](#), [RoHS](#), [CHINA-RoHS](#), [Mating Connectors](#), [e-Store](#), [SCHURTER-Stock-Check](#), [Distributor-Stock-Check](#), [Accessories](#), [Wire Harness](#)

Newly available variants corresponding to V-Lock mating cordset. The connector is equipped with a notch intended for use with the latching cordset. The cord latching system prevents against accidental removal of the cordset.

Technical Data

Ratings IEC	16 A / 250 VAC; 50 Hz
Ratings UL/CSA	20 A / 250 VAC; 60 Hz
Dielectric Strength	> 2 kVAC between L-N > 2 kVAC between L/N-PE (1 min/50 Hz)
Allowable Operation Temp.	-25 °C to 70 °C
Degree of Protection	from front side IP 30 acc. to IEC 60529
Protection Class	Suitable for appliances with protection class 1 acc. to IEC 61140
Terminal	Solder terminals or quick connect terminals
Panel Thickness s	Snap-in: 1/1.2/1.5/2/2.5/3 mm
Material: Housing	Thermoplastic, black, UL 94V-0

Appliance Inlet	C20 acc. to IEC/EN 60320-1, UL 498, CSA C22.2 no. 42 (for cold conditions) pin-temperature 70 °C, 16 A, Protection Class 1
-----------------	---

Dimensions

4793

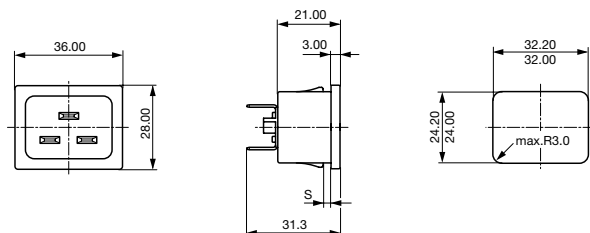

Variants

Panel mounting	Panel Thickness s [mm]	Terminal	Order Number
Snap-in	1	Quick connect terminals 6.3 x 0.8 mm	4793.3000
Snap-in	1.2	Quick connect terminals 6.3 x 0.8 mm	4793.8000
Snap-in	1.5	Quick connect terminals 6.3 x 0.8 mm	4793.4000
Snap-in	2	Quick connect terminals 6.3 x 0.8 mm	4793.5000
Snap-in	2.5	Quick connect terminals 6.3 x 0.8 mm	4793.6000
Snap-in	3	Quick connect terminals 6.3 x 0.8 mm	4793.7000
Snap-in	1	Solder terminals 3.8 x 0.8 mm	4793.3200
Snap-in	1.2	Solder terminals 3.8 x 0.8 mm	4793.8200
Snap-in	1.5	Solder terminals 3.8 x 0.8 mm	4793.4200
Snap-in	2	Solder terminals 3.8 x 0.8 mm	4793.5200
Snap-in	2.5	Solder terminals 3.8 x 0.8 mm	4793.6200
Snap-in	3	Solder terminals 3.8 x 0.8 mm	4793.7200

Articles for enhanced glow wire test requirements acc. IEC 60695-2-11 to -13 can be ordered with ending ".15" (xxxx.xxx.15). They are suitable for the use in unattended household equipment acc. IEC 60335-1.

Packaging unit 100 Pcs

Accessories

Description

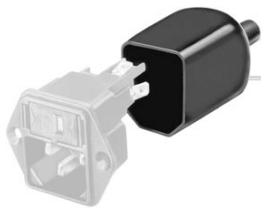

Assorted Covers
Rear Cover

0859.0047



Wire Harness
Wire harness for SCHURTER products



Cord retaining kits
Cord retaining strain relief

Flat head, L

4700.0011

Mating Outlets/Connectors

Category / Description

[ConnectorOverview complete](#)



IEC Connector C19, Rewireable, Straight	0104
IEC Connector C19, Rewireable, Angled	1651
IEC Connector C19, Rewireable, Straight	1652
IEC Connector C19, Rewireable, Angled	4790
IEC Connector C19, Rewireable, Straight	4795

[Connectorfurther types to4793](#)



Power Cord Overview complete

Power Cord with IEC Connector C19, Straight

1654

Power Cord further types to 4793

Power Supply or Interconnection Cord Overview complete

Divers Power Supply and Interconnection Cords 16 A

Kabelverbindung/16 A

Power Supply or Interconnection Cord further types to 4793