

EMI PINS REMAIN FLAT. NO THROUGH HOLES IN PCB NECESSARY.

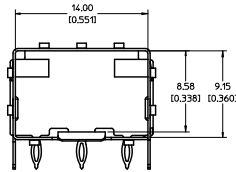
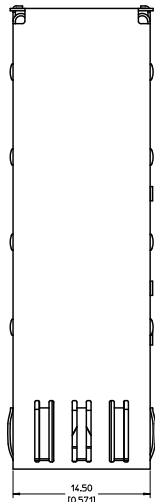

SPRING FINGER GASKET WITH TWO POINTS OF CONTACT. COMPLIES WITH (SFP) MSA BOARD AND BEZEL LOCATIONS.

TABS USED TO MOUNT LIGHT PIPE COVER

CAGE IDENTIFICATION LAST 2 DIGITS P/N AND REV LETTER (ex: 36 X)

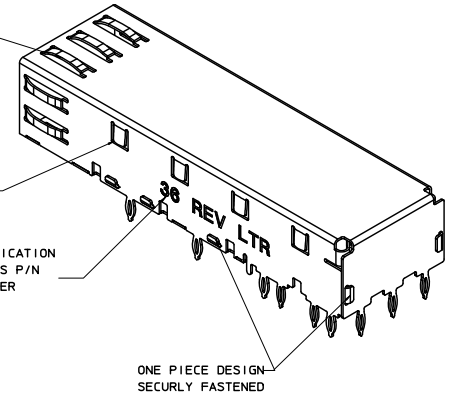

ONE PIECE DESIGN SECURELY FASTENED

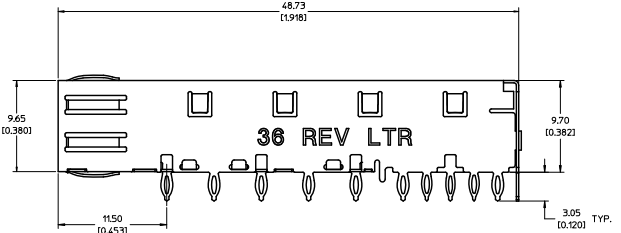

NOTES:

1. PRESS FIT LEGS, 0.120 INCHES LONG. 1.57 [0.062] MINIMUM PCB THICKNESS.
2. THIS CAGE IS FOR SINGLE SIDED USE ONLY.
3. CAN BE USED WITH THE FOLLOWING LIGHT PIPE PART NUMBERS:

747260001 - LIGHT PIPE FROM BACK TO TOP (REFER TO DOCUMENT SD-74726-001)

747260002 - LIGHT PIPE FROM SIDE TO TOP (REFER TO DOCUMENT SD-74726-002)

4. MATERIAL: COPPER ALLOY PLATING: PRE-PLATED WITH NICKEL

5. THIS PART MEETS THE RESTRICTION OF HAZARDOUS SUBSTANCES IN ELECTRICAL AND ELECTRONIC EQUIPMENT (ROHS) DIRECTIVE (2002/95/EC).

INITIAL RELEASE 2010/08/18 DRAWN BY: JERWIN CHECKED BY: A. JOHNSTON APPROVED BY: J. ANOTA DATE: 2010/08/18 DESCRIPTION: SFP ONE PIECE CAGE PRESS-FIT (0.120 LEGS) NO EMI PINS	QUALITY SYMBOLS	GENERAL TOLERANCES (UNLESS SPECIFIED)	DIMENSION STYLE	SCALE	DESIGN UNITS	THIRD ANGLE PROJECTION															
	$\nabla=0$ $\nabla=0$	<table border="1"> <thead> <tr> <th></th> <th>MM</th> <th>INCH</th> </tr> </thead> <tbody> <tr> <td>4 PLACES ±</td> <td>± 0.05</td> <td>± 0.002</td> </tr> <tr> <td>3 PLACES ±</td> <td>± 0.005</td> <td></td> </tr> <tr> <td>2 PLACES ±</td> <td>± 0.01</td> <td></td> </tr> <tr> <td>1 PLACE ±</td> <td>± 0.25</td> <td></td> </tr> </tbody> </table>		MM	INCH	4 PLACES ±	± 0.05	± 0.002	3 PLACES ±	± 0.005		2 PLACES ±	± 0.01		1 PLACE ±	± 0.25		MM/IN	5:1	METRIC	
		MM	INCH																		
	4 PLACES ±	± 0.05	± 0.002																		
3 PLACES ±	± 0.005																				
2 PLACES ±	± 0.01																				
1 PLACE ±	± 0.25																				
DRAFT WHERE APPLICABLE MUST REMAIN WITHIN DIMENSIONS	MATERIAL NO. 747370036	DRAWN BY: JERWIN DATE: 2010/08/18	CHECKED BY: A. JOHNSTON DATE: 2010/08/18	TITLE: SFP ONE PIECE CAGE PRESS-FIT (0.120 LEGS) NO EMI PINS	MOLEX INCORPORATED	SHEET NO. 1 OF 4															
		THIS DRAWING CONTAINS INFORMATION THAT IS PROPRIETARY TO MOLEX INCORPORATED AND SHOULD NOT BE USED WITHOUT WRITTEN PERMISSION		DOCUMENT NO. SD-74737-0036																	

- DATUM AND BASIC DIMENSIONS ESTABLISHED BY CUSTOMER.
- PADS AND VIAS ARE CHASSIS GROUND.
- HOLE LAYOUT SHOWN IS FOR SINGLE SIDED MOUNTING ONLY.
- CONNECTOR PAD LAYOUT PER SFP MSA, WILL ACCOMMODATE MOLEX CONNECTOR SERIES 74441 OR EQUIVALENT.
- THESE HOLES OPTIONAL.

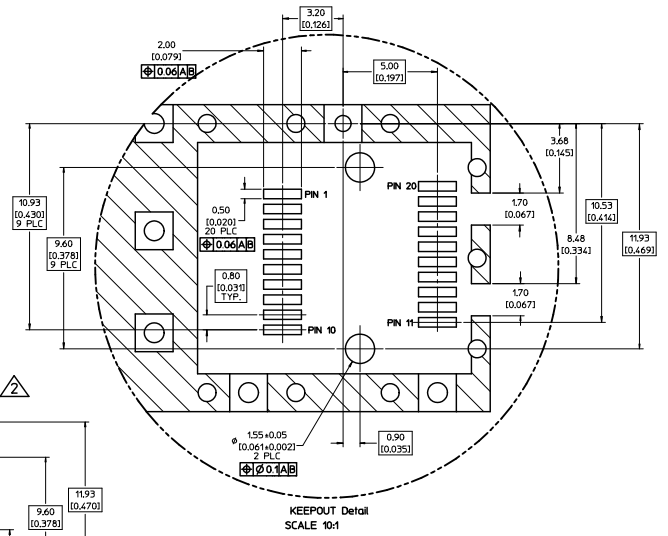
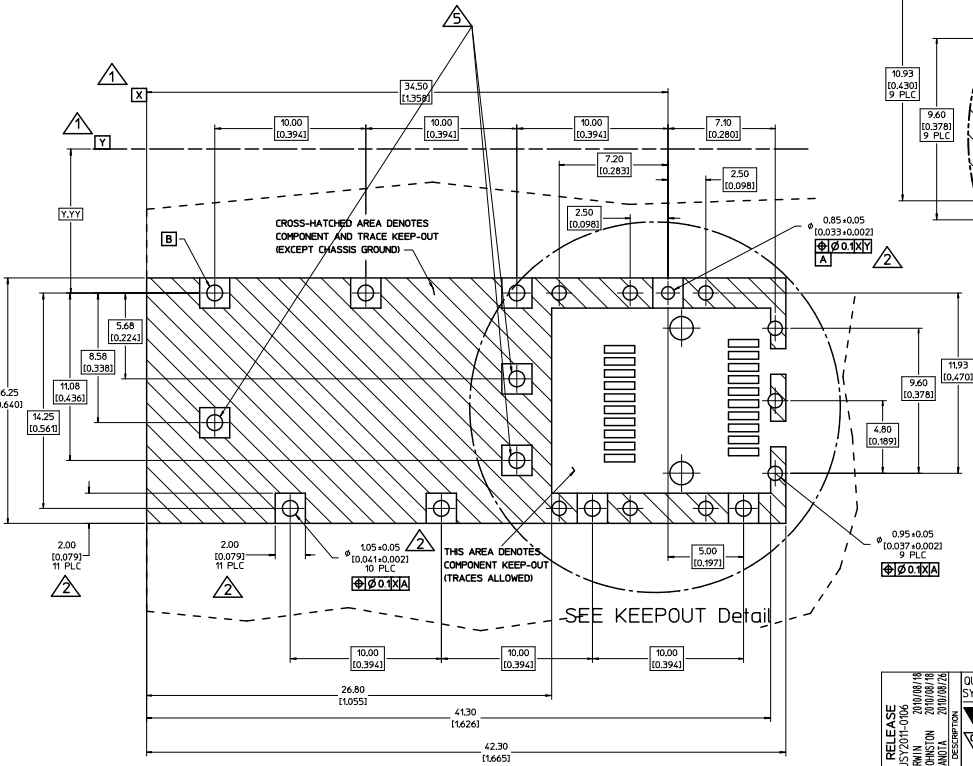

INITIAL RELEASE DATE: 2010/08/18 BY: JERWIN CHECKED BY: A. JOHNSTON APPROVED BY: K. JANOTA	QUALITY SYMBOLS	GENERAL TOLERANCES (UNLESS SPECIFIED)	DIMENSION STYLE	SCALE	DESIGN UNITS	THIRD ANGLE PROJECTION
	∇ 0 ∇ 0.1 ∇ 0.25	4 PLACES ± --- ± --- 3 PLACES ± --- ± 0.05 2 PLACES ± 0.13 ± 0.1 1 PLACE ± 0.25 ± --- ANGULAR ± 1 °	MM/IN	8:1	METRIC	\odot \triangleleft
	DRAWN BY: JERWIN CHECKED BY: A. JOHNSTON APPROVED BY: K. JANOTA	DATE: 2010/08/18 DATE: 2010/08/18 DATE: 2010/08/26	TITLE: SFP ONE PIECE CAGE PRESS-FIT (0.120 LEGS) NO EMI PINS MOLEX INCORPORATED	MATERIAL NO.: 747370036 DOCUMENT NO.: SD-74737-0036	SHEET NO.: 2 OF 4	
	DRAFT WHERE APPLICABLE MUST REMAIN WITHIN DIMENSIONS THIS DRAWING CONTAINS INFORMATION THAT IS PROPRIETARY TO MOLEX INCORPORATED AND SHOULD NOT BE USED WITHOUT WRITTEN PERMISSION					

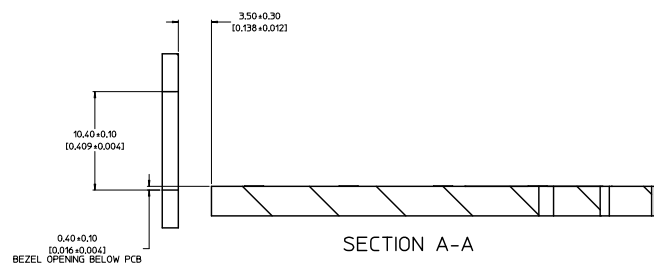
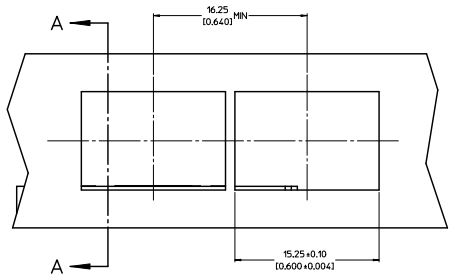
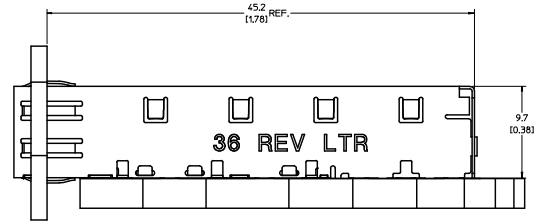

INITIAL RELEASE E.C. MULLINS 2010/08/08 DRAWN BY JERWIN 2010/08/18 CHECKED BY AJOHNSTON 2010/08/18 APPROVED BY J.JANOTA 2010/08/26 REV DESCRIPTION	QUALITY SYMBOLS	GENERAL TOLERANCES (UNLESS SPECIFIED)	DIMENSION STYLE	SCALE	DESIGN UNITS	THIRD ANGLE PROJECTION	
	▽=0 ▽=0.1	4 PLACES ± --- ± --- 3 PLACES ± --- ± 0.005 2 PLACES ± 0.13 ± 0.1 1 PLACE ± 0.25 ± --- ANGULAR ± 1 °	MM/IN	5:1	METRIC		
		DRAFT WHERE APPLICABLE MUST REMAIN WITHIN DIMENSIONS					
			MATERIAL NO. 747370036	DOCUMENT NO. SD-74737-0036	MOLEX INCORPORATED SHEET NO. 3 OF 4		

16_Frame_D.P. AM.1
Rev. E 2006/04/15

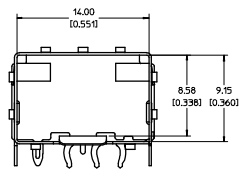
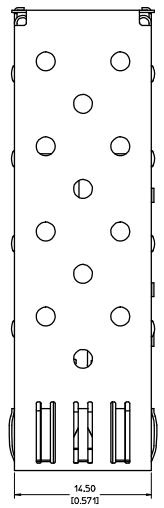
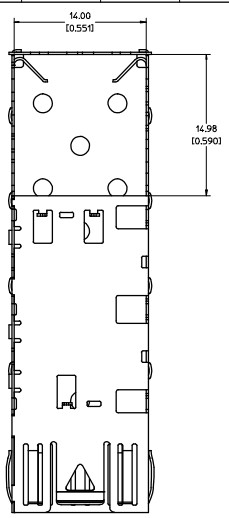

SPRING FINGER GASKET WITH TWO POINTS OF CONTACT. COMPLIES WITH (SFP) MSA BOARD AND BEZEL LOCATIONS.

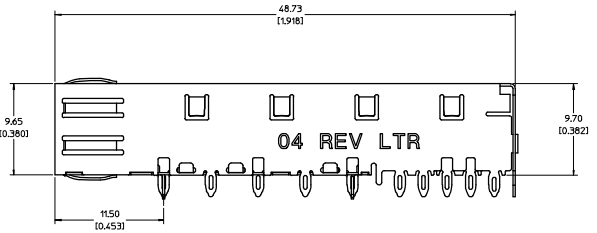
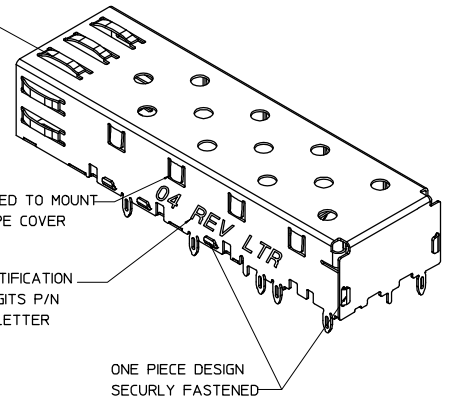

- NOTES:
- PRESS FIT LEGS, 0.090 INCHES LONG. 157 [0.062] MINIMUM PCB THICKNESS.
 - CAN BE USED WITH THE FOLLOWING LIGHT PIPE PART NUMBERS:
 - 747260001 - LIGHT PIPE FROM BACK TO TOP (REFER TO DOCUMENT SD-74726-001)
 - 747260002 - LIGHT PIPE FROM SIDE TO TOP (REFER TO DOCUMENT SD-74726-002)
 - MATERIAL: COPPER ALLOY
PLATING: PRE-PLATED WITH NICKEL
 - THIS PART MEETS THE RESTRICTION OF HAZARDOUS SUBSTANCES IN ELECTRICAL AND ELECTRONIC EQUIPMENT (ROHS) DIRECTIVE (2002/95/EC).

3 UPDATED 3D MODELS ELC INC. 2008-02-02 C: DRAWING COX 2007/11/30 CHKD: 2007/12/01 APPR: MUMFORD 2007/12/01 REV DESCRIPTION	QUALITY SYMBOLS	GENERAL TOLERANCES (UNLESS SPECIFIED)	DIMENSION STYLE	SCALE	DESIGN UNITS	THIRD ANGLE PROJECTION	
	∇ ∇	4 PLACES ± --- INCH 3 PLACES ± --- ±.005 2 PLACES ± 0.13 ±.01 1 PLACE ± 0.25 ± --- ANGULAR ± 1 °	MM/IN	5:1	METRIC		
		DRAFT WHERE APPLICABLE MUST REMAIN WITHIN DIMENSIONS	MATERIAL NO. 747370004	DRAWN BY CCX DATE 2006/11/30	CHECKED BY RMAHMOOD DATE 2006/11/30	TITLE SFP ONE PIECE CAGE 0.090" PRESS FIT LEGS BLY-BLY ASSEMBLY	
				APPROVED BY RMAHMOOD DATE		MOLEX INCORPORATED	SHEET NO. 1 OF 4

20 19 18 17 16 15 14 13 12 11 10 9 8 7 6 5 4 3 2 1

M L K J I H G F E D C B A

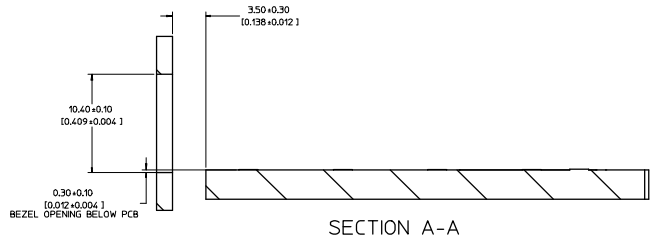
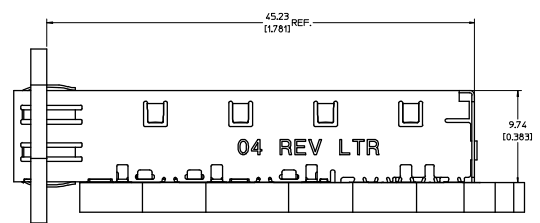
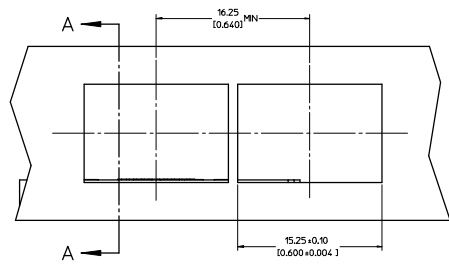

UNPLATED 3D MODELS FILE: 2006-11-30-04-05 C:\WORK\COX CHKCD: 2007/12/07 APPROV:MMMOE 2007/12/07 REV:	QUALITY SYMBOLS	GENERAL TOLERANCES (UNLESS SPECIFIED)	DIMENSION STYLE	SCALE	DESIGN UNITS	THIRD ANGLE PROJECTION																
	▽=0 ▽=0	<table border="1"> <thead> <tr> <th></th> <th>mm</th> <th>INCH</th> </tr> </thead> <tbody> <tr> <td>4 PLACES ± ---</td> <td>± ---</td> <td>± ---</td> </tr> <tr> <td>3 PLACES ± ---</td> <td>± 0.05</td> <td>± ---</td> </tr> <tr> <td>2 PLACES ± 0.13</td> <td>± 0.1</td> <td>± ---</td> </tr> <tr> <td>1 PLACE ± 0.25</td> <td>± ---</td> <td>± ---</td> </tr> </tbody> </table>		mm	INCH	4 PLACES ± ---	± ---	± ---	3 PLACES ± ---	± 0.05	± ---	2 PLACES ± 0.13	± 0.1	± ---	1 PLACE ± 0.25	± ---	± ---	DRAWN BY: CCOX DATE: 2006/11/30 CHECKED BY: RMAHM000 DATE: 2006/11/30 APPROVED BY: RMAHM000 DATE:	MM/IN	5:1	METRIC	SFP ONE PIECE CAGE 0.090" PRESS FIT LEGS BLY-BLY ASSEMBLY
		mm	INCH																			
	4 PLACES ± ---	± ---	± ---																			
3 PLACES ± ---	± 0.05	± ---																				
2 PLACES ± 0.13	± 0.1	± ---																				
1 PLACE ± 0.25	± ---	± ---																				
DRAFT WHERE APPLICABLE MUST REMAIN WITHIN DIMENSIONS	MATERIAL NO.: 747370004 DOCUMENT NO.: SD-74737-004	SHEET NO.: 3 OF 4																				
THIS DRAWING CONTAINS INFORMATION THAT IS PROPRIETARY TO MOLEX INCORPORATED AND SHOULD NOT BE USED WITHOUT WRITTEN PERMISSION																						

Is:Jrme_D.P. AM 1
Rev. D 2004/06/28

19 18 17 16 15 14 13 12 11 10 9 8 7 6 5 4 3 2 1

