

| REVISIONS | | | | |
|-----------|------|-------------------------------------|-----|----------|
| REV | DATE | DESCRIPTION | BY | APPROVED |
| 1 | | ELASTOMER GASKET OPTION ADDED | ZLJ | |
| 2 | | FOAM GASKET OPTION ADDED | ZLJ | |
| 3 | | STAINLESS STEEL GASKET OPTION ADDED | ZLJ | |

FS1-SF1-1XXX

MOUNTING SCREW OPTION

- 1 = 8 mm MOUNTING SCREW SHIPPED BULK IN SAME TRAYS WITH CAGE ASSEMBLIES
- 2 = NO MOUNTING SCREW SUPPLIED
- 3 = 10 mm MOUNTING SCREW WITH LOCK WASHER SHIPPED BULK IN SAME TRAYS WITH CAGE ASSEMBLIES

GASKET OPTION

- E = STAINLESS STEEL EMI GASKET
- F = FOAM, CHOMERICS SOFT SHIELD 4800, EMI GASKET
- C = CONDUCTIVE ELASTOMER, CHOMERICS S6305

KEYING OPTION (SEE BELOW TABLE FOR FURTHER CLARIFICATION)

- 0 = NO KEY
- 1 = KEY #1
- 2 = KEY #2
- 3 = KEY #3
- 4 = KEY #4
- 5 = KEY #5
- 6 = KEY #6
- 7 = KEY #7
- 2,4 = KEY #2 AND #4
- 4,6 = KEY #4 AND #6

| Key Option | Part Number | Description |
|------------|---------------|--------------------|
| 0 | FS1-SF1-10XX | No Key |
| 1 | FS1-SF1-11XX | SATA 'X' Cable |
| 2 | FS1-SF1-12XX | |
| 3 | FS1-SF1-13XX | |
| 4 | FS1-SF1-14XX | SAS Universal Port |
| 5 | FS1-SF1-15XX | |
| 6 | FS1-SF1-16XX | |
| 7 | FS1-SF1-17XX | SATA 'M' Cable |
| 2,4 | FS1-SF1-124XX | SAS Out Port |
| 4,6 | FS1-SF1-146XX | SAS In Port |

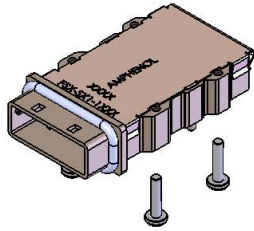

PART NUMBER: **FS1-SF1-14C1** SHOWN
(CAGE ASSEMBLY WITH ELASTOMERIC GASKET AND 8mm MOUNTING SCREWS SHIPPED BULK)

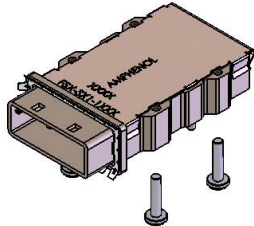

PART NUMBER: **FS1-SF1-14E1** SHOWN
(CAGE ASSEMBLY WITH STAINLESS STEEL GASKET AND 8mm MOUNTING SCREWS SHIPPED BULK)

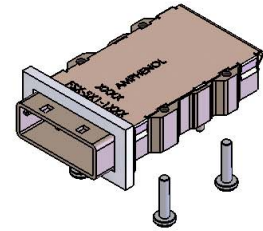

PART NUMBER: **FS1-SF1-14F1** SHOWN
(CAGE ASSEMBLY WITH FOAM GASKET AND 8mm MOUNTING SCREWS SHIPPED BULK)



DO NOT SCALE DRAWING

THIS DOCUMENT CONTAINS PROPRIETARY INFORMATION AND SUCH INFORMATION MAY NOT BE DISCLOSED TO OTHERS FOR ANY PURPOSE OR USED FOR MANUFACTURING PURPOSES WITHOUT PERMISSION FROM AMPHENOL CANADA CORP.

| UNLESS OTHERWISE SPECIFIED DIMENSIONS ARE IN MILLIMETERS TOLERANCES ARE: | | APPROVALS | DATE | Amphenol Canada Corp. | |
|--|-----------|-----------|------|-----------------------|------------------------------------|
| DECIMAL | ANGLES | DESIGNED | ZLJ | JAN 06/09 | MINI SAS 0 DEGREE SINGLE PORT CAGE |
| XX ± 0.25 | ±2° | CHECKED | ZLJ | JAN 06/09 | |
| XX ± 0.10 | | DRAWN | | | P-FS1-SF1-1XXX U |
| XXX ± 0.05 | | DATE | | | |
| EXTERNAL AND FINISH | | DATE | | | 1 OF 1 |
| ENG. NO. | EAR 123XX | DATE | | | |
| CODE GEN. NO. | 03554 | REV. NO. | C | NTS | SFF |

Item is Unsolvable
Item Conflicts

| REVISIONS | | | |
|-----------|------|-------------|-----|
| REV. | DATE | DESCRIPTION | BY |
| 1 | | SEE SHEET 1 | ZLJ |
| 2 | | SEE SHEET 1 | ZLJ |

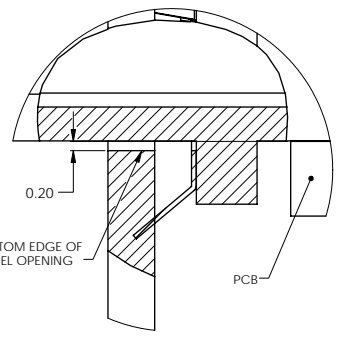
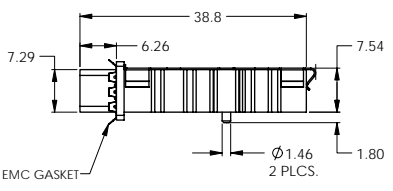
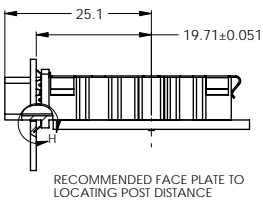
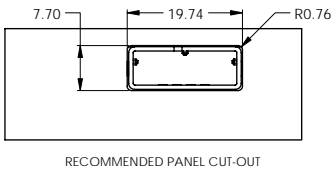
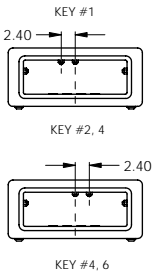
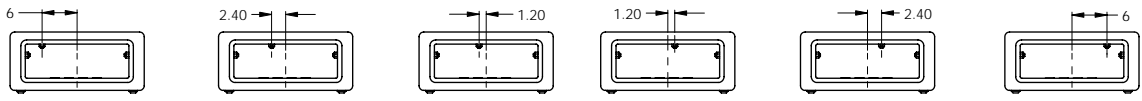

DETAIL H
SCALE 16 : 1

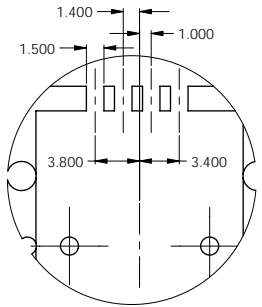
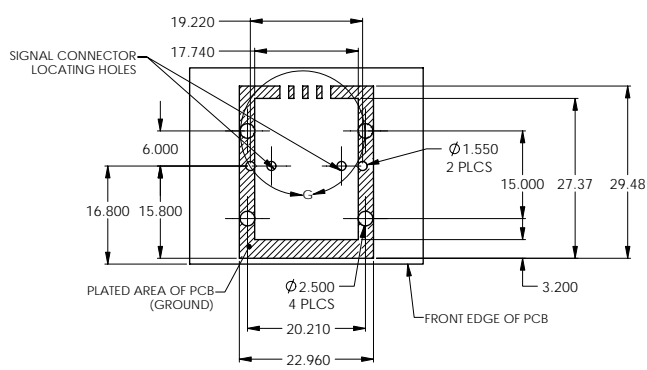

DETAIL G
SCALE 4 : 1

NOTES:
 1) MATERIAL:
 MAIN CAGE: ZINC DIECAST SHELL WITH 150 MICROINCHES OF NICKEL PLATING
 EMC GASKET: SEE SHEET 1
 COVER: STAINLESS STEEL
 MOUNTING SCREW: AISI 1010 STEEL
 2) ROHS COMPLIANT



| UNLESS OTHERWISE SPECIFIED DIMENSIONS ARE IN MILLIMETERS TOLERANCES ARE: | APPROVALS | DATE | Amphenol Canada Corp. |
|--|------------------|-----------------|------------------------------------|
| DECIMALS: .05 | DESIGNED: ZLJ | JAN 06/09 | MINI SAS 0 DEGREE SINGLE PORT CAGE |
| XX ± 0.10 | CHECKED: ZLJ | JAN 06/09 | |
| XXX ± 0.05 | DRAWN: | | |
| EXTERNAL AND FINISH: | DATE: | | |
| ENGINEER: | APP'D: | | |
| CODE GEN NO: 03554 | REV: C | DATE: 05/09 | P-FS1-SF1-1XXX U |
| | DESIGNED BY: NTS | REVISED BY: SFF | 1 OF 1 |

DO NOT SCALE DRAWING

THIS DOCUMENT CONTAINS PROPRIETARY INFORMATION AND SUCH INFORMATION MAY NOT BE DISCLOSED TO OTHERS FOR ANY PURPOSE OR USED FOR MANUFACTURING PURPOSES WITHOUT PERMISSION FROM AMPHENOL CANADA CORP.