

REVISONS		DATE	BY	APP
E	REVISED PER ECO-10-015550		EMENDI	JTL

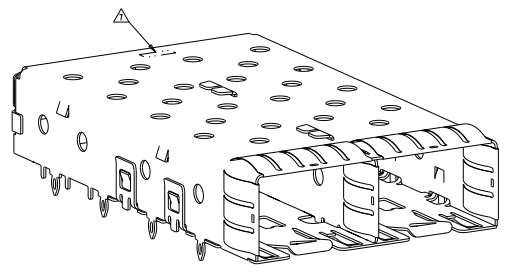

- ⚠ MATERIAL:
COPPER ALLOY.
- ⚠ FINISH:
CAGE: 1.25µm MIN TIN OVER NICKEL FLASH. NON PLATED EDGES PERMISSIBLE.
SPRINGS: 0.8µm MIN TIN OVER 0.8µm MIN NICKEL. NON PLATED EDGES PERMISSIBLE.
- ⚠ PADS AND VIAS CHASSIS GROUND.
- ⚠ DATUMS AND BASIC DIMENSIONS ESTABLISHED BY CUSTOMERS.
- ⚠ MATES WITH SFP MSA COMPLIANT TRANSCEIVERS.
- ⚠ REFERENCE APPLICATION SPEC 114-13120, HOLE A, FOR RECOMMENDED DRILL HOLE DIAMETER AND PLATING THICKNESSES.
- ⚠ COMPANY LOGO IN APPROXIMATE AREA SHOWN.

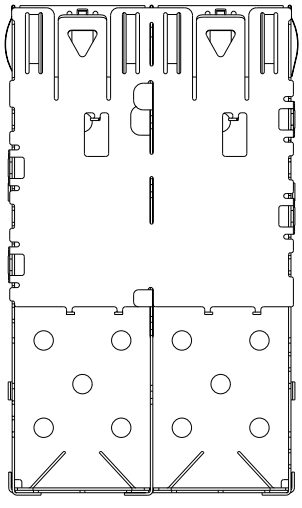
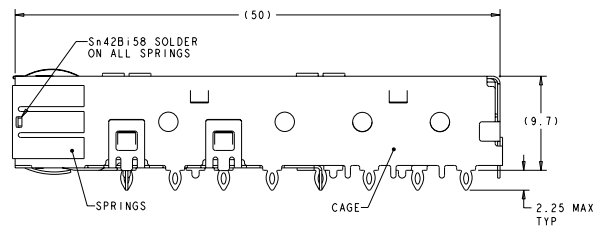
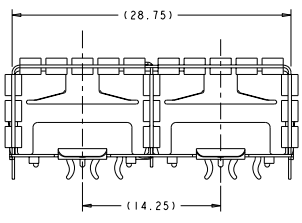
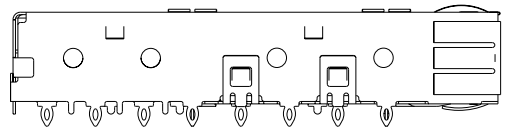

0.15	10.15	30.75	29.5	1X2 ASSEMBLY	1888424-1
D±0.1	C±0.1	B MIN	A±0.1	DESCRIPTION	PART NUMBER

DATE: 10/10/10 BY: JTL CHECKED: JTL APPROVED: JTL TITLE: CUSTOMER DRAWING	DATE: 10/10/10 BY: JTL CHECKED: JTL APPROVED: JTL TITLE: CUSTOMER DRAWING	DATE: 10/10/10 BY: JTL CHECKED: JTL APPROVED: JTL TITLE: CUSTOMER DRAWING	DATE: 10/10/10 BY: JTL CHECKED: JTL APPROVED: JTL TITLE: CUSTOMER DRAWING	DATE: 10/10/10 BY: JTL CHECKED: JTL APPROVED: JTL TITLE: CUSTOMER DRAWING	DATE: 10/10/10 BY: JTL CHECKED: JTL APPROVED: JTL TITLE: CUSTOMER DRAWING
---	---	---	---	---	---

