

4

3

2

1

THIS DRAWING IS UNPUBLISHED. RELEASED FOR PUBLICATION AUG. 2006.
 COPYRIGHT 2011 BY TYCO ELECTRONICS CORPORATION. ALL RIGHTS RESERVED.

LOC	DIST	REVISIONS			
P	LTR	DESCRIPTION	DATE	DWN	APVD
DW	-	REVISED (ECR-11-004010)	23FEB11	AW	WK

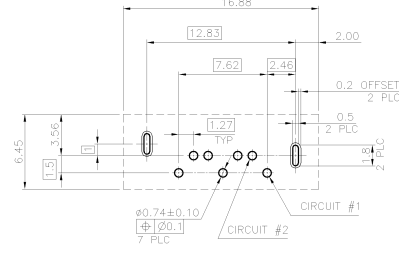
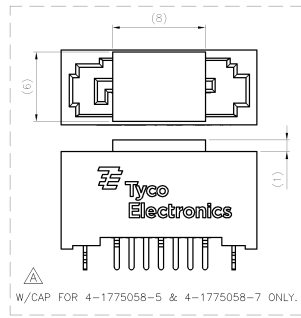
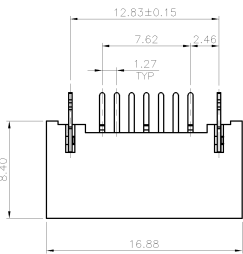

TOLERANCE: ±0.05, THICKNESS: (ESTABLISHED BY CUSTOMER)
 RECOMMENDED FOR LAYOUT (TOP VIEW)

DIM L	HOUSING COLOR	MIN. GOLD THICKNESS	PART NUMBER	STATUS
3.30	YELLOW (1235C)	15µ"	4-1775058-1	
	G/F	G/F	4-1775058-0	
	LIGHT BLUE (284C)	15µ"	3-1775058-9	
2.05	WHITE (7506U)	15µ"	3-1775058-7	
	G/F	G/F	3-1775058-6	
	RED (208C)	30µ"	3-1775058-5	
3.30	G/F	G/F	3-1775058-3	
	GREEN (339C)	30µ"	3-1775058-2	
	G/F	G/F	3-1775058-0	AVAILABLE
	DARKEST BLUE (661C)	30µ"	2-1775058-9	
	G/F	G/F	2-1775058-8	
	G/F	G/F	2-1775058-6	
2.40	BLACK	15µ"	2-1775058-5	
	G/F	G/F	2-1775058-4	
	GRAY (422U)	30µ"	2-1775058-3	OBSOLETE
1.80	G/F	G/F	2-1775058-2	AVAILABLE
	DARKEST BLUE (661C)	15µ"	2-1775058-1	OBSOLETE
	G/F	G/F	1-1775058-8	AVAILABLE
	ORANGE (157C)	30µ"	1-1775058-9	
	G/F	G/F	1-1775058-6	OBSOLETE
	G/F	G/F	1-1775058-4	OBSOLETE
2.05	LIGHT BLUE (284C)	30µ"	1-1775058-3	
	G/F	G/F	1-1775058-2	AVAILABLE
	DARK BLUE (293C)	15µ"	1775058-8	AVAILABLE
2.05	G/F	G/F	1775058-7	AVAILABLE
	WHITE (COOL GRAY 1C)	30µ"	1775058-6	OBSOLETE
	G/F	G/F	1775058-5	OBSOLETE
2.05	BLACK	30µ"	1775058-3	AVAILABLE
	G/F	G/F	1775058-2	AVAILABLE

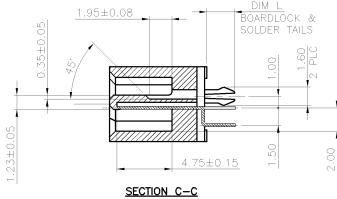
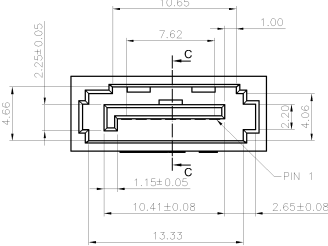

- NOTES:
- MATERIAL:
HOUSING: PA6T UL94 V-0, COLOR: (SEE TABLE)
CAP: LCP UL94 V-0, BLACK COLOR.
CONTACT: BRASS.
PES: BRASS.
 - FINISH:
CONTACT: GOLD (SEE TABLE) PLATING ON CONTACT AREA 100µ" MIN. MATTE-TIN PLATING ON SOLDERTAILS 50µ" MIN. NICKEL UNDERPLATING OVER ALL.
PEG: 100µ" MIN. TIN PLATING ON SOLDERTAILS 50µ" MIN. NICKEL UNDERPLATING OVER ALL.
 - WAVE SOLDER CAPABLE TO 265°C AS PER TE SPEC. 109-202, CONDITION B.
 - TAPE AND REEL PACKAGING.
 - NO DATECODE ON THE PRODUCT.

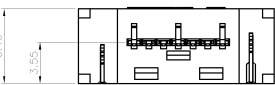
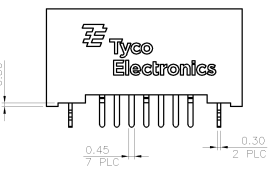

THIS DRAWING IS A CONTROLLED DOCUMENT.

DIMENSIONS: MM	TOLERANCES UNLESS OTHERWISE SPECIFIED:	OWN: A. WU 05SEP2008	CHK: S. CHIEN 05SEP2008	APVD: W. KODAMA 05SEP2008	NAME: Tyco Electronics Corporation Taipei, Taiwan
0 PLC ± -	1 PLC ± 0.3	PRODUCT SPEC: 108-57469			SERIAL ATA CONNECTOR, 7 PIN, VERTICAL HEADER, B TYPE.
2 PLC ± 0.25	3 PLC ± 0.2	APPLICATION SPEC: -			
4 PLC ± -	ANGLES ± 3°	WEIGHT: 1 GRAM	SIZE: A3	CAGE CODE: 00779	DRAWING NO: C-1775058
MATERIAL: SEE NOTE	FINISH: SEE NOTE	CUSTOMER DRAWING	SCALE: -	SHEET: 1 of 3	REV: E

4

3

2

1

THIS DRAWING IS UNPUBLISHED. RELEASED FOR PUBLICATION AUG. 2006.
 © COPYRIGHT 2011 BY TYCO ELECTRONICS CORPORATION. ALL RIGHTS RESERVED.

LOC	DIST	REVISIONS			
P	LTR	DESCRIPTION	DATE	DWN	APVD
		SEE SHEET 1.			

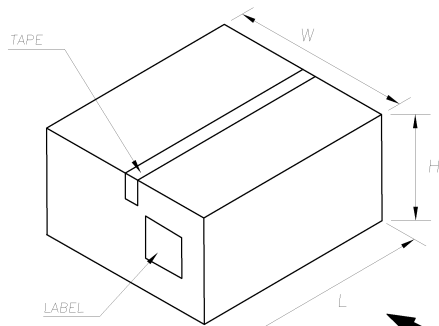

BOX

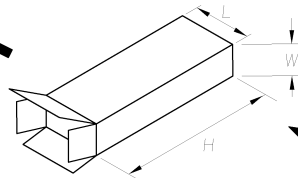

INNER CARTON

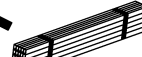

SHEAF

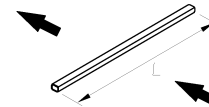

TUBE



CONNECTOR

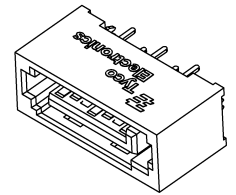

NOTE:

- DIMENSION:
 TUBE: L= 473, W= 13.4, H= 8.1
 INNER CARTON: L= 485, W= 72, H= 86
 CARTON: L= 500, W= 187, H= 169
- QUANTITY:
 26 PCS/TUBE
 45 TUBES/SHEAF
 1 SHEAFS/INNER CARTON
 4 INNER CARTONS/CARTON
 4680 PCS/BOX
- WEIGHT:
 N/W: 4.68 KG
 G/W: 6.68 KG

THIS DRAWING IS A CONTROLLED DOCUMENT.		DWN	Tyco Electronics Corporation Taipei, Taiwan															
DIMENSIONS: MM		CHK	NAME															
<table border="1"> <tr> <th colspan="2">TOLERANCES UNLESS OTHERWISE SPECIFIED:</th> </tr> <tr> <td>0 PLC</td> <td>± -</td> </tr> <tr> <td>1 PLC</td> <td>± -</td> </tr> <tr> <td>2 PLC</td> <td>± -</td> </tr> <tr> <td>3 PLC</td> <td>± -</td> </tr> <tr> <td>4 PLC</td> <td>± -</td> </tr> <tr> <td>ANGLES</td> <td>± -</td> </tr> </table>		TOLERANCES UNLESS OTHERWISE SPECIFIED:		0 PLC	± -	1 PLC	± -	2 PLC	± -	3 PLC	± -	4 PLC	± -	ANGLES	± -	APVD	SERIAL ATA CONNECTOR, 7 PIN, VERTICAL HEADER, B TYPE.	
TOLERANCES UNLESS OTHERWISE SPECIFIED:																		
0 PLC	± -																	
1 PLC	± -																	
2 PLC	± -																	
3 PLC	± -																	
4 PLC	± -																	
ANGLES	± -																	
MATERIAL	FINISH	PRODUCT SPEC	SIZE	CAGE CODE														
		APPLICATION SPEC	A3	00779														
		WEIGHT	DRAWING NO	RESTRICTED TO														
		CUSTOMER DRAWING	C-1775058															
			SCALE	SHEET														
				2 of 3														
				REV E														

4

3

2

1

THIS DRAWING IS UNPUBLISHED. RELEASED FOR PUBLICATION AUG 2006 .
 © COPYRIGHT 2011 BY TYCO ELECTRONICS CORPORATION. ALL RIGHTS RESERVED.

LDC		DIST		REVISIONS			
P	LTR	DESCRIPTION	DATE	DWN	APVD		
DW		SEE SHEET 1.					

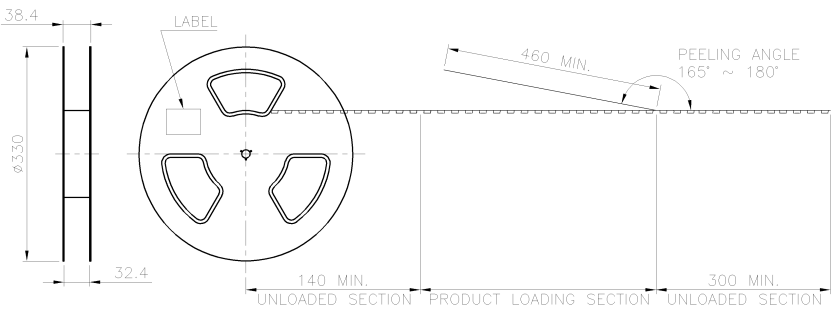

- NOTES:
- MATERIAL:
 BOX: FIBREBOARD, CORRUGATED, DOUBLE WALL.
 COVER TAPE: PET, TRANSPARENT COLOR.
 CARRIER TAPE: POLYSTYRENES, TRANSPARENT COLOR.
 REEL: HIPS, BLUE COLOR.
 BAG: POLYETHYLENES, TRANSPARENT COLOR.
 - EACH BAG SHALL BE INCLUDED DESICCANT.
 - PEELING STRENGTH: 0.1 ~ 1.3 N (10 ~ 130 GRAMS).
 - PEELING SPEED: 300 mm/min.

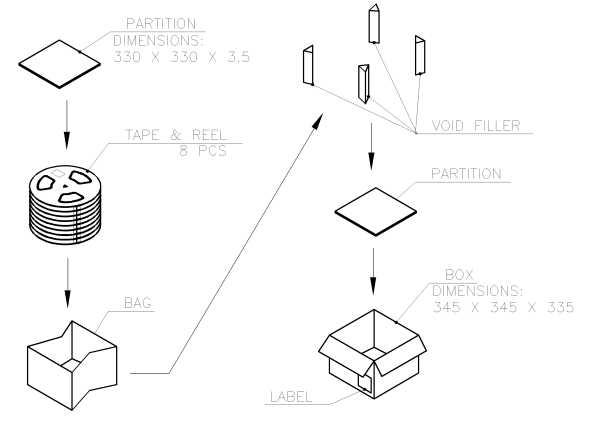
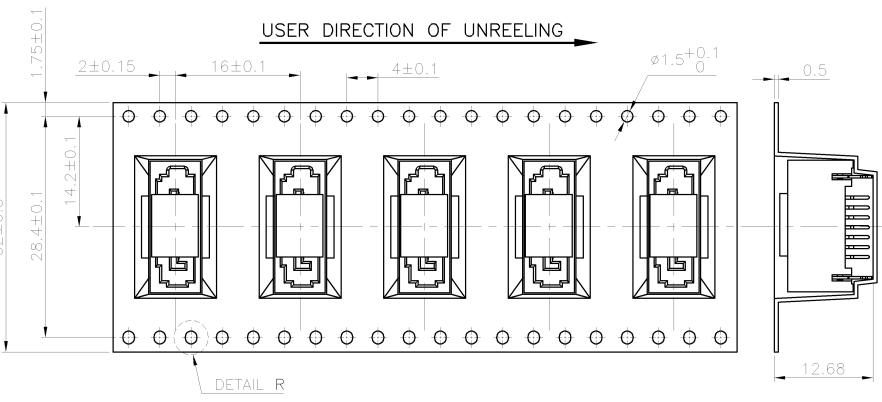

2400	8	300	4-1775058-7
PCS/BOX	REELS/BOX	PCS/TAPE	PART NUMBER

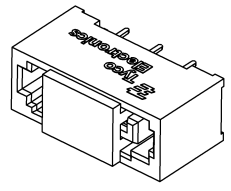
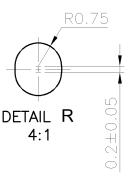

THIS DRAWING IS A CONTROLLED DOCUMENT.		DWN	
DIMENSIONS: MM		CHK	
TOLERANCES UNLESS OTHERWISE SPECIFIED:		APVD	
0 PLC	±	PRODUCT SPEC	
1 PLC	±	APPLICATION SPEC	
2 PLC	±	WEIGHT	
3 PLC	±	CUSTOMER DRAWING	
4 PLC	±		
ANGLES	±		
MATERIAL			
FINISH			

Tyco Electronics		Tyco Electronics Corporation Taipei, Taiwan	
NAME			
SERIAL ATA CONNECTOR, 7 PIN, VERTICAL HEADER, B TYPE.			
SIZE	CAGE CODE	DRAWING NO	RESTRICTED TO
A3	00779	C-1775058	
SCALE		SHEET	REV
		3 of 3	E