

13 12 11 10 9 8 7 6 5 4 3 2 1

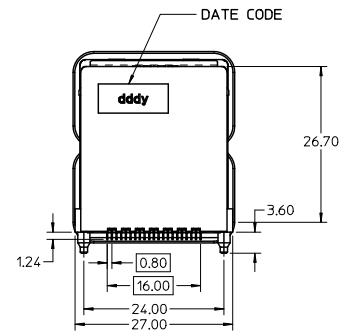
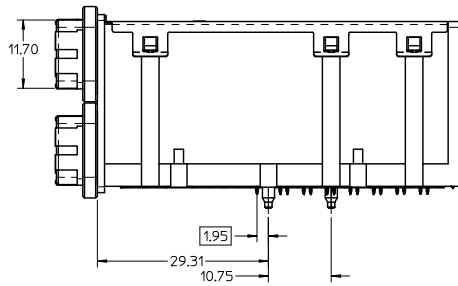
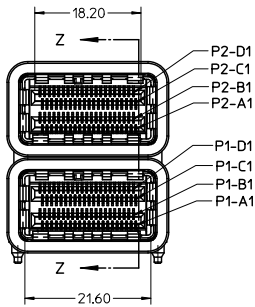
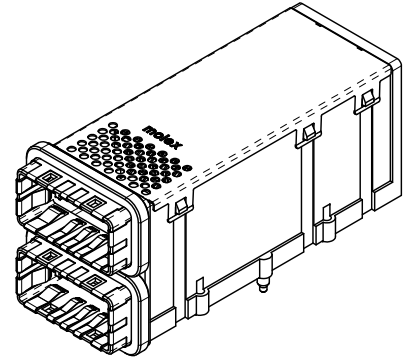
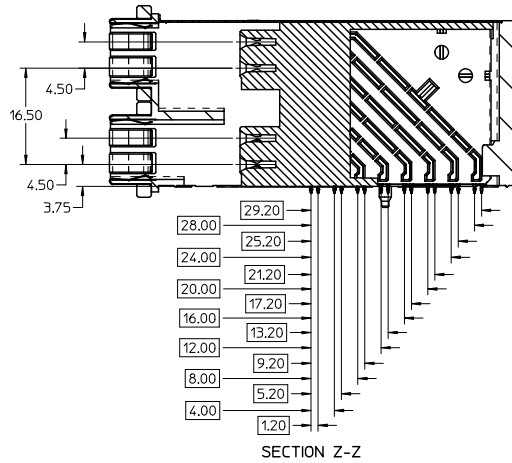
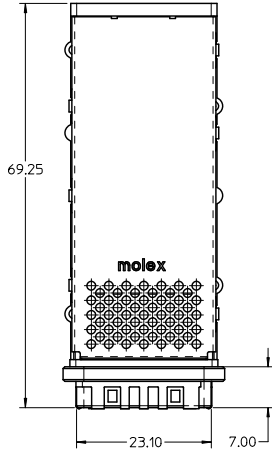

NOTES:

1. MATERIALS:
 CONNECTOR HOUSING: HIGH TEMPERATURE THERMOPLASTIC
 GLASS FILLED, UL94V-0
 COLOR: BLACK
 EMI HOUSING: DIE CAST ALLOY, NICKEL PLATED FINISH
 TERMINALS: COPPER ALLOY
 COVER: STAINLESS STEEL ALLOY
 EMI GASKET: CONDUCTIVE POLYMER

2. PLATING:
 CONTACT AREA: 0.76µm MIN. GOLD OVER 2.54µm MIN. NICKEL
 COMPLIANT AREA:
 OPTION 1: COMPLIANT AREA: 0.76-1.52µm TIN LEAD (90/10) OVER 1.27µm MIN. NICKEL
 OPTION 2: COMPLIANT AREA: 0.76-1.52µm TIN OVER 1.27µm MIN. NICKEL
 3. PACKAGING SPECIFICATION: TRAY PACK PER PK-76024-001
 4. MOUNTING HARDWARE: M2x8mm CAP SCREWS (NOT SUPPLIED)
 5. THIS CONNECTOR IS DESIGNED TO MATE WITH MOLEX CABLE SERIES 111025
 6. THIS CONNECTOR IS FOR PASSIVE COPPER CABLES ONLY
 NO OPTICAL MODULES OR ACTIVE COPPER CABLES

ITEM NUMBER	PLATING OPT.
76024-0568	OPTION 1
76024-0569	OPTION 2

TIN PLATING ADDED EC NO. UCP200-2782 DRAWN: K.LANG 20/06/08 CHKD: M.BANAKIS 20/07/12 APPR: M.BANAKIS 20/07/12	QUALITY SYMBOLS ◻=0 ▽=0	GENERAL TOLERANCES (UNLESS SPECIFIED):		DIMENSION STYLE MM ONLY		SCALE 2:1	DESIGN UNITS METRIC	THIRD ANGLE PROJECTION	
		4 PLACES ±--- ±---	mm	INCH	DRAWN BY K.LANG	DATE 2008/06/12	TITLE IPASS PLUS HSC 84/84 HIGH SPEED CHANNEL 0.8MM I/O		
		3 PLACES ±--- ±---	2 PLACES ±0.13 ±---	1 PLACE ±0.25 ±---	CHECKED BY	DATE	MOLEX INCORPORATED		
		ANGULAR ±1/2°			APPROVED BY M.BANAKIS	DATE 2008/07/12	DOCUMENT NO. SD-76024-568	SHEET NO. 1 OF 4	
DRAFT WHERE APPLICABLE MUST REMAIN WITHIN DIMENSIONS				SEE CHART		THIS DRAWING CONTAINS INFORMATION THAT IS PROPRIETARY TO MOLEX INCORPORATED AND SHOULD NOT BE USED WITHOUT WRITTEN PERMISSION			

12 11 10 9 8 7 6 5 4 3 2 1

RECOMMENDED PCB LAYOUT COMPONENT SIDE SHOWN

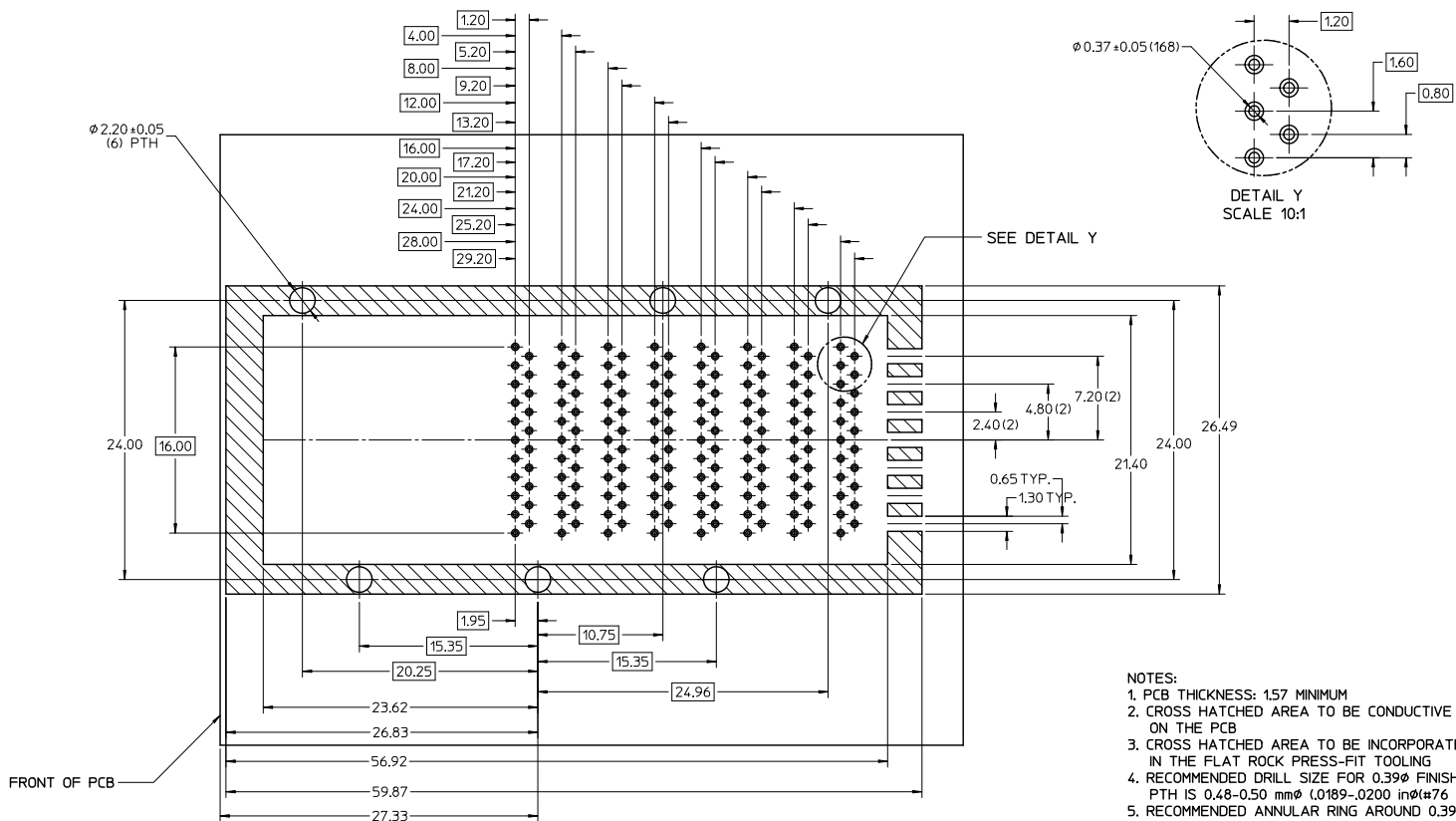

- NOTES:
1. PCB THICKNESS: 157 MINIMUM
 2. CROSS HATCHED AREA TO BE CONDUCTIVE ON THE PCB
 3. CROSS HATCHED AREA TO BE INCORPORATED IN THE FLAT ROCK PRESS-FIT TOOLING
 4. RECOMMENDED DRILL SIZE FOR 0.39 ϕ FINISHED PTH IS 0.48-0.50 mm ϕ (0.189-0.200 in ϕ (#76 DRILL))
 5. RECOMMENDED ANNULAR RING AROUND 0.39 ϕ FINISHED PTH IS 0.73 ϕ
 6. MINIMUM RECOMMENDED SPACING: 26.50mm

SEE SHEET 1 EC NO: UCP2010-2782 DRAWN BY: K.LANG CHKD: M.BANAKIS APPR: M.BANAKIS DATE: 2010/07/12 DATE: 2010/07/12	QUALITY SYMBOLS	GENERAL TOLERANCES (UNLESS SPECIFIED)		DIMENSION STYLE		SCALE	DESIGN UNITS	THIRD ANGLE PROJECTION	
		mm	INCH	MM ONLY		4:1	METRIC		
	$\nabla=0$	4 PLACES	±---	±---	DRAWN BY	DATE	TITLE		
	$\nabla=0$	3 PLACES	±---	±---	CHECKED BY	DATE	IPASS PLUS HSC 84/84 HIGH SPEED CHANNEL 0.8MM I/O		
	2 PLACES	±0.13	±---	APPROVED BY	DATE	MOLEX		MOLEX INCORPORATED	
	1 PLACE	±0.25	±---	MATERIAL NO.		DOCUMENT NO.		SHEET NO.	
	ANGULAR	±1/2°		SEE SHEET 1		SD-76024-568		2 OF 4	
DRAFT WHERE APPLICABLE MUST REMAIN WITHIN DIMENSIONS			THIS DRAWING CONTAINS INFORMATION THAT IS PROPRIETARY TO MOLEX INCORPORATED AND SHOULD NOT BE USED WITHOUT WRITTEN PERMISSION						

13 12 11 10 9 8 7 6 5 4 3 2 1

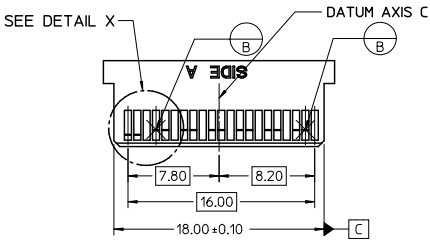
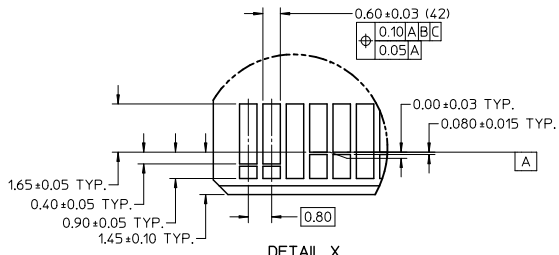
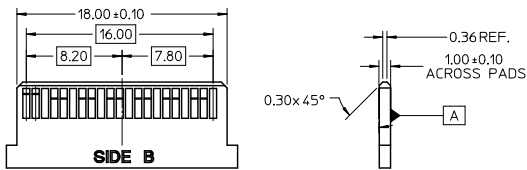

- NOTES:
 1. 0.03 MINIMUM KEEPOUT FOR SOLDER MASK AROUND ALL PADS
 2. DATUM B TARGETS ARE DEFINED BY THE RESPECTIVE PAD CENTER LINES AND THE LEADING EDGE OF THE TARGET PADS

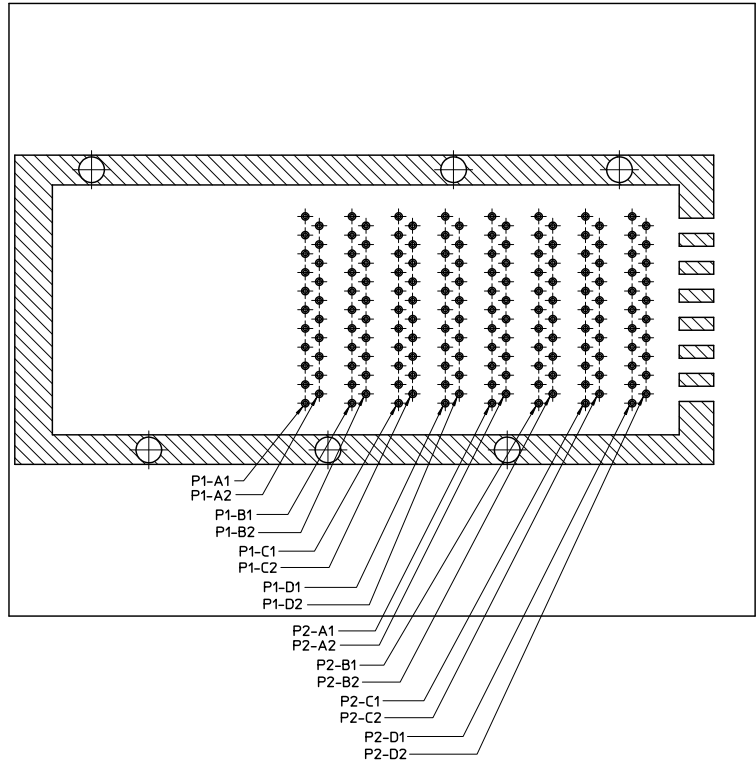

SEE SHEET 1 EC NO: UCP2010-2782 DRAWN BY: M. DRWNSKLANG CHKD: 2010/07/21 APPR: M. BANAKIS 2010/07/21	QUALITY SYMBOLS	GENERAL TOLERANCES (UNLESS SPECIFIED)		DIMENSION STYLE		SCALE	DESIGN UNITS	THIRD ANGLE PROJECTION		
	▽=0 ▽=0	4 PLACES	mm	INCH	MM ONLY	4:1	METRIC			
		3 PLACES	±---	±---	DRAWN BY: K. LANG	DATE: 2008/06/12	TITLE: IPASS PLUS HSC 84/84 HIGH SPEED CHANNEL 0.8MM I/O			
		2 PLACES	±0.13	±---	CHECKED BY:	DATE:	MATERIAL NO. MOLEX INCORPORATED			
	1 PLACE	±0.25	±---	APPROVED BY: M. BANAKIS	DATE: 2008/07/21	DOCUMENT NO. SD-76024-568				
		ANGULAR ±1/2°		SIZE SEE CHART		SHEET NO. 3 OF 4				
		DRAFT WHERE APPLICABLE MUST REMAIN WITHIN DIMENSIONS		THIS DRAWING CONTAINS INFORMATION THAT IS PROPRIETARY TO MOLEX INCORPORATED AND SHOULD NOT BE USED WITHOUT WRITTEN PERMISSION						

12 11 10 9 8 7 6 5 4 3 2 1

13 12 11 10 9 8 7 6 5 4 3 2 1

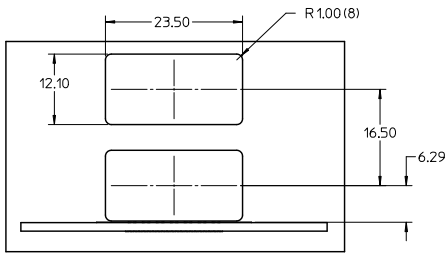
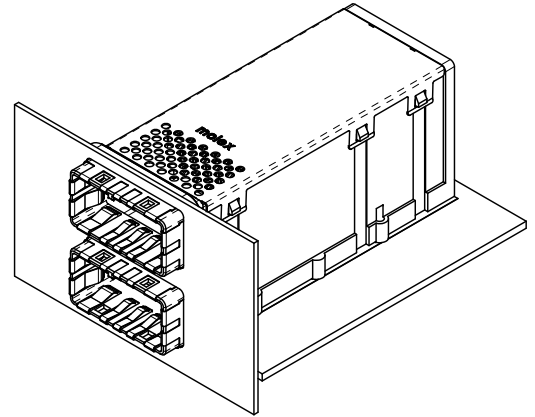

RECOMMENDED PANEL CUT-OUT

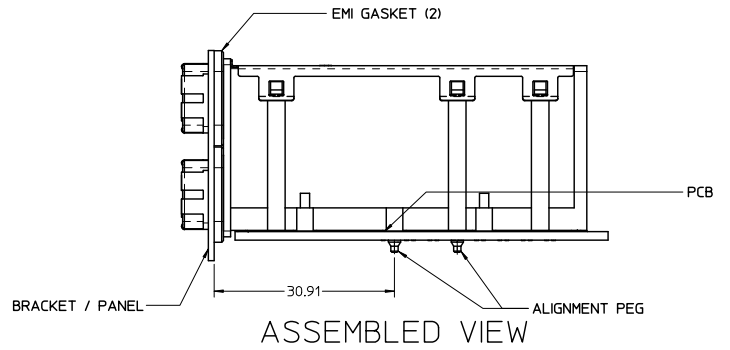

ASSEMBLED VIEW

SEE SHEET 1 EC NO: UCP2010-2782 M: DRINKLANG 2010/05/03 CHKD: 2010/07/21 APPR: MBANKIS 2010/07/21	QUALITY SYMBOLS ▽=0 ▽=0	GENERAL TOLERANCES (UNLESS SPECIFIED)		DIMENSION STYLE MM ONLY		SCALE 2:1	DESIGN UNITS METRIC	THIRD ANGLE PROJECTION	
		4 PLACES ±--- ±---	mm INCH	DRAWN BY K. LANG	DATE 2008/06/12	TITLE IPASS PLUS HSC 84/84 HIGH SPEED CHANNEL 0.8MM I/O			
		3 PLACES ±--- ±---		CHECKED BY	DATE	APPROVED BY M. BANKIS			
		2 PLACES ±0.13 ±--- 1 PLACE ±0.25 ±--- ANGULAR ±1/2°		MATERIAL NO. SEE SHEET 1	DATE 2008/07/21	MOLEX INCORPORATED		DOCUMENT NO. SD-76024-568	SHEET NO. 4 OF 4
DRAFT WHERE APPLICABLE MUST REMAIN WITHIN DIMENSIONS				THIS DRAWING CONTAINS INFORMATION THAT IS PROPRIETARY TO MOLEX INCORPORATED AND SHOULD NOT BE USED WITHOUT WRITTEN PERMISSION					

12 11 10 9 8 7 6 5 4 3 2 1