

REV	DATE	DESCRIPTION	BY	CHK	APP
F		REVISED PER ECO-09-011603	136600	BM	SS
G		REVISED PER ECR-07-025522	206201	LL	SF
H		REVISED PER ECR-09-000268	101000	AL	SF
J		REVISED PER ECR-09-015300	101000	AL	SF

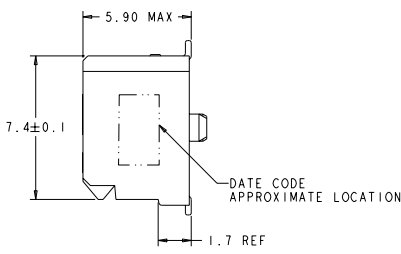

- PART COMPATIBLE WITH XFP MSA. REFER TO THE XFP MSA FOR DIMENSIONS NOT SHOWN ON THIS PRINT.
- HOUSING MATERIAL: HIGH TEMPERATURE LCP, UL 94V-0  
 COLOR WHITE  
 CONTACT MATERIAL: PHOSPHOR BRONZE
- CONTACTS: 0.00076 MIN GOLD IN CONTACT AREA, 0.00013 MIN GOLD ON SOLDER AREA, OVER 0.0038 MIN NICKEL UNDERPLATE ON ENTIRE CONTACT. LUBRICANT ON GOLD PLATE CONTACT AREAS.
- PACKAGED 480 PIECES PER REEL
- GROUND, POWER, AND SIGNAL PAD ARRANGEMENT TO BE DETERMINED BY CUSTOMER
- DATUMS AND BASIC DIMENSIONS TO BE ESTABLISHED BY CUSTOMER
- SOLDER MASK KEEP OUT AREA.
- PULL GROOVES PERMITTED ON THESE SURFACES AT MOLDING ENGINEERING DISCRETION

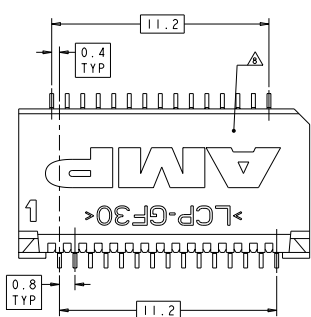
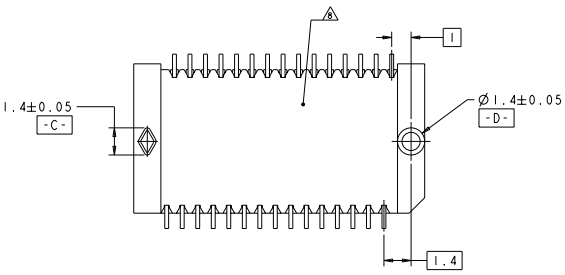
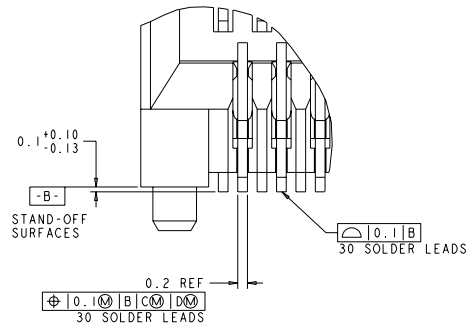
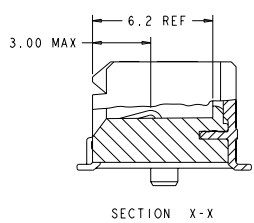
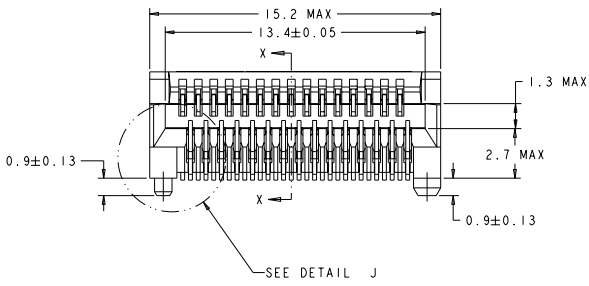

DETAIL J  
 SCALE 25:1

YES	1367500-2
NO	1367500-1
DATE CODE	PART NUMBER

DATE	17JAN07	REV	0000000000
DESIGNED BY	W. HULLSLEY	DESIGNED BY	W. HULLSLEY
DATE	108-1368	DATE	108-1368
PROJECT	136-1368	PROJECT	136-1368
REV	136-1368	REV	136-1368
DATE	136-1368	DATE	136-1368
BY	W. HULLSLEY	BY	W. HULLSLEY
CHKD		CHKD	
DATE		DATE	
APP'D		APP'D	
DATE		DATE	
CUSTOMER DRAWING		CUSTOMER DRAWING	

REVIS		REVISIONS			
NO	DATE	DESCRIPTION	BY	CHK	APP
00		SEE SHEET 1			

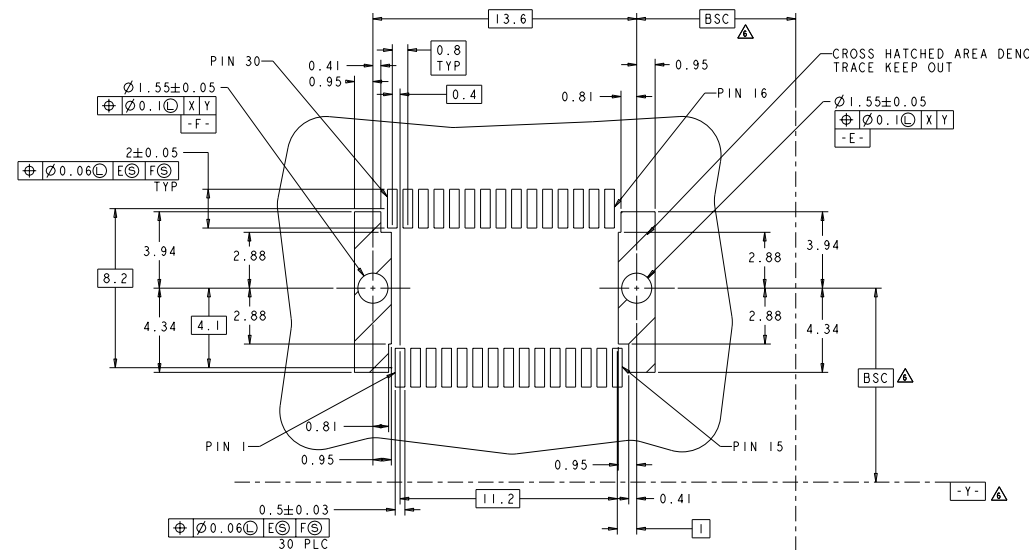

RECOMMENDED PCB CONFIGURATION

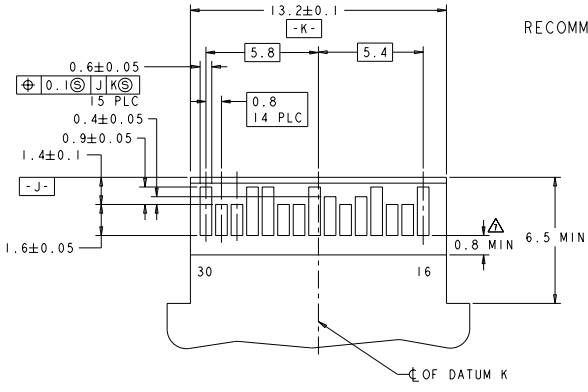

TOP VIEW

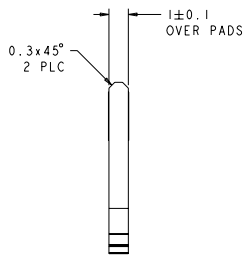

RECOMMENDED MATING PCB CONFIGURATION

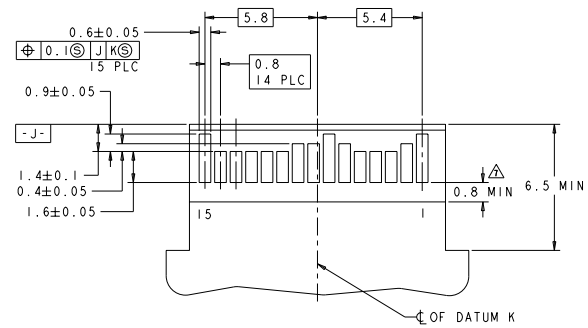

BOTTOM VIEW

PART NUMBER: 1367500 QUANTITY: 10000 DATE: 03/01/2017 DRAWN: J. BELLAMY CHECKED: J. BELLAMY APPROVED: J. BELLAMY		TITLE: PT CONNECTOR ASSEMBLY, ENHANCED PERFORMANCE, 30 POSITION XFP, 0.8MM PITCH PART NUMBER: 1367500 CUSTOMER DRAWING: A	DATE: 03/01/2017 DRAWN: J. BELLAMY CHECKED: J. BELLAMY APPROVED: J. BELLAMY PART NUMBER: 1367500 CUSTOMER DRAWING: A	SHEET: 10 OF: 23 DRAWN BY: J. BELLAMY
---	--	---	---	---

REVISOR		REVISIONS	
DATE	BY	DESCRIPTION	DATE
ES	00	SEE SHEET 1	

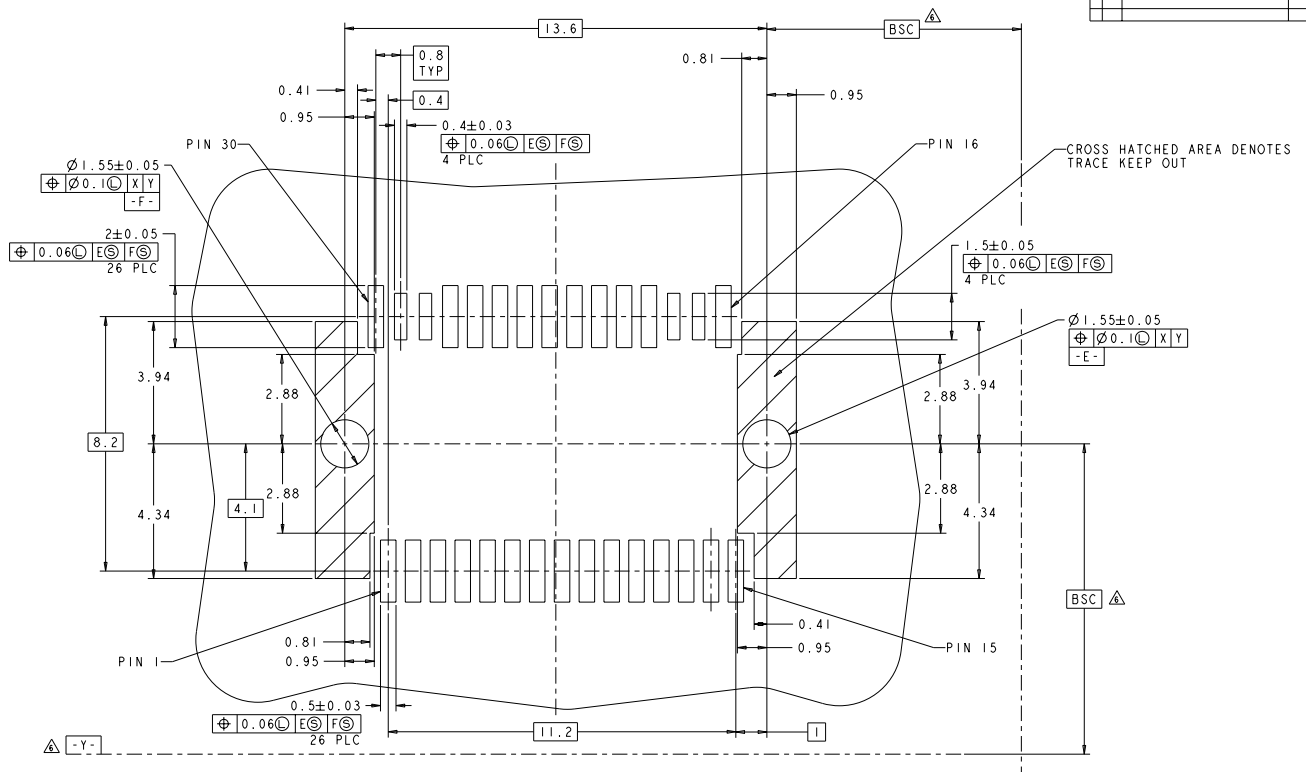

OPTIONAL LAYOUT FOR IMPROVED SIGNAL INTEGRITY, MOUNTING SIDE  
 SCALE: 16:1

DATE: 08/24/2016 REVISED FOR PUBLICATION BY: PACE ELECTRONICS CORPORATION. ALL RIGHTS RESERVED.	DATE: 08/24/2016 REVISED FOR PUBLICATION BY: PACE ELECTRONICS CORPORATION. ALL RIGHTS RESERVED.	DATE: 08/24/2016 REVISED FOR PUBLICATION BY: PACE ELECTRONICS CORPORATION. ALL RIGHTS RESERVED.	DATE: 08/24/2016 REVISED FOR PUBLICATION BY: PACE ELECTRONICS CORPORATION. ALL RIGHTS RESERVED.	DATE: 08/24/2016 REVISED FOR PUBLICATION BY: PACE ELECTRONICS CORPORATION. ALL RIGHTS RESERVED.
PART NUMBER: 1367500 QUANTITY: 10000 DATE: 08/24/2016 BY: PACE ELECTRONICS CORPORATION. ALL RIGHTS RESERVED.		PART NUMBER: 1367500 QUANTITY: 10000 DATE: 08/24/2016 BY: PACE ELECTRONICS CORPORATION. ALL RIGHTS RESERVED.		PART NUMBER: 1367500 QUANTITY: 10000 DATE: 08/24/2016 BY: PACE ELECTRONICS CORPORATION. ALL RIGHTS RESERVED.
PART NUMBER: 1367500 QUANTITY: 10000 DATE: 08/24/2016 BY: PACE ELECTRONICS CORPORATION. ALL RIGHTS RESERVED.		PART NUMBER: 1367500 QUANTITY: 10000 DATE: 08/24/2016 BY: PACE ELECTRONICS CORPORATION. ALL RIGHTS RESERVED.		PART NUMBER: 1367500 QUANTITY: 10000 DATE: 08/24/2016 BY: PACE ELECTRONICS CORPORATION. ALL RIGHTS RESERVED.