

REV.	REVISION CHANGES
X0	AS DRAWN
X1	CORRECTED DRAFTING

PART NO. 943-SP-370808SM2-A411

CAT 5 8 X 8 SHIELDED PLUG
 CONSISTING OF:

PRE-INSERTED FRONT & SHIELD ASSY. - P.N. 943-SP-370808-FS
 MANAGEMENT BAR P.N. 370808M2-MB-A380
 FERRULE P.N. F-235-205L

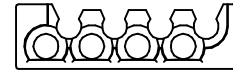

MANAGEMENT BAR

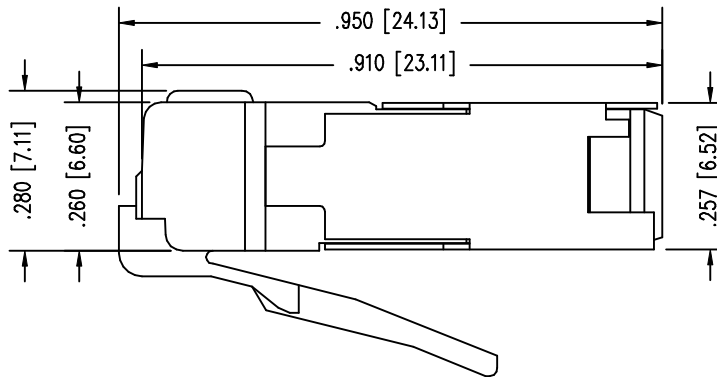
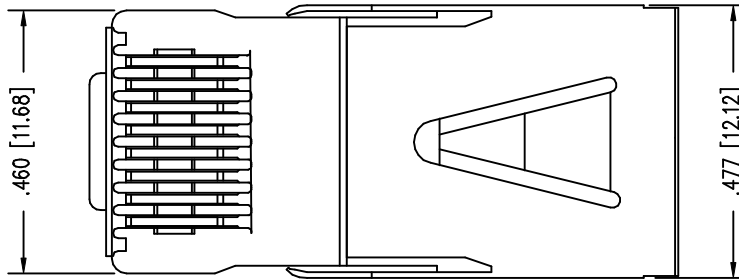

NOTES:

- TOLERANCES COMPLY WITH F.C.C. DIMENSION REQUIREMENTS.
- DIMENSIONS SHOWN WITH "*" TO BE CENTRAL ABOUT CENTER LINE.
- DIMENSIONS SHOWN ARE SUBJECT TO CHANGE WITHOUT NOTICE.

THIRD ANGLE PROJECTION

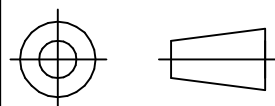

THIS DRAWING AND THE SUBJECT MATTER SHOWN THEREON ARE CONFIDENTIAL AND THE PROPRIETARY PROPERTY OF STEWART CONNECTOR ("SCS") AND SHALL NOT BE REPRODUCED, COPIED OR USED IN ANY MANNER WITHOUT PRIOR WRITTEN CONSENT OF "SCS". THE SUBJECT MATTER MAY BE PATENTED OR A PATENT MAY BE PENDING. © SCS