

THE INFORMATION CONTAINED HEREIN IS CONSIDERED 'PROPRIETARY' TO BEL FUSE INC. AND SHALL NOT BE COPIED, REPRODUCED OR DISCLOSED WITHOUT THE WRITTEN APPROVAL OF BEL FUSE INC.



ELECTRICAL CHARACTERISTICS @ 25°C

<p> <b>URNS RATIO</b>  <b>DCL @ 0.1V, 100KHz</b>          8mA DC BIAS  <b>INSERTION LOSS</b>          100KHz TO 100MHz  <b>RETURN LOSS (MIN.)</b>          2MHz-30MHz          60MHz-80MHz  <b>D.C. RESISTANCE</b>          (9-8)=(7-6)          (RJ1-RJ2)=(RJ3-RJ6)  <b>INTERWINDING CAPACITANCE</b>          PER CHANNEL (PRI. to SEC.)  <b>XTALK</b>          100KHz TO 100MHz  <b>HIPOT (Isolation Voltage):</b>          100% OF PRODUCTION TESTED TO COMPLY          WITH IEEE 802.3 ISOLATION REQUIREMENT  <b>BALANCED DC LINE CURRENT</b> </p>	<p>           1CT : 1CT ±2%            350µ H MIN.            -1.5 dB MAX.            -16 dB MIN.            -10 dB MIN.            1.40 OHM MAX.            1.0 OHM MAX.            40 pF MAX.            -30 dB MIN.            2250 VDC            350 mA MAX. @ 57 VDC CONTINUOUS            500 mA MAX. @ 57 VDC FOR 200 MILLISECONDS         </p>
--	---

SCHEMATIC

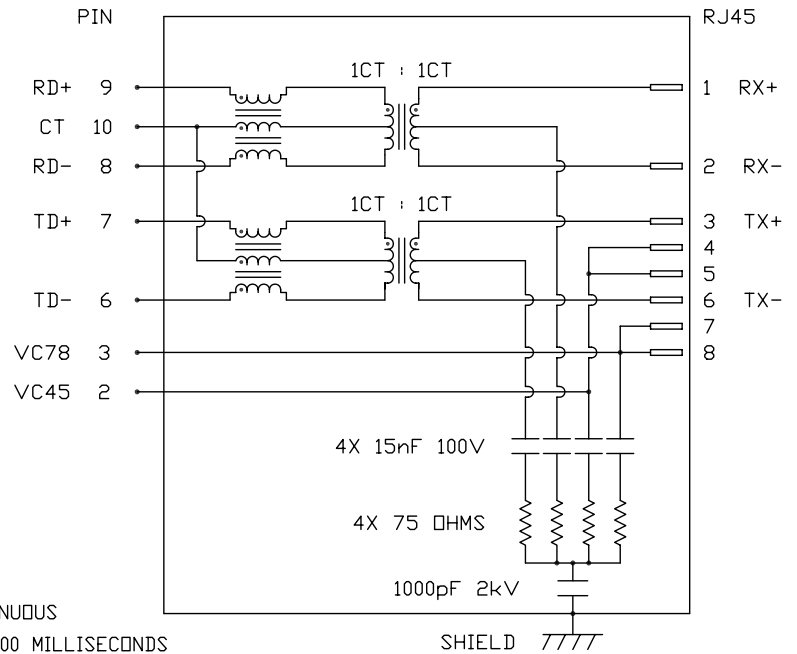

<b>ORIGINATED BY</b>	<b>DATE</b>	<b>TITLE</b> 2X6 Stacked MagJack® FOR 10/100 POE 0833-2X6R-59-F PATENTED	<b>PART NO. / DRAWING NO.</b>	<b>STANDARD DIM. TOL. IN INCH</b>	<b>[ ] METRIC DIM. AS REFERENCE</b>		
CHOW WANGCHUNG	10-14-09		08332X6R59-F		UNIT : INCH [mm]	REV. : A	
<b>DRAWN BY</b>	<b>DATE</b>		<b>FILE NAME</b>	.X .XX .XXX	SCALE : N/A	SIZE : A4	
LEE WEIDE	10-14-09		08332X6R59-F_A.DWG		SCALE : N/A	SIZE : A4	

DC002(2)051509 This document is electronically generated. This is a controlled copy if used internally

THE INFORMATION CONTAINED HEREIN IS CONSIDERED "PROPRIETARY" TO BEL FUSE INC. AND SHALL NOT BE COPIED, REPRODUCED OR DISCLOSED WITHOUT THE WRITTEN APPROVAL OF BEL FUSE INC.

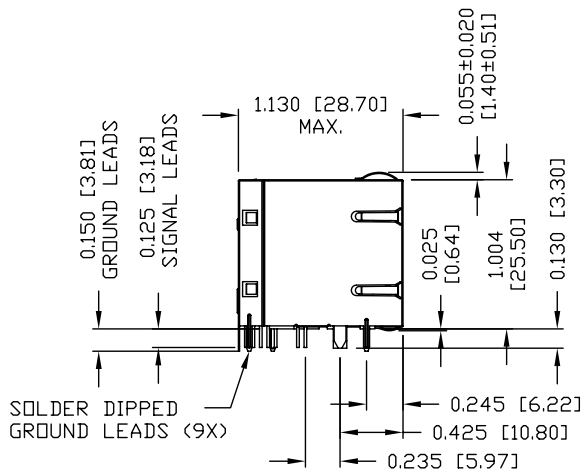

**NOTES:**

- PLASTIC HOUSING: THERMOPLASTIC PBT  
FLAMMABILITY RATING UL 94V-0
- CONTACT PLATING: 50 MICRO-INCH HARD GOLD PLATING
- OUTPUT PINS: TIN-COATED COPPER WIRE, DIA 0.018 INCH.
- METAL SHIELD: NICKEL PLATED ON COPPER ALLOY.  
(ALL GROUND LEADS ARE SOLDER DIPPED)

- [1] JACK CAVITY CONFORMS TO FCC RULES AND REGULATIONS, PART 68 SUBPART F.
- [2] MARK PART WITH MFG LOGO, MFG NAME, PART NUMBER, DATE CODE AND PATENTED.
- 3. RoHS COMPLIANCE, PER EU DIRECTIVE 2002/95/EC.

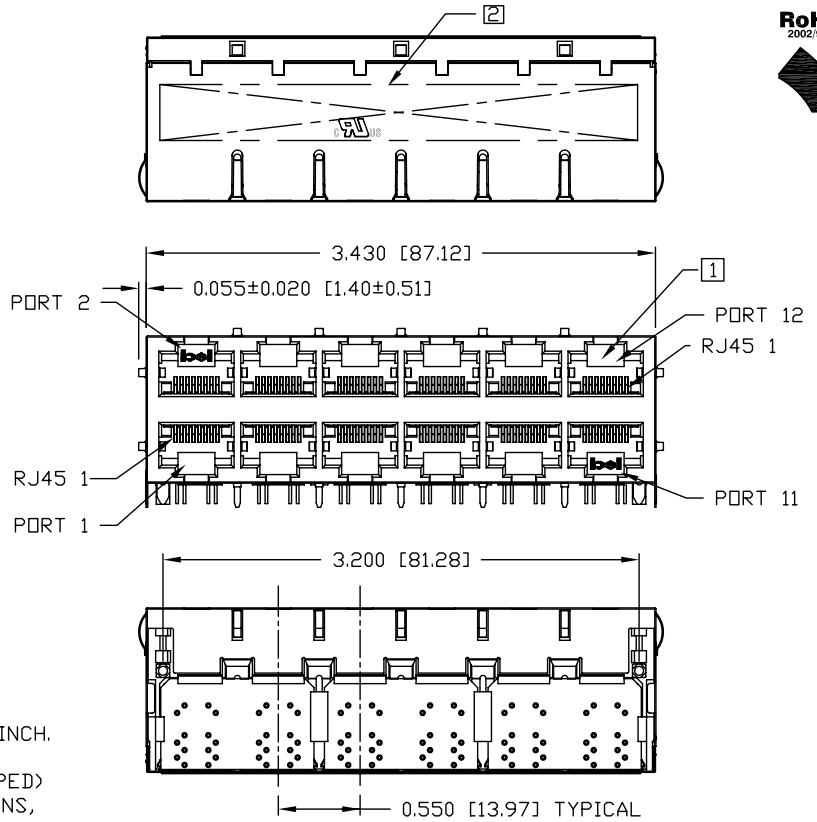

**UL** UL RECOGNIZED - FILE #E196366 AND E169987.  
4. THE PRODUCT IS PATENTED, THE PATENT NUMBER IS U.S. PAT. 5,736,910.

ORIGINATED BY	DATE	TITLE	PART NO. / DRAWING NO.	STANDARD DIM. TOL. IN INCH	[ ] METRIC DIM. AS REFERENCE
LIU QIN	10-14-09	2X6 Stacked MagJack® FOR 10/100 POE 0833-2X6R-59-F PATENTED	08332X6R59-F	.X	UNIT : INCH [mm] REV. : A
DRAWN BY	DATE		FILE NAME	.XX	SCALE : N/A SIZE : A4
XIAN JIAXIN	10-14-09		08332X6R59-F_A.DWG	.XXX ±0.010	PAGE : 3



THE INFORMATION CONTAINED HEREIN IS CONSIDERED 'PROPRIETARY' TO BEL FUSE INC. AND SHALL NOT BE COPIED, REPRODUCED OR DISCLOSED WITHOUT THE WRITTEN APPROVAL OF BEL FUSE INC.

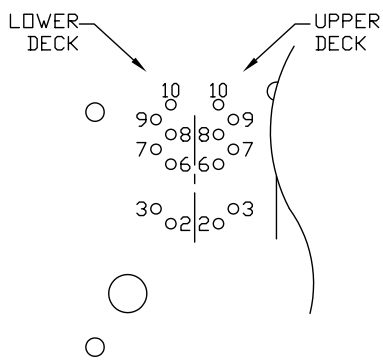

PIN-OUT INFORMATION  
(COMPONENT SIDE VIEW)

10	COMMON CT
9	RD+
8	RD-
7	TD+
6	TD-
5	NO PIN
4	NO PIN
3	VC78
2	VC45
1	NO PIN

UNUSED PIN LOCATIONS MUST BE REMOVED TO ENSURE 2KV ISOLATION.

PORT ASSIGNMENT (COMPONENT SIDE VIEW)

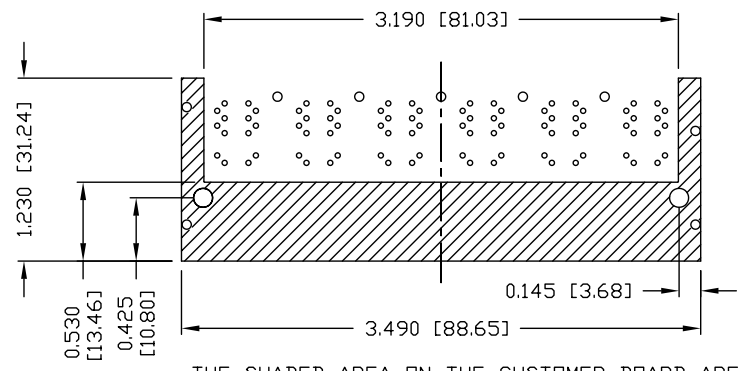
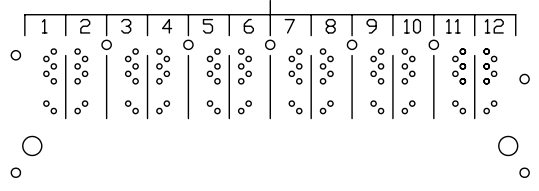

THE SHADED AREA ON THE CUSTOMER BOARD ARE RECOMMENDED TO BE CLEAR OFF ANY VIA HOLE OR COMPONENT PAD.

ORIGINATED BY LIU QIN	DATE 10-14-09	TITLE 2X6 Stacked MagJack® FOR 10/100 PDE 0833-2X6R-59-F PATENTED	PART NO. / DRAWING NO. 08332X6R59-F	STANDARD DIM. TOL. IN INCH	[ ] METRIC DIM. AS REFERENCE	bel COMPONENTS CONNECTION PLATE
	DRAWN BY XIAN JIAXIN		DATE 10-14-09	FILE NAME 08332X6R59-F_A.DWG	.X .XX .XXX ±0.004	

DC002(2)051509

This document is electronically generated. This is a controlled copy if used internally

THE INFORMATION CONTAINED HEREIN IS CONSIDERED 'PROPRIETARY' TO BEL FUSE INC. AND SHALL NOT BE COPIED, REPRODUCED OR DISCLOSED WITHOUT THE WRITTEN APPROVAL OF BEL FUSE INC.

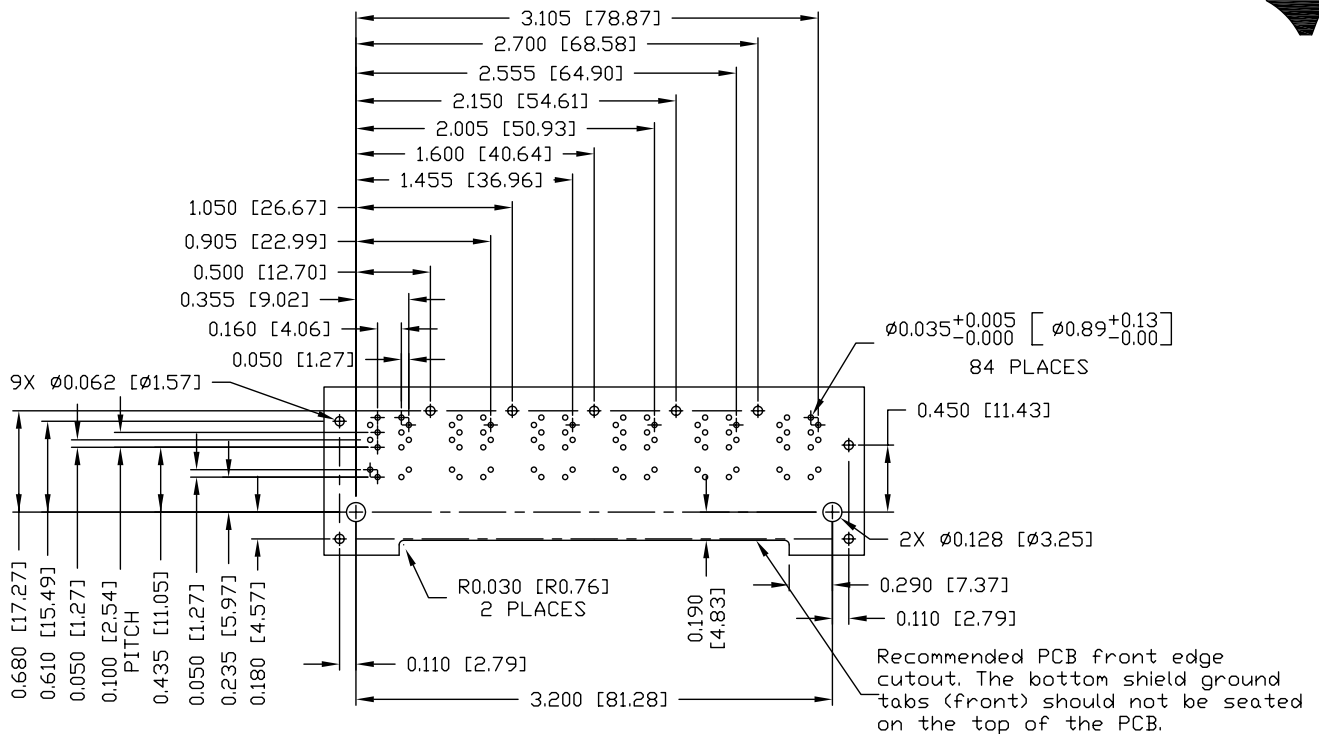

SUGGESTED PCB FOOTPRINT  
(COMPONENT SIDE VIEW)

<b>ORIGINATED BY</b> LIU QIN	<b>DATE</b> 10-14-09	<b>TITLE</b> 2X6 Stacked MagJack® FOR 10/100 POE 0833-2X6R-59-F PATENTED	<b>PART NO. / DRAWING NO.</b> 08332X6R59-F	<b>STANDARD DIM. TOL. IN INCH</b>	<b>[ ] METRIC DIM. AS REFERENCE</b>	<b>bel</b> COMPONENTS CONNECTED PLANET
<b>DRAWN BY</b> XIAN JIAXIN	<b>DATE</b> 10-14-09		<b>FILE NAME</b> 08332X6R59-F_A.DWG	.X .XX .XXX ±0.004	UNIT : INCH [mm] SCALE : N/A PAGE : 5	

DC002(2)051509 This document is electronically generated. This is a controlled copy if used internally

THE INFORMATION CONTAINED HEREIN IS CONSIDERED "PROPRIETARY" TO BEL FUSE INC. AND SHALL NOT BE COPIED, REPRODUCED OR DISCLOSED WITHOUT THE WRITTEN APPROVAL OF BEL FUSE INC.



SUGGESTED PANEL OPENING

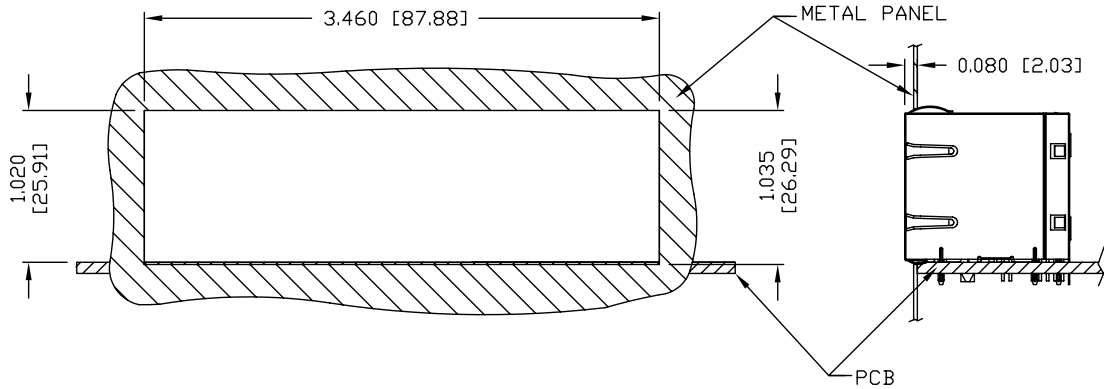

NOTE:

THE DISTANCE OF PANEL INSIDE SURFACE RELATIVE TO FRONT SURFACE OF PART IS ONLY A SUGGESTION. IN CASE THIS DISTANCE IS DIFFERENT, THE REQUIRED PANEL OPENING DIMENSIONS CHANGE ACCORDINGLY.

PACKING INFORMATION

PACKING TRAY : 0200-9999-A9 (TOP)  
0200-9999-A8 (BOTTOM)

PACKING QUANTITY : 15 PCS FINISHED GOODS PER TRAY  
7 TRAYS (105 PCS FINISHED GOODS) PER CARTON BOX

NOTE : CARDBOARDS ARE PLACED BETWEEN LAYERS OF PACKING TRAY INSIDE CARTON BOX (INCLUDE THE UPPERMOST AND LOWERMOST TRAY)

ORIGINATED BY LIU QIN	DATE 10-14-09	TITLE 2X6 Stacked MagJack® FOR 10/100 POE 0833-2X6R-59-F PATENTED	PART NO. / DRAWING NO. 08332X6R59-F	STANDARD DIM.	[ ] METRIC DIM. AS REFERENCE	UNIT : INCH [mm]	REV. : A	bel
				TOL. IN INCH				
DRAWN BY XIAN JIAXIN	DATE 10-14-09		FILE NAME 08332X6R59-F_A.DWG	.X .XX .XXX			PAGE : 6	COMPONENTS CONNECTED PLANNED

DC002(2)051509 This document is electronically generated. This is a controlled copy if used internally