

MECHANICAL:

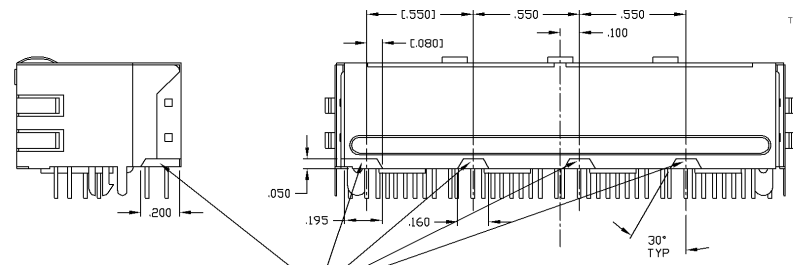

NOTCHES IN THE REAR SIDE OF SHIELD ONLY PRESENT AT 6610023-1 & 1-6610023-1

- 1 MATERIALS:
 - HOUSING - THERMOPLASTIC PET POLYESTER FLAMMABILITY RATING UL 94V-0
 - SHIELD - 0.010" THICK, C28800 BRASS PREPLATED WITH 30µINCH MIN SEMI-BRIGHT NICKEL
 - SOLDER TABS POST DIPPED WITH 100µINCH MIN SAC SOLDER
 - MOD JACK CONTACTS - 0.0157" X 0.018" PHOSPHOR BRONZE, 50µINCH MIN OVERALL NICKEL UNDERPLATE WITH SELECT 50µINCH MIN HARD GOLD FINISH PLATE. SOLDER TAILS WITH 100µINCH MIN MATTE TIN AND/OR SAC SOLDER DIP
 - LIGHT EMITTING DIODE(LED) - DIFFUSED EPOXY LENS, 0.020" X 0.020" CARBON STEEL WIREFRAME LEADS PRE-PLATED WITH 80µINCH SILVER OVER 40µINCH NICKEL UNDERPLATE OVER 40µINCH COPPER UNDERPLATE. POST-PLATED WITH 100µINCH MIN MATTE TIN AND/OR SAC SOLDER DIP OR PURE TIN SOLDER DIP
- 2 RJ45 JACK CAVITY CONFORMS TO FCC RULES AND REGULATIONS PART 68, SUB PART F.
- 3 MAGNETICS
 - IMPEDANCE: 100 OHMS
 - TURNS RATIO (EHP-CABLE): TX = 11, RX = 11
 - OPEN CIRCUIT INDUCTANCE (OCL): 350µH MIN @ 100MHz, 0.1VRMS
 - BIAS: BIAS FROM -40°C TO +85°C, TX AND RX
 - PERFORMANCE @ 25°C
 - INSERTION LOSS (IL): 1.1dB MAX FROM 0.5MHz TO 100MHz
 - RETURN LOSS (RL): 18dB MIN FROM 0.5MHz TO 30MHz
 - 18-20LOG(f/30)dB MIN FROM 30.1MHz TO 60MHz
 - 12dB MIN FROM 60.1MHz TO 80MHz
 - CROSSTALK ATTENUATION: 35dB MIN FROM 0.5MHz TO 40MHz
 - 33-20LOG(f/50)dB MIN FROM 4.0MHz TO 100MHz
 - COMMON MODE REJECTION RATIO (CMRR): 30dB MIN FROM 0.5MHz TO 100MHz
 - ISOLATION VOLTAGE: COMPLIES WITH IEEE802.3 2002, PARA 23.5.1.1, ITEM b.
- 4 OPERATING TEMPERATURE: FROM -40°C TO +85°C.
- 5 THE LED WITH 250 OHM RESISTORS LED IS DRIVEN WITH 5V VOLTAGE AND THE MAX OPERATING CURRENT IS 20mA
 - LED COLOR DOMINANT WAVELENGTH(GREEN) 568nm TYP. AT VF=5V
 - FORWARD CURRENT (IF): GREEN 12 mA TYP. AT VF=5V
 - DOMINANT WAVELENGTH (RED) YELLOW 588nm TYP. AT VF=5V
 - FORWARD CURRENT (IF): YELLOW 13 mA TYP. AT VF=5V
- 6 INDICATED CONNECTIONS ARE FOR NIC CONFIGURATION. THE MAGNETICS ARE SYMMETRICAL AND SUPPORT AUTO-MDI/MDIX.
- 7 TYCO ELECTRONICS LOGO, PART NUMBER, DATE CODE, COUNTRY OF ORIGIN AND AGENCY APPROVAL MARKING IN APPROXIMATE LOCATION SHOWN.
- 8 THESE PARTS ARE RECOMMENDED FOR WAVE SOLDERING PROCESS, PEAK WAVE SOLDERING TEMPERATURE IS 265°C MAX, 10 SECONDS MAX.

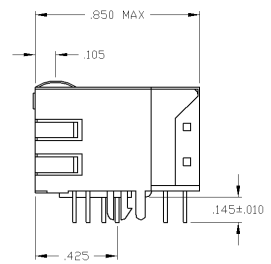
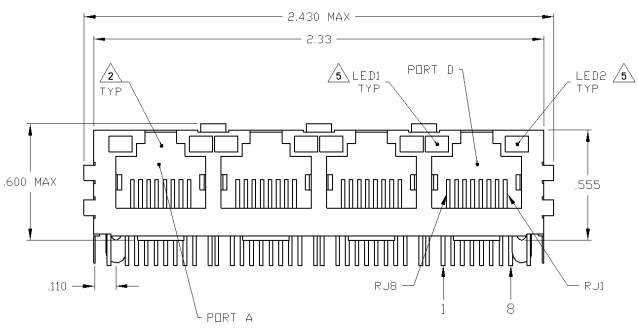
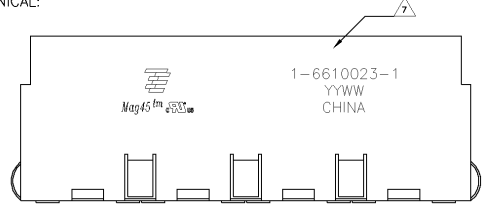
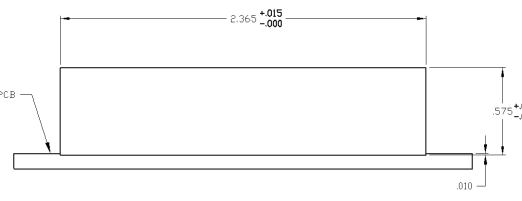

1X4 SUGGESTED PANEL CUTOUT

NO	YES	GREEN	YELLOW	5-6610023-1
NO	YES	GREEN	GREEN	6-6610023-1
YES	NO	GREEN	GREEN	1-6610023-1
YES	NO	GREEN	YELLOW	6610023-1

5 NOTCHES IN SHIELD 2KV DECOUPLING CAPACITOR LED1 LED2 PART NUMBER

THIS DRAWING IS A CONTROLLED DOCUMENT. IT SHALL BE CONTROLLED BY THE DRAWING OFFICE.

DATE	REV	DESCRIPTION	BY	CHKD.
08/01/04	1	ISSUE		
08/01/04	2	REVISED TO ADD 2KV DECOUPLING CAPACITOR		

INDUSTRIAL TEMP SCHEMATIC, 26 SERIES CIRCUIT, SHIELDED, WITH RESISTOR LEADS

SEE: SEE SEE DRAWING NO. 100779

CUSTOMER DRAWING

SCALE: 4:1

SHEET: 1 OF 2

