

NOTES:
 1. MATERIAL:
 METAL SHELL: BRASS
 HOUSING: POLYAMIDE, GLASS FIBER FILLED, UL94V-0, COLOR: BLACK
 INSERT: POLYAMIDE, GLASS FIBER FILLED, UL94V-0, COLOR: BLACK
 TERMINAL: PHOSPHOR BRONZE
 2. PLATING:
 TERMINAL:
 CONTACT AREA: GOLD(Au), THICKNESS=30 MICROINCH MINIMUM.
 SOLDER TAIL: TIN(Sn) PLATED, THICKNESS=100 MICROINCH MINIMUM.
 UNDER PLATE: NICKEL (Ni) PLATED.
 METAL SHELL:
 NICKEL (Ni) PLATED OVERALL, THICKNESS=50 MICROINCH MINIMUM.
 SURFACE APPEARANCE: BRIGHT.
 SOLDER AREA: IMMERSIVE TIN(Sn), THICKNESS=100 MICROINCH MINIMUM.
 3. FOR IR REFLOW APPLICATION.
 4. RECOMMENDED PCB THICKNESS: 1.60±0.05
 5. PRODUCT SPECIFICATION REFER TO PS-48074-002.
 6. TEST SUMMARY REFER TO TS-48074-002.
 7. PACKAGING SPECIFICATION REFER TO PK-48074-001.
 8. RETENTION FORCE: 30 lbf.
 9. COPLANARITY: 0.10mm MAX.
 10. LEAD FREE AND RoHS COMPLIANT PRODUCT.

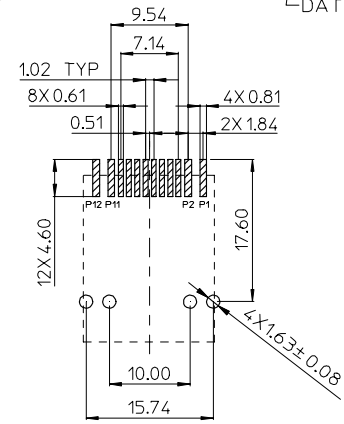

RECOMMENDED P.C.B LAYOUT

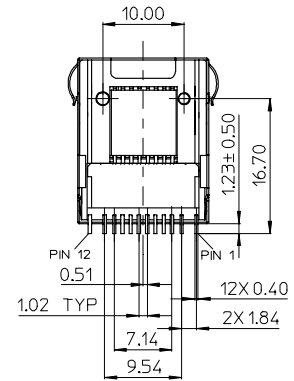
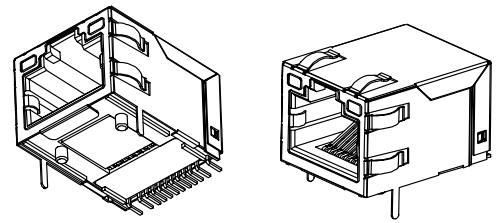

RoHS FOR 48074-0001 EC NO: SH2007-0130 DRW:ALLIN CHYD: APPR:WMSCHANG	DESCRIPTION REV	QUALITY SYMBOLS	GENERAL TOLERANCES (UNLESS SPECIFIED) <table border="1"> <thead> <tr> <th></th> <th>mm</th> <th>INCH</th> </tr> </thead> <tbody> <tr> <td>4 PLACES</td> <td>±---</td> <td>±---</td> </tr> <tr> <td>3 PLACES</td> <td>±---</td> <td>±---</td> </tr> <tr> <td>2 PLACES</td> <td>±0.25</td> <td>±---</td> </tr> <tr> <td>1 PLACE</td> <td>±0.25</td> <td>±---</td> </tr> <tr> <td colspan="3">ANGULAR ± 3 °</td> </tr> </tbody> </table>		mm	INCH	4 PLACES	±---	±---	3 PLACES	±---	±---	2 PLACES	±0.25	±---	1 PLACE	±0.25	±---	ANGULAR ± 3 °			DIMENSION STYLE	SCALE	DESIGN UNITS	THIRD ANGLE PROJECTION
				mm	INCH																				
		4 PLACES		±---	±---																				
		3 PLACES		±---	±---																				
2 PLACES	±0.25	±---																							
1 PLACE	±0.25	±---																							
ANGULAR ± 3 °																									
			MM ONLY	1:1	METRIC																				
			DRAWN BY	DATE	TITLE																				
			LINDA	2006/08/08	MODULAR JACK WITH LED & INTEGRATED MAGNETICS SMT TYPE																				
			CHECKED BY	DATE	MOTEX MOLEX INCORPORATED																				
			ALLEN LIN	2006/08/10																					
			APPROVED BY	DATE																					
			ERICK LAN	2006/08/10																					
			MATERIAL NO.	DOCUMENT NO.																					
			48074-9001	SD-48074-002																					
			SIZE	THIS DRAWING CONTAINS INFORMATION THAT IS PROPRIETARY TO MOLEX INCORPORATED AND SHOULD NOT BE USED WITHOUT WRITTEN PERMISSION																					
			A4	SHEET NO. 1 OF 2																					

7 6 5 4 3 2 1

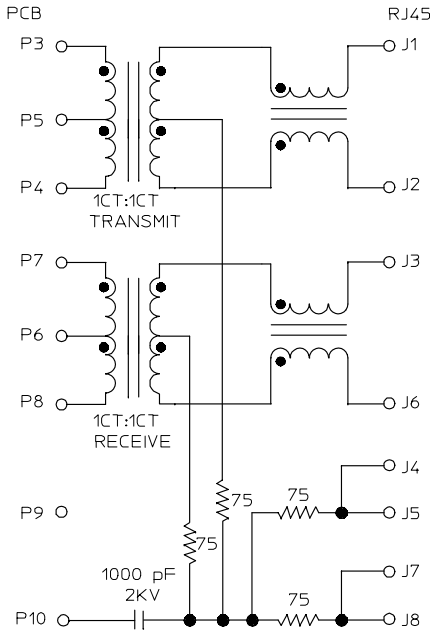

MAGNETIC ELECTRICAL SPECIFICATION

PARAMETER	SPECIFICATIONS		
	100 KHz		
INSERTION LOSS	1.0 dB MAX.		
RETURN LOSS (Z OUT=100 OHM±15%)	1-10 MHz	30 MHz	60-80 MHz
	20 dB MIN	16 dB MIN	12 dB MIN
CROSSTALK	1-10 MHz	30-60 MHz	60-100 MHz
	40 dB MIN	35 dB MIN	30 dB MIN
COMMON MODE REJECTION RATIO	1-50 MHz	50-130 MHz	
	30 dB MIN	20 dB MIN	
HIPOT	@60 Hz, 1 MIN		
	1500 Vrms		

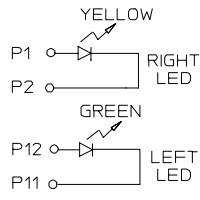

LED SCHEMATIC

LED ELECTRICAL SPECIFICATION

PARAMETER	YELLOW (TYP.)	GREEN (TYP.)	UNITS	TEST CONDITIONS
POWER DISSIPATION	105	105	mW	
REVERSE VOLTAGE	5	5	V	
PEAK WAVELENGTH	590	565	nm	I _F =20mA
FORWARD VOLTAGE	2.1 MAX.=2.5	2.2 MAX.=2.5	V	I _F =20mA

E
D
C
B
A

E
D
C
B
A

SEE SHEET 1 EC NO: SH2007-0130 DRWN:ALLIN CHYD: APPR:WMSCHANG 2006/10/04 2006/10/04 2006/10/04	QUALITY SYMBOLS ▽=0 ▽=0	GENERAL TOLERANCES (UNLESS SPECIFIED)		DIMENSION STYLE MM ONLY	SCALE 1:1	DESIGN UNITS METRIC	THIRD ANGLE PROJECTION		
		4 PLACES ±--- ±---	3 PLACES ±--- ±---	2 PLACES ±0.25 ±---	1 PLACE ±0.25 ±---	ANGULAR ± 3°	DRAFT WHERE APPLICABLE MUST REMAIN WITHIN DIMENSIONS		
		DRAWN BY LINDA	DATE 2006/08/08	CHECKED BY ALLEN LIN	DATE 2006/08/10	APPROVED BY ERICK LAN	DATE 2006/08/10	TITLE MODULAR JACK WITH LED & INTEGRATED MAGNETICS SMT TYPE	
		MATERIAL NO. 48074-9001	DOCUMENT NO. SD-48074-002	MOLEX INCORPORATED		SHEET NO. 2 OF 2			

fb_frame_A4_P_AM_T
Rev. D 2004/06/28

6 5 4 3 2 1