

| PART NUMBER | VERSION | PRODUCT SPECIFICATION | PLATING |
|-------------|--------------------|-----------------------|---------|
| 95040-2881 | STANDARD | PS 95040 | 2 |
| 95040-2889 | HIGH TEMPERATURE | PS-95040-688 | 2 |
| 95040-4881 | HIGH MATING CYCLES | PS-95040-001 | 7 |

NOTES:

1- MATERIAL :

HOUSING : POLYAMIDE 4/6 GLASS FILLED UL 94V0. COLOUR: BLACK
89992-0008

TERMINAL : PHOSPHOR BRONZE PLATED WITH :

PLATING 2 : 0.00127/.000050 MIN GOLD IN CONTACT AREA,
0.00190/.000075 MIN TIN IN TAIL AREA,
BOTH OVER 0.00127/.000050 MIN NICKEL OVERALL
PLATING 7 : POST PLATE 0.00005/.000002 MIN GOLD OVER 0.00076/.000030 MIN
PALLADIUM NICKEL IN CONTACT AREA 0.00190/.000075 MIN
TIN IN TAIL AREA BOTH OVER 0.00127/.000050 MIN NICKEL OVERALL.

SHIELD : BRASS PLATED WITH 0.0020/.000078 MIN. TIN

2- P.C. BOARD THICKNESS : 1.57/.062 ±0.15/.006

3- JACK FOR MATING WITH F.C.C. 68 PLUGS
95043 MOLEX SERIES.

4- PRODUCT SPECIFICATION: SEE CHART

5- APPLICATION SPECIFICATION: MOLEX AS-95001

6- PACKAGING SPECIFICATION: MOLEX PK-95040

7- LOGO MAY BE MXF, MG OR MXI

SEE NOTE 7

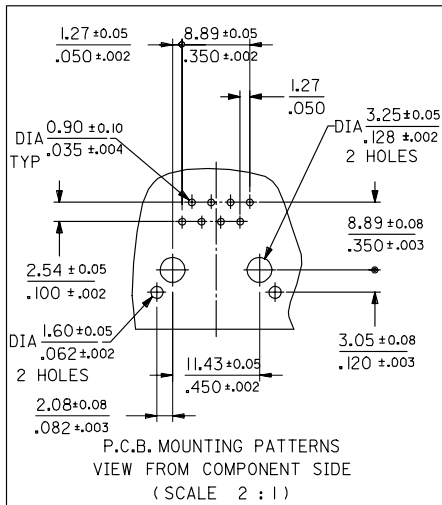
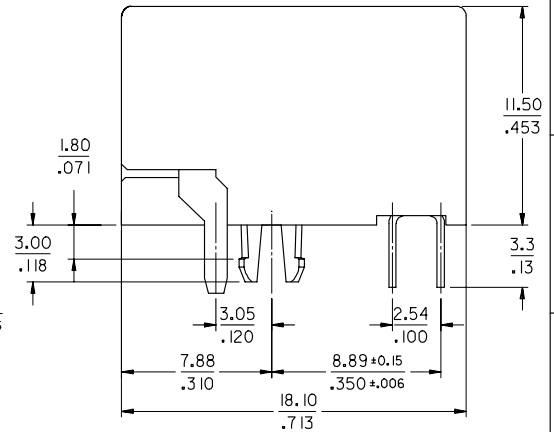
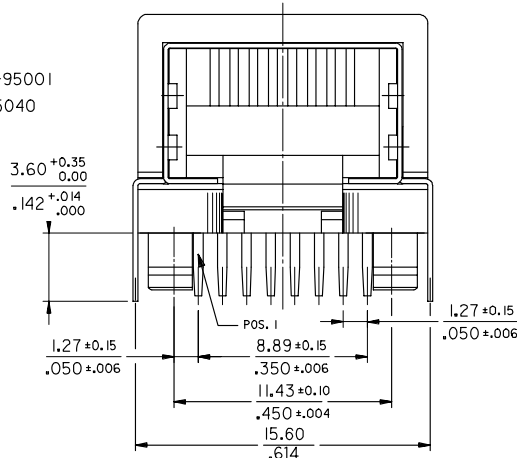
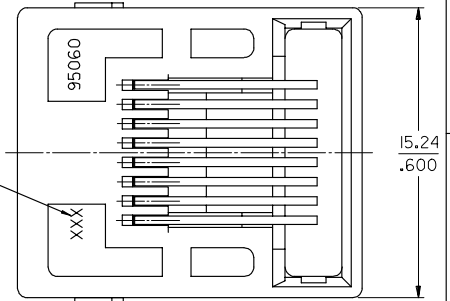

| REV | DESCRIPTION | QUALITY SYMBOLS | GENERAL TOLERANCES (UNLESS SPECIFIED) | | DIMENSION STYLE | SCALE | DESIGN UNITS | THIRD ANGLE PROJECTION |
|-----|---------------------|-----------------|---------------------------------------|------|-----------------|---|--------------------|---|
| | | | mm | INCH | MM/IN | 5:1 | METRIC | |
| Y | MODIFIED SIDE WALLS | ▽=0 | 4 PLACES ± --- ± --- | | DRAWN BY | DATE | TITLE | RIGHT ANGLE LOW PROFILE SHIELDED PC JACK (THROUGH HOLE VERSION) |
| | EC NO: E2007-0681 | ▽=0 | 3 PLACES ± --- ± .01 | | CB | 89/04/12 | MOLEX INCORPORATED | |
| | DRW: JBYRMS | | 2 PLACES ± 0.25 ± .014 | | CHECKED BY | DATE | | |
| | CHKD: CHIKO | | 1 PLACE ± 0.35 ± --- | | TB | 89/04/12 | | |
| | APPR: EDMAHONY | | ANGULAR ±1/2° | | APPROVED BY | DATE | | |
| | | | | | JB | 89/04/12 | | |
| | | | | | MATERIAL NO. | | DOCUMENT NO. | SHEET NO. |
| | | | | | SEE CHART | | SDA-95040 | 1 OF 3 |
| | | | | | SIZE | THIS DRAWING CONTAINS INFORMATION THAT IS PROPRIETARY TO MOLEX INCORPORATED AND SHOULD NOT BE USED WITHOUT WRITTEN PERMISSION | | |
| | | | | | A3 | | | |