

10 9 8 7 6 5 4 3 2 1

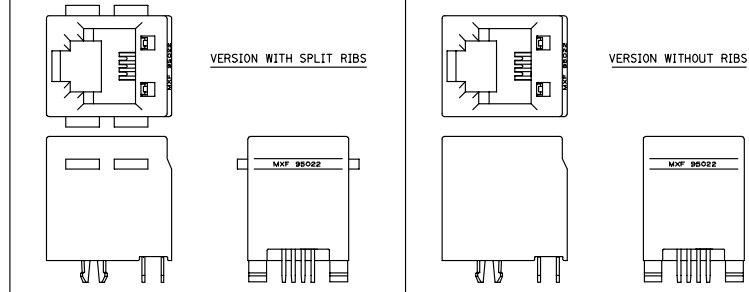
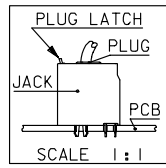
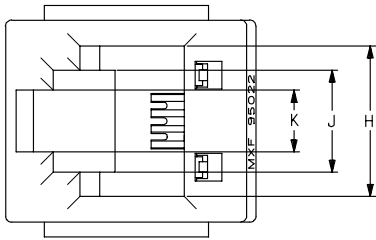

NOTES :

1- MATERIAL:

- HOUSING: POLYESTER FIBER GLASS FILLED 94-V-0 COLOR BLACK.
- TERMINAL: PHOSPHOR BRONZE. FINISH 2
- POST PLATE (0.00127-0.00152)/.000050-.000060 GOLD IN CONTACT AREA (0.00190)/.000075 MIN. PURE TIN IN TAIL AREA BOTH OVER (0.00127)/.000050 MIN. NICKEL OVERALL. FINISH 7 ONLY ON REQUEST
- POST PLATE 0.00005/.000002 MIN GOLD OVER 0.00076/.000030 MIN PALLADIUM NICKEL IN CONTACT AREA. 0.00190/.000075 MIN TIN IN TAIL AREA. BOTH OVER 0.00127/.000050 MIN NICKEL OVERALL.
- 2- PC BOARD THICKNESS : (1.57) / .062 .
- 3- JACK FOR MATING WITH F.C.C. 68 PLUGS 90075 MOLEX SERIES .
- 4- PRODUCT SPECIFICATION PS-95003.
- 5- APPLICATION SPECIFICATION AS-95001.
- 6- PACKAGING SPECIFICATION PK-95022. (SHT.1 TRAY PACKAGING) PK-95022. (SHT.2 TUBE PACKAGING)
- 7- FOR ILLUSTRATION PURPOSES A 4 CIRCUIT IS SHOWN.
- 8- PACKAGING SPECIFICATION RPK-95022-001 (TUBE PACKAGING).

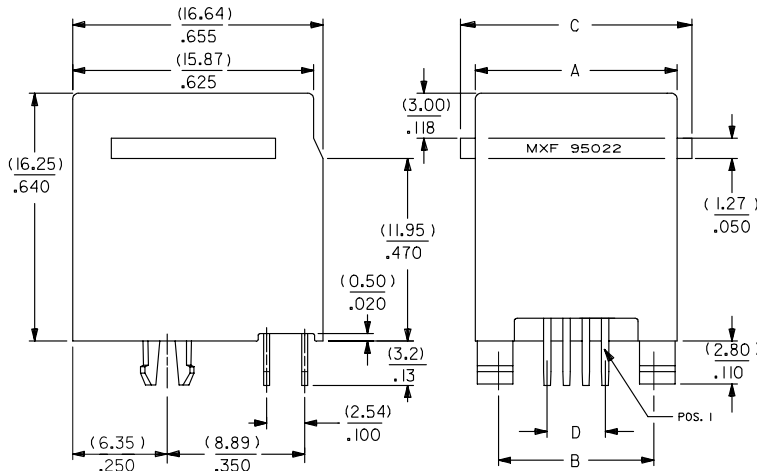

ENTER DESCRIPTION EC NO. MG2004-0207 DRAWN BY: GHTENA 2004/08/26 CHKD: CARBET 2004/08/31 APPR: KNOLLER 2004/09/08 N1	QUALITY SYMBOLS	GENERAL TOLERANCES (UNLESS SPECIFIED) <table border="1"> <tr> <th></th> <th>mm</th> <th>INCH</th> </tr> <tr> <td>4 PLACES</td> <td>± .005</td> <td>± .0002</td> </tr> <tr> <td>3 PLACES</td> <td>± .008</td> <td>± .0003</td> </tr> <tr> <td>2 PLACES</td> <td>± 0.015</td> <td>± .0006</td> </tr> <tr> <td>1 PLACE</td> <td>± 0.025</td> <td>± .0010</td> </tr> </table> ANGULAR ± 2 °		mm	INCH	4 PLACES	± .005	± .0002	3 PLACES	± .008	± .0003	2 PLACES	± 0.015	± .0006	1 PLACE	± 0.025	± .0010	DIMENSION STYLE MM/IN	SCALE 4:1	DESIGN UNITS METRIC	THIRD ANGLE PROJECTION
			mm	INCH																	
	4 PLACES		± .005	± .0002																	
	3 PLACES		± .008	± .0003																	
2 PLACES	± 0.015	± .0006																			
1 PLACE	± 0.025	± .0010																			
<table border="1"> <tr> <td>DRAWN BY</td> <td>DP</td> <td>DATE</td> <td>88/02/18</td> </tr> <tr> <td>CHECKED BY</td> <td>FB</td> <td>DATE</td> <td>88/02/19</td> </tr> <tr> <td>APPROVED BY</td> <td>JB</td> <td>DATE</td> <td>88/02/19</td> </tr> </table>	DRAWN BY	DP	DATE	88/02/18	CHECKED BY	FB	DATE	88/02/19	APPROVED BY	JB	DATE	88/02/19	TITLE HIGH PROFILE TOP ENTRY JACK	MATERIAL NO. SEE CHART SHT. 2	DOCUMENT NO. SDA-95022	MOLEX INCORPORATED					
DRAWN BY	DP	DATE	88/02/18																		
CHECKED BY	FB	DATE	88/02/19																		
APPROVED BY	JB	DATE	88/02/19																		
DRAFT WHERE APPLICABLE MUST REMAIN WITHIN DIMENSIONS	SIZE A3	THIS DRAWING CONTAINS INFORMATION THAT IS PROPRIETARY TO MOLEX INCORPORATED AND SHOULD NOT BE USED WITHOUT WRITTEN PERMISSION																			
REV						SHEET NO. 1 OF 4															

9 8 7 6 5 4 3 2 1

10 9 8 7 6 5 4 3 2 1

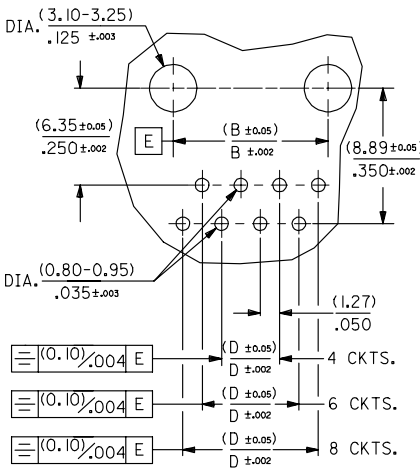

MOUNTING HOLE PATTERNS
(SEE FROM COMPONENT SIDE)

PART NUMBERS FOR JACK WITH RIBS									
TYPE	PACKAGING	POS. 4	POS. 6	POS. 6	POS. 8	POS. 8	POS. 8	TOOLED	TOOLED
		4 CKTS.	4 CKTS.	6 CKTS.	4 CKTS.	6 CKTS.	8 CKTS.	TOOLED	TOOLED
FINISH 2	TRAY	95022-2447	X 95022-2647	X 95022-2667	X 95022-2847	95022-2867	95022-2887	X	X
	TUBE	95022-2407	X 95022-2607	X 95022-2617	X 95022-2807	95022-2817	95022-2827	X	X
FINISH 7	TRAY	95022-.447	95022-.647	95022-.667	95022-.847	95022-.867	95022-.887		
	TUBE	95022-.407	95022-.607	95022-.617	95022-.807	95022-.817	95022-.827		

PART NUMBERS FOR JACK WITHOUT RIBS									
TYPE	PACKAGING	POS. 4	POS. 6	POS. 6	POS. 8	POS. 8	POS. 8	TOOLED	TOOLED
		4 CKTS.	4 CKTS.	6 CKTS.	4 CKTS.	6 CKTS.	8 CKTS.	TOOLED	TOOLED
FINISH 2	TRAY	95022-2441	X 95022-2641	X 95022-2661	X 95022-2841	95022-2861	95022-2881		
	TUBE	95022-2401	X 95022-2601	X 95022-2611	X 95022-2801	95022-2811	95022-2821		
FINISH 7	TRAY	95022-.441	95022-.641	95022-.661	95022-.841	95022-.861	95022-.881		
	TUBE	95022-.401	95022-.601	95022-.611	95022-.801	95022-.811	95022-.821		

PART NUMBERS FOR JACK WITH SPLIT RIBS									
TYPE	PACKAGING	POS. 4	POS. 6	POS. 6	POS. 8	POS. 8	POS. 8	TOOLED	TOOLED
		4 CKTS.	4 CKTS.	6 CKTS.	4 CKTS.	6 CKTS.	8 CKTS.	TOOLED	TOOLED
FINISH 2	TRAY	95022-2449	X 95022-2649	X 95022-2669	X 95022-2849	95022-2869	95022-2889		
	TUBE	95022-.449	95022-.649	95022-.669	95022-.849	95022-.869	95022-.889		

TYPE	POS. 4		POS. 6		POS. 8		
	4 CKTS.	4 CKTS.	4 CKTS.	6 CKTS.	4 CKTS.	6 CKTS.	8 CKTS.
DIM.							
A	(11.18) / .440	(13.21) / .520	(13.21) / .520	(15.24) / .600	(15.24) / .600	(15.24) / .600	
B	(7.62) / .300	(10.16) / .400	(10.16) / .400	(11.43) / .450	(11.43) / .450	(11.43) / .450	
C	(WITH RIBS)	(14.00) / .551	(16.00) / .630	(16.00) / .630	(18.00) / .709	(18.00) / .709	(18.00) / .709
	(WITH SPLIT RIBS)	(14.00) / .551	(16.00) / .630	(16.00) / .630	(18.00) / .709	(18.00) / .709	(18.00) / .709
D	(3.81) / .150	(3.81) / .150	(6.35) / .250	(3.81) / .150	(6.35) / .250	(8.89) / .350	
H	(7.82) / .308	(9.88) / .389	(9.88) / .389	(11.94) / .470	(11.94) / .470	(11.94) / .470	
J	(5.64) / .222	(6.70) / .264	(6.70) / .264	(6.30) / .248	(6.30) / .248	(6.30) / .248	
K	(3.07) / .121	(4.06) / .160	(4.06) / .160	(4.06) / .160	(4.06) / .160	(4.06) / .160	

ENTER DESCRIPTION IEC NO. MG2004-0207 DRAWN BY: GHTENA 2004/08/26 CHECKED BY: CARBET 2004/08/31 APPROVED BY: KNOLLER 2004/09/08 N1	QUALITY SYMBOLS ▽=0 ▽=0	GENERAL TOLERANCES (UNLESS SPECIFIED) mm INCH 4 PLACES ± --- ± --- 3 PLACES ± --- ± .010 2 PLACES ± 0.25 ± .014 1 PLACE ± 0.35 ± --- ANGULAR ± 2°	DIMENSION STYLE MM/IN DRAWN BY: DP DATE: 90/03/09 CHECKED BY: FB DATE: 90/03/09 APPROVED BY: JB DATE: 90/03/09	SCALE 4:1 DESIGN UNITS METRIC THIRD ANGLE PROJECTION	TITLE HIGH PROFILE TOP ENTRY JACK
	MATERIAL NO. SEE CHART DOCUMENT NO. SDA-95022 SHEET NO. 2 OF 4		MOLEX INCORPORATED THIS DRAWING CONTAINS INFORMATION THAT IS PROPRIETARY TO MOLEX INCORPORATED AND SHOULD NOT BE USED WITHOUT WRITTEN PERMISSION		
	DRAFT WHERE APPLICABLE MUST REMAIN WITHIN DIMENSIONS		SIZE A3		
	THIS DRAWING CONTAINS INFORMATION THAT IS PROPRIETARY TO MOLEX INCORPORATED AND SHOULD NOT BE USED WITHOUT WRITTEN PERMISSION				

9 8 7 6 5 4 3 2 1