

DIRFRD006

REVISION RECORD				
REV	ECO	DESCRIPTION	DRFT	CHKD

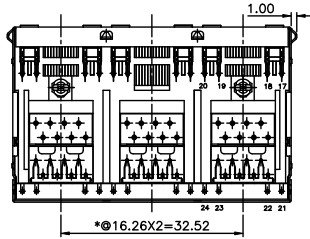

GREEN GREEN
12 10 10 8
RED RED
GREEN GREEN
12 10 10 8
RED RED
FOR P/N:ESJ88-D48FX-L

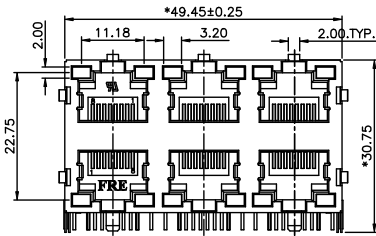
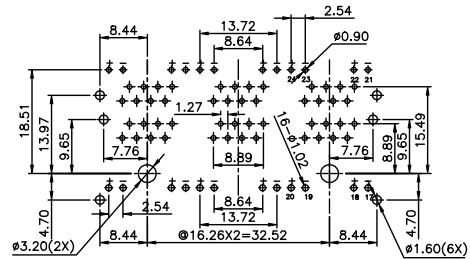
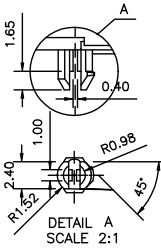
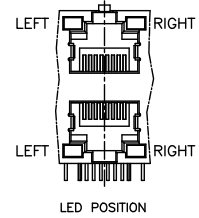
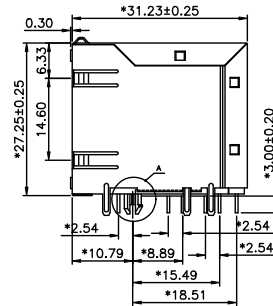

PC Board Layout
Component Side Shown

NOTES:

ELECTRICAL:

- VOLTAGE RATING : 125 VAC RMS.
- CURRENT RATING : 1.5 AMP.
- CONTACT RESISTANCE : 35 MILLIOHMS MAX.
- INSULATION RESISTANCE: 1000 MEGOHMS MIN @ 500 VDC.
- DIELECTRIC STRENGTH : 1000 VAC RMS 60Hz, 1MIN.

MECHANICAL:

- HOUSING MATERIAL : PBT+30%G.F UL94V-0.
- CONTACT MATERIAL : PHOSPHOR BRONZE Ø0.46mm
- CONTACT PLATING : GOLD PLATING OVER NICKLE
- SHIELD PLATING : NICKEL PLATING OVER BRASS
- OPERATING LIFE : 750 CYCLES MIN.
- PCB RETENTION PRE-SOLDER : 1 LB MIN.
- PCB RETENTION POST-SOLDER : 1 LBS MIN.
- LED COLOR : GREEN

ENVIRONMENTAL:

- STORAGE : -40°C TO +85°C.
- OPERATION: -40°C TO +85°C.
- WAVE SOLDERING TEMPERATURE: 230~250°(3~5 SECONDS)

MATES WITH MODULAR PLUG CONFORMING TO
FCC PART 68, SUBPART F.

RoHS PART NUMBER: ESJ88-X482FX-L

- A-LEFT LED:G RIGHT LED:G Gold Thickness:
B-LEFT LED:G RIGHT LED:O 1-3u" 2-6u" 3-15u"
C-LEFT LED:G RIGHT LED:Y 4-30u" 5-50u"
D-LEFT LED:G+R RIGHT LED:G+R

<p>MM (INCH)</p> <p>TOLERANCES EXCEPT AS NOTED</p>		<p>DFTO Joke DATE 10/19/05</p> <p>CHKD: DATE 09/19/05</p> <p>MFO DATE</p> <p>APPVL: DATE 09/19/05</p>	<p>FULL RISE ELECTRONIC CO., LTD</p>	
<p>MM</p> <p>.0 ±0.20</p> <p>.00 ±0.15</p> <p>.000 ±0.075</p>	<p>±</p> <p>±</p> <p>±</p>	<p>MATERIAL :</p> <p>QT'Y :</p> <p>FINISH :</p>	<p>TITLE RJ45(LED) STACKED GANGED JACK, 2X3</p>	
<p>ANGLES ±</p> <p>THIRD ANGLE PROJECTION</p>	<p>SCALE : 5:3</p>	<p>DRAWING NO. GE5J3035-LC</p> <p>/PART NO. SEE NOTE</p>	<p>SIZE A3</p> <p>REV 0</p> <p>10/19/05</p>	<p>DO NOT SCALE DRAWING</p> <p>SHEET 1 OF 1</p>

8 | 7 | 6 | 5 | 4 | 3 | 2 | 1

H
G
F
E
D
C
B
A