

D1RFRD006

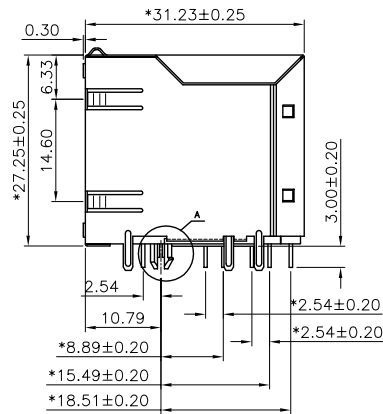

GREEN GREEN
 24 23 22 21
 RED RED
 GREEN GREEN
 20 19 18 17
 RED RED
 FOR P/N: E5J88-D4LXFX

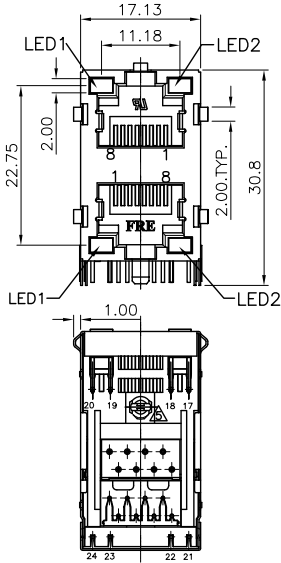
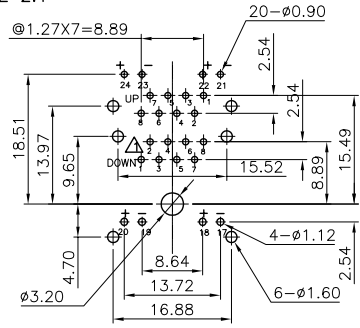
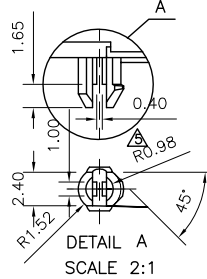

PC Board Layout
 Component Side Shown

REV	ECO	DESCRIPTION	DRFT	CHKD
△		DRAWING MODIFY	IRONDR	
△		ADD NEW P/N	11/28/02	
△		DRAWING MODIFY	08/07/03	
△		ADD NEW P/N	08/23/03	
△		DRAWING MODIFY	08/23/03	
△		ADD NEW P/N	10/22/03	
△		DRAWING MODIFY	PETERS	
△		ADD NEW P/N	10/28/04	
△		DRAWING MODIFY	PETERS	
△		ADD NEW P/N	02/28/05	
△		ERASE P/N	YINLIAN	
△			08/28/06	

NOTES:

ELECTRICAL:

- VOLTAGE RATING : 125 VAC RMS.
- CURRENT RATING : 1.5 AMP.
- CONTACT RESISTANCE : 50 MILLIOHMS MAX.
- INSULATION RESISTANCE: 1000 MEGOHMS MIN @ 500 VDC.
- DIELECTRIC STRENGTH : 1000 VAC RMS 60Hz, 1MIN.

MECHANICAL:

- HOUSING MATERIAL : GLASS FILLED POLYESTER UL94V-0.
- CONTACT MATERIAL : PHOSPHOR BRONZE #0.46mm.
- PLATING : 1: CONTACT AREA- SELECTIVE GOLD PLATING.
2: TAILS- 150u" TIN-LEAD MIN OVER 50u" NICKEL.
- OPERATING LIFE : 750 CYCLES MIN.
- PCB RETENTION PRE-SOLDER : 1 LB MIN.
- PCB RETENTION POST-SOLDER: 10 LBS MIN.
- LED COLOR : GREEN

ENVIRONMENTAL:

- STORAGE : -40°C TO +85°C.
- OPERATION: 0°C TO 70°C.

MATES WITH MODULAR PLUG CONFORMING TO
 FCC PART 68, SUBPART F.

W/ TIN NUMBER: E5J88-XXLXFX

- A-LED1:GREEN, LED2:GREEN
- B-LED1:GREEN, LED2:ORANGE
- C-LED1:GREEN, LED2:YELLOW
- L-LED1:YELLOW, LED2:GREEN
- △D-LED1:G+R, LED2:G+R
- △F-LED1:ORANGE, LED2:GREEN
- 1- 3u" 2- 6u" 3-15u"
- 4-30u" 5-50u"
- 0- W/O "FRE" LOGO
- 2- W/ "FRE" LOGO
- △3- W/ "FRE" LOGO A05-0130
- 1- NO TAB △
- 4- TOP TABS & SIDE TABS

MM (INCH)		DATE 12/13/01	FULL RISE ELECTRONIC CO., LTD	
TOLERANCES EXCEPT AS NOTED		DATE 2006/9/26	TITLE RJ45(LED)	
MM		DATE	STACKED GANGED JACK, 2X1	
±	±	DATE 2006/9/26	DRAWING NO. GE5J3021	
±	±		/PART NO. SEE NOTE	
±	±		SIZE A3	
±	±		REV 15/28/06	
±	±		DO NOT SCALE DRAWING	
±	±		SHEET 1 OF 1	

8 | 7 | 6 | 5 | 4 | 3 | 2 | 1

H
G
F
E
D
C
B
A