

D1RFRD006

REVISION RECORD				
REV	ECO	DESCRIPTION	DRAFT	CHKD
△		DRAWING MODIFY	JMM/YN	12/13/06

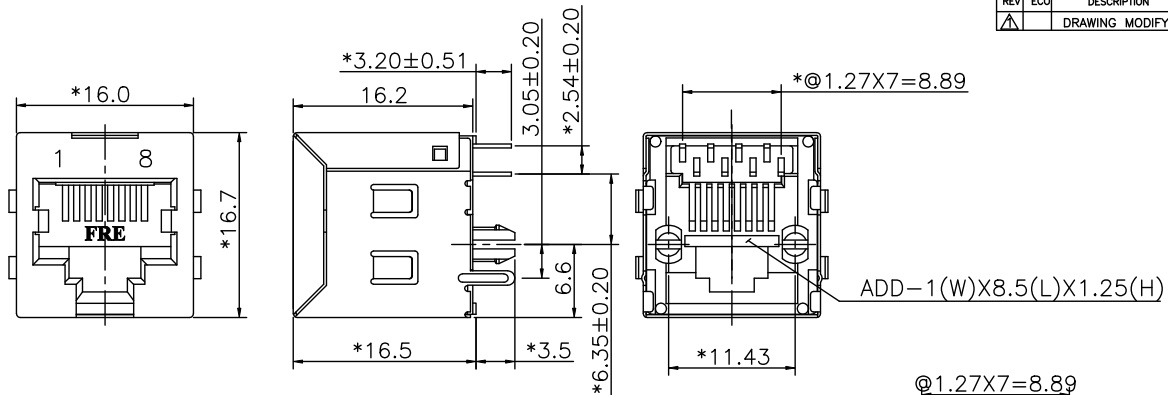

NOTES:

- ELECTRICAL:**
- VOLTAGE RATING : 125 VAC RMS.
 - CURRENT RATING : 1.5 AMP.
 - CONTACT RESISTANCE : 30 MILLIOHMS MAX.
 - INSULATION RESISTANCE: 1000 MEGOHMS MIN @ 500 VDC.
 - DIELECTRIC STRENGTH : 1000 VAC RMS 60Hz, 1MIN.
- MECHANICAL:**
- HOUSING MATERIAL : PBT UL94V-0.
 - CONTACT MATERIAL : PHOSPHOR BRONZE t=0.35mm.
 - PLATING : GOLD PLATING OVER NICKEL.
 - OPERATING LIFE : 750 CYCLES MIN.
 - PCB RETENTION PRE-SOLDER: 1 LB MIN.
 - PCB RETENTION POST-SOLDER: 10 LBS MIN.

- ENVIRONMENTAL:**
- STORAGE : -40°C TO +85°C.
 - OPERATION: 0°C TO 70°C.
 - WAVE SOLDER TEMPERATURE: 230~250°C(5~10SECONDS).
- MATES WITH MODULAR PLUG CONFORMING TO
FCC PART 68, SUBPART F.

CUL FILE NO. E163191

△ ROHS PART NUMBER: E5288-3X0X4X-L

- | | |
|---------------------------------|-------------------------|
| SHIELD PLATING: | GOLD PLATING: |
| 1- TIN PLATING,W/ SIDE TABS | 1- 3u" 2- 6u" |
| 2- NICKEL PLATING,W/ SIDE TABS | 3- 15u" 4- 30u" |
| S- TIN PLATING,W/O SIDE TABS | 5- 50u" |
| T- NICKEL PLATING,W/O SIDE TABS | 0-PBT+15%G.F (BK) |
| | 1-PBT+30%G.F (BK) |
| | L-PBT+30%G.F (YELLOW) △ |

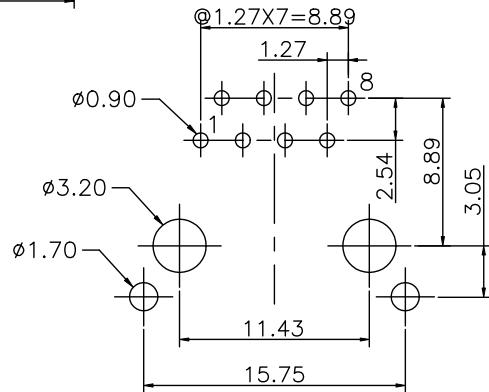

DIM (INCH) ← TOLERANCES EXCEPT AS NOTED		DFTO SAMMY DATE 03/16/06 CHD/HR/HR DATE 2009/12/14 MFO DATE	FULL RISE ELECTRONIC CO., LTD	
.0 ±0.20 ± .00 ±0.15 ± .000 ±0.075 ±	APPVL LUSHENQ DATE 2009/12/14 MATERIAL :	TITLE RJ45 TOP ENTRY PCB MODULAR JACK(DIP TYPE)		
ANGLES ± THIRD ANGLE PROJECTION	QTY : FINISH :	DRAWING NO. GE523014-LC /PART NO. SEE NOTE		SIZE REV A3 1
SCALE : 3:1		DO NOT SCALE DRAWING		

8 | 7 | 6 | 5 | 4 | 3 | 2 | 1

H
G
F
E
D
C
B
A