

D1RFRD006

| REVISION RECORD | | | | |
|-----------------|-----|--------------|----------|------|
| REV | ECC | DESCRIPTION | DRAFT | CHKD |
| 1 | | NOTES MODIFY | 11/20/04 | |

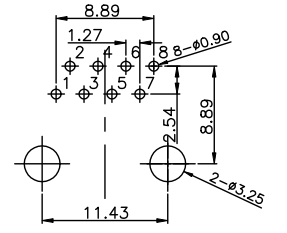
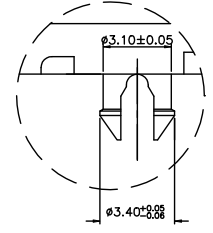
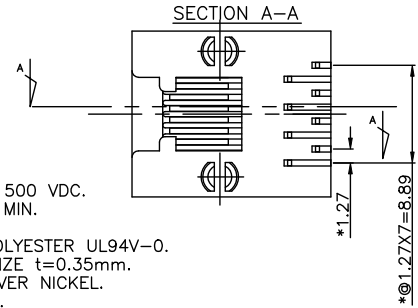
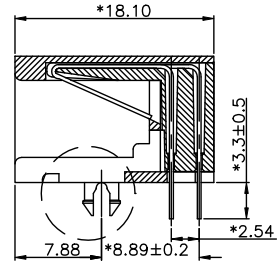
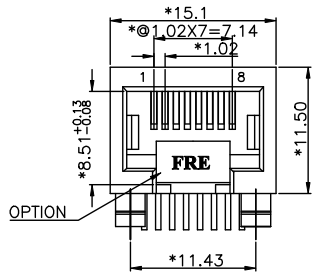

PCB T=1.60mm
PC BOARD LAYOUT COMPONENT SIDE SHOWN

NOTES:

ELECTRICAL:

- VOLTAGE RATING : 125 VAC RMS.
- CURRENT RATING : 1.5 AMP.
- CONTACT RESISTANCE : 35 MILLIOHMS MAX.
- INSULATION RESISTANCE: 1000 MEGOHMS MIN @ 500 VDC.
- DIELECTRIC STRENGTH : 1000 VAC RMS 60Hz, 1MIN.

MECHANICAL:

- HOUSING MATERIAL : GLASS FILLED POLYESTER UL94V-0.
- CONTACT MATERIAL : PHOSPHOR BRONZE t=0.35mm.
- PLATING : GOLD PLATING OVER NICKEL.
- OPERATING LIFE : 750 CYCLES MIN.
- PCB RETENTION PRE-SOLDER : 1 LB MIN.
- PCB RETENTION POST-SOLDER: 10 LBS MIN.

ENVIRONMENTAL:

- STORAGE : -40°C TO +85°C.
- OPERATION: -40°C TO +85°C.

MATES WITH MODULAR PLUG CONFORMING TO FCC PART 68, SUBPART F.

CUL FILE NO. E163191

PART NUMBER: E538X-E002XX-L

| NO OF CONTACT: | |
|----------------|--------------------|
| 2- 2C | 1- 3u" 2- 6u" |
| 4- 4C | 3- 15u" 4- 30u" |
| 6- 6C | 5- 50u" 6- Pd 20u" |
| 8- 8C | 1-W/FRE LOGO |
| | R-W/O LOGO |

| | | | |
|---------------|----------------------------|----------------------------|-------------------------------|
| DETAILED LIST | MM (INCR) | DFTD SAMMY DATE 06/22/04 | FULL RISE ELECTRONIC CO., LTD |
| | TOLERANCES EXCEPT AS NOTED | CHKD SAMMY DATE 2004/11/16 | |
| | | MFO DATE | |
| | | DATE 2004/11/17 | |
| | MM | APPLY LUSHENG | TITLE 11.5 SIDE ENTRY 8P |
| | 0 ±0.25 | | FCC DEEP TYPE(LEAD FREE) |
| | 00 ±0.15 | | DRAWING NO. GE533096 |
| | 000 ±0.075 | | /PART NO. SEE NOTE |
| | ANGLES ± | QTY : | SIZE REV |
| | | | A3 1 |
| | THIRD ANGLE PROJECTION | SCALE : | DO NOT SCALE DRAWING |
| | | | SHEET X OF Y |

8 | 7 | 6 | 5 | 4 | 3 | 2 | 1

H
G
F
E
D
C
B
A