

8	7	6	5	4	3	2	1
DATE STARTED TO MANUFACTURE	REVISIONS FOR PURCHASER						
DATE COMPLETED	BY THE ELECTRONIC COMPONENTS DIVISION						

REV	DATE	DESCRIPTION	BY	CHK	APP
A	10-20-90	REVISED PER EC 0840-0118-00	LS	JLP	
B	10-24-90	REV: EC 0840-0217-01	TLP	CO	
C	10-24-90	REV: EC 0840-0229-01	TLP	CO	
D	10-26-90	ECO-01-016706	JM	DM	

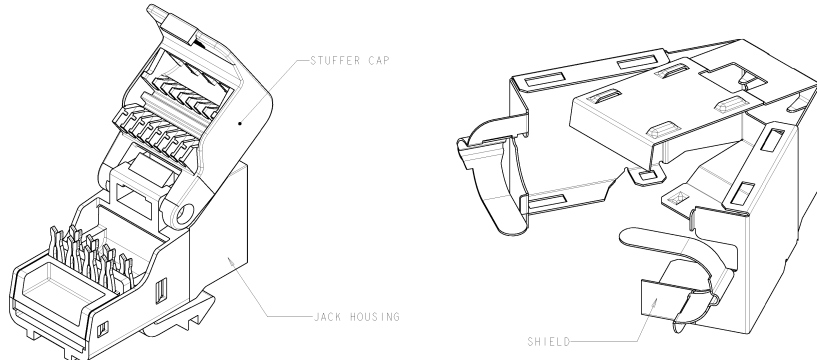

- △ MATERIAL: JACK HOUSING - POLYPHENYLENE OXIDE, 94V-0 RATED. TERMINAL BLOCK - PBT POLYESTER, 94V-0 RATED. STUFFER CAP - POLYCARBONATE (CLEAR, 94V-0 RATED. JACK CONTACTS - PHOSPHOROUS BRONZE, PLATED WITH 1.27um (.000050) MINIMUM THICK GOLD IN LOCALIZED AREA AND 3.81um (.000150) MINIMUM THICK MATTE TIN IN SOLDER AREA OVER 1.27um (.000050) MINIMUM THICK NICKEL UNDERPLATE. SHIELD - COPPER ZINC ALLOY 260 PREPLATED WITH BRIGHT NICKEL.
- 2. TOOLLESS WILL TERMINATE 22-24 AWG SOLID CONDUCTORS AND 24 AWG STRANDED CONDUCTORS, 1.14 (.045) MAXIMUM INSULATION DIAMETER.
- △ CAVITY CONFORMS TO FCC RULES AND REGULATIONS PART 68 SUBPART F REQUIREMENTS.
- 4. MOUNTING PANEL THICKNESS 1.473 - 1.600 (.058 - .063).
- △ THESE TWO SUGGESTED CUTOUT OPENINGS ARE USED IN TANDEM WITH DUAL FRONT AND BACK-CUTOUTS.
- 6. SHIELD SHIPPED NOT ASSEMBLED.

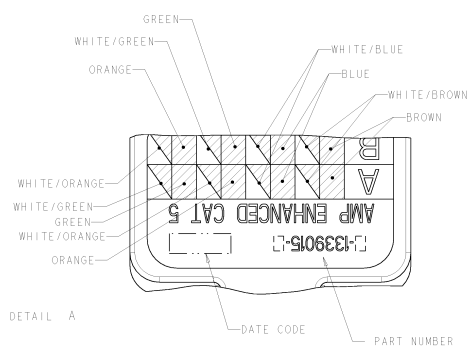
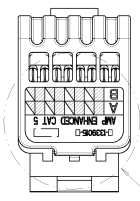
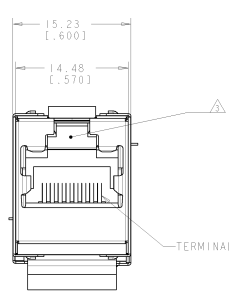
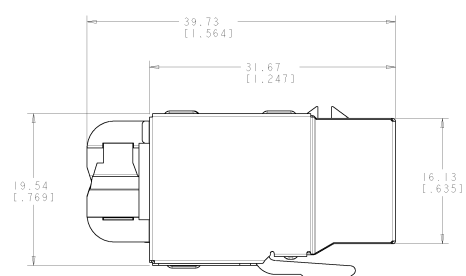

VIEW SHOWING SHIELD ASSEMBLED

DETAIL A SCALE 10:1

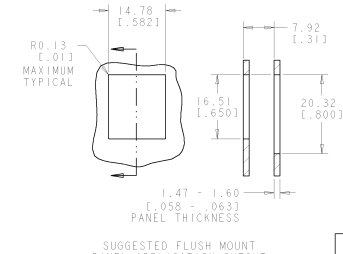
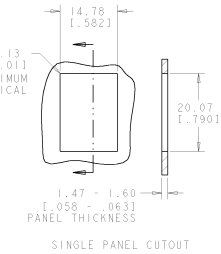
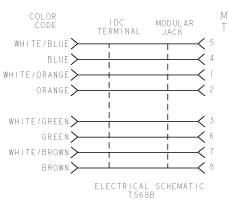
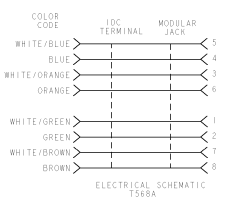

SINGLE PANEL CUTOUT

SUGGESTED FLUSH MOUNT PANEL APPLICATION CUTOUT

1339015-1
PART NUMBER

STANDARD DIMENSIONS (IN LINES)	PART NUMBER 1339015-1	DATE 22NOV99	REV. 00	TITLE ASSEMBLY, TOOLLESS, CAT 5, UNIVERSAL, RJ45, SHIELD	DRAWN BY JLP	CHECKED BY CO	DATE 10/24/90	APPROVED BY DM
--------------------------------------	--------------------------	-----------------	------------	---	-----------------	------------------	------------------	-------------------