

REV	DATE	DESCRIPTION	BY	APP
AA	00			
B	02-07-2008			

- MATERIAL: HOUSING - HTN MOLDING COMPOUND, 94 VO, COLOR: BLACK  
 TERMINALS - 0.35[.0138] THICK PHOS-BRONZE PLATED WITH 1.27µm[.000050] THICK GOLD IN CONTACT PLATE AREAS AND 3.8µm[.000150] MINIMUM THICK TIN ON SOLDER TINES OVER 1.27µm[.000050] MINIMUM THICK NICKEL UNDERPLATE.
- CAVITY CONFORMS TO FCC RULES AND REGULATIONS PART 68, SUBPART F.
- PACKAGED 31 ASSEMBLIES PER TUBE WITH BOTH ENDS PLUGGED. SEE DETAIL A.
- ALL DIMENSIONS ARE MAXIMUM UNLESS OTHERWISE SPECIFIED

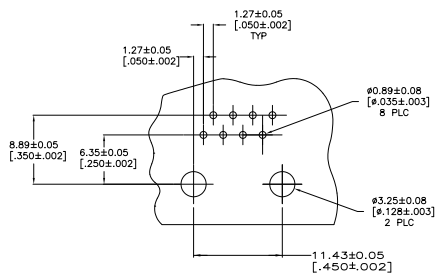

RECOMMENDED PRINTED CIRCUIT BOARD MOUNTING HOLE LAYOUT  
 VIEW SHOWN IS COMPONENT SIDE OF BOARD

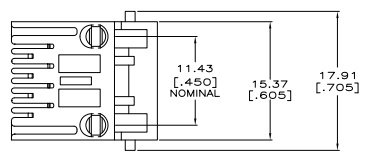
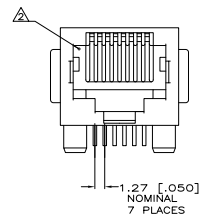
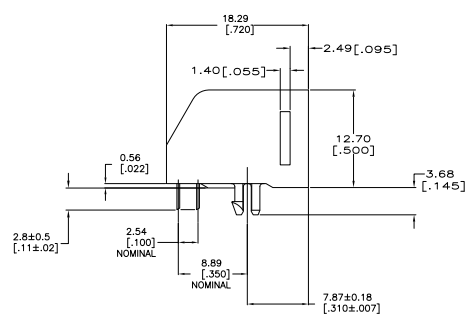
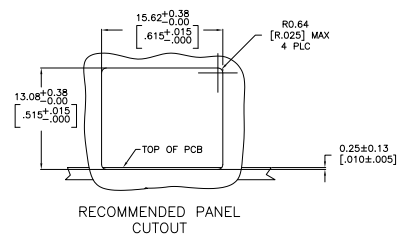

RECOMMENDED PANEL CUTOUT

5406958-1  
 PART NO.

THIS DRAWING IS A CONTROLLED DOCUMENT.		DATE	BY	APP	REV	DESCRIPTION	DATE	BY	APP
DATE	BY	DATE	BY	APP	REV	DESCRIPTION	DATE	BY	APP
108-1163	114-2048	114-2048	100779	5406958					