

4

3

2

1

THIS DRAWING IS UNPUBLISHED. RELEASED FOR PUBLICATION  
 © COPYRIGHT - BY TYCO ELECTRONICS CORPORATION. ALL RIGHTS RESERVED.

LOC	DIST	REVISIONS				
P	LTR	DESCRIPTION	DATE	DWN	APVD	
A		ECR-07-028576	14DEC07	AW	WK	
A1		REVISED PER ECO-10-000445	11JAN10	KK	AEG	

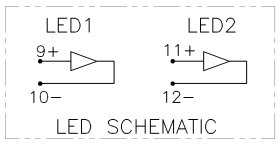
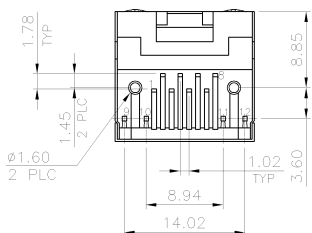
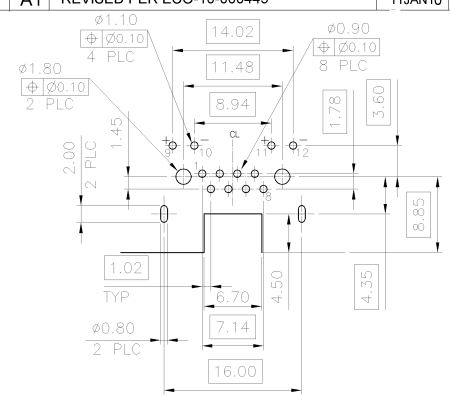
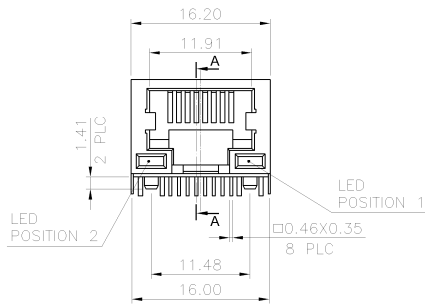
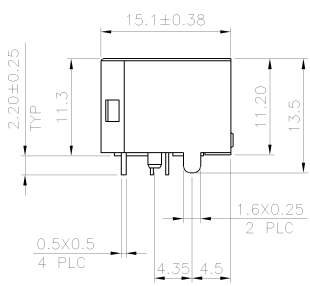
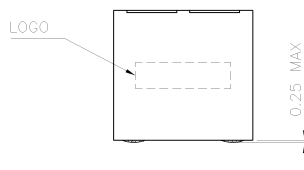
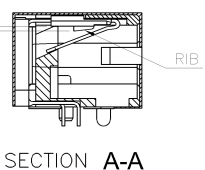

- NOTE:
- MATERIAL:  
HOUSING: PA46 WITH 30% GF, UL 94V-0, BLACK COLOR.  
CONTACTS: PHOSPHOR BRONZE.  
LED LIGHT: EPOXY RESIN.  
SHELL: BRASS.
  - FINISH:  
CONTACTS: (SEE TABLE) GOLD PLATED ON CONTACT AREA, GOLD FLASH ON SOLDER TAILS, WITH ENTIRE CONTACT UNDERPLATED 1.27μm [50μ] MIN. NICKEL.  
LED: 1.65μm [65μ] MIN. Ag PLATED.  
2.16μm [85μ] MIN. TIN PLATED.  
FORWARD CURRENT: 20mA.  
FORWARD VOLTAGE: 2.2 VOLTS TYPICAL.  
SHELL: 0.50μm [20μ] MIN. NICKEL PLATED.
  - LED MUST BE REFLOW COMPATIBLE TO FOLLOWING TEMPERATURE PROFILE (FOR 1 CYCLE): ABOVE 160°C FOR 120 SECONDS, PEAKING AT 220°C FOR 10 SECONDS.
  - LED DEFECT RATE IS 6000 PPM MAX. AFTER IIR REFLOW PROCESS AS NOTE 3.
  - WAVE SOLDER CAPABLE TO 265°C PER TE SPEC. 109-202, CONDITION B.
- ⚠ OBSOLETE PARTS: OBSOLETE CIS STREAMLINING PER D.RENAUD/D.SINISI

PACKAGE	POSITION 2	POSITION 1	MIN. GOLD THICKNESS	PART NUMBER
REEL	YELLOW	GREEN	50μ	1-1734324-8
			30μ	1-1734324-7
	GREEN	YELLOW	15μ	1-1734324-6
			6μ	1-1734324-5
TRAY	YELLOW	GREEN	50μ	1-1734324-4
			15μ	1-1734324-3
	GREEN	YELLOW	30μ	1-1734324-2
			6μ	1-1734324-1

THIS DRAWING IS A CONTROLLED DOCUMENT.

DIMENSIONS:	TOLERANCES UNLESS OTHERWISE SPECIFIED:	DWN A. WU 04MAR2008	CHK S. HOU 04MAR2008	APVD W. KODAMA 04MAR2008	NAME Tyco Electronics Tyco Electronics Corporation Taipei, Taiwan
MM	0 PLC ± 0.50 1 PLC ± 0.38 2 PLC ± 0.25 3 PLC ± 0.10 4 PLC ± - ANGLES ± -	PRODUCT SPEC 108-57535	QUALIFICATION TEST REPORT		
MATERIAL SEE NOTE	FINISH SEE NOTE	WEIGHT 4.5 GRAMS	SIZE A3	CAGE CODE 00779	DRAWING NO 1734324
CUSTOMER DRAWING		SCALE -	SHEET 1 of 7	REV A1	

4

3

2

1

THIS DRAWING IS UNPUBLISHED. RELEASED FOR PUBLICATION  
 © COPYRIGHT - BY TYCO ELECTRONICS CORPORATION. ALL RIGHTS RESERVED.

LOC	DIST	REVISIONS			
P	LTR	DESCRIPTION	DATE	DWN	APVD
SEE SHEET 1.					

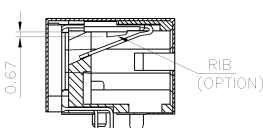

SECTION A-A

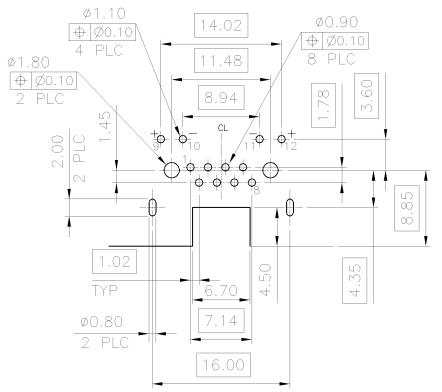
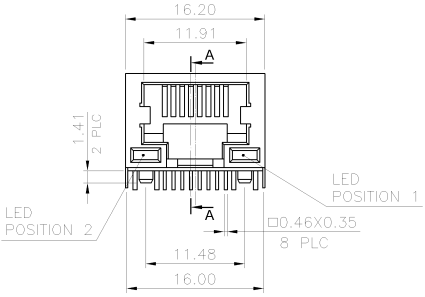
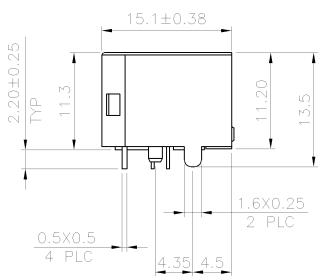
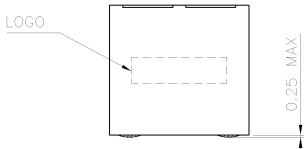

RECOMMENDED PCB LAYOUT (THICKNESS: 1.6mm)  
 DIMENSION TOLERANCE: 1 PLC: ±0.1 2PLC: ±0.05

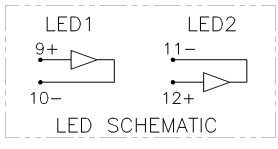
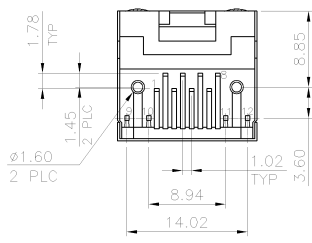

- NOTE:
- MATERIAL:  
HOUSING: PA46 WITH 30% GF, UL 94V-0, BLACK COLOR.  
CONTACTS: PHOSPHOR BRONZE.  
LED LIGHT: EPOXY RESIN.  
SHELL: BRASS.
  - FINISH:  
CONTACTS: (SEE TABLE) GOLD PLATED ON CONTACT AREA, GOLD FLASH ON SOLDER TAILS, WITH ENTIRE CONTACT UNDERPLATED 1.27µm [50µ"] MIN. NICKEL.  
LED: 1.65µm [65µ"] MIN. Ag PLATED.  
2.16µm [85µ"] MIN. TIN PLATED.  
FORWARD CURRENT: 20mA.  
FORWARD VOLTAGE: 2.2 VOLTS TYPICAL.  
SHELL: 0.50µm [20µ"] MIN. NICKEL PLATED.
  - LED MUST BE REFLOW COMPATIBLE TO FOLLOWING TEMPERATURE PROFILE (FOR 1 CYCLE): ABOVE 160°C FOR 120 SECONDS, PEAKING AT 220°C FOR 10 SECONDS.
  - LED DEFECT RATE IS 6000 PPM MAX. AFTER IIR REFLOW PROCESS AS NOTE 3.
  - WAVE SOLDER CAPABLE TO 265°C PER TE SPEC. 109-202, CONDITION B.
- ⚠️ OBSOLETE PARTS: OBSOLETE CIS STREAMLINING PER D.RENAUD/D.SINISI

W/O	REEL	YELLOW	GREEN	50µ"	3-1734324-8
				30µ"	3-1734324-7
				15µ"	3-1734324-6
				6µ"	3-1734324-5
		GREEN	YELLOW	50µ"	3-1734324-4
				30µ"	3-1734324-3
				15µ"	3-1734324-2
				6µ"	3-1734324-1
		YELLOW	GREEN	50µ"	2-1734324-8
				30µ"	2-1734324-7
				15µ"	2-1734324-6
				6µ"	2-1734324-5
		GREEN	YELLOW	50µ"	2-1734324-4
				30µ"	2-1734324-3
				15µ"	2-1734324-2
				6µ"	2-1734324-1

THIS DRAWING IS A CONTROLLED DOCUMENT.

DIMENSIONS:	TOLERANCES UNLESS OTHERWISE SPECIFIED:	DWN	04MAR2008	Tyco Electronics Corporation Taipei, Taiwan	
MM	0 PLC ± 0.50	CHK	A. WU	NAME	
	1 PLC ± 0.38	S.	S. HOU	PRODUCT SPEC	
	2 PLC ± 0.25	APVD	W. KODAMA	108-57535	
	3 PLC ± 0.10	QUALIFICATION TEST REPORT			
	4 PLC ± -	501-57628			
MATERIAL	FINISH	SIZE	CAGE CODE	DRAWING NO	RESTRICTED TO
SEE NOTE	SEE NOTE	A3	00779	1734324	-
CUSTOMER DRAWING				SCALE	SHEET 2 OF 7 REV A1

4

3

2

1

THIS DRAWING IS UNPUBLISHED. RELEASED FOR PUBLICATION  
 © COPYRIGHT - BY TYCO ELECTRONICS CORPORATION. ALL RIGHTS RESERVED.

LOC	DIST	REVISIONS			
P	LTR	DESCRIPTION	DATE	DWN	APVD
SEE SHEET 1.					

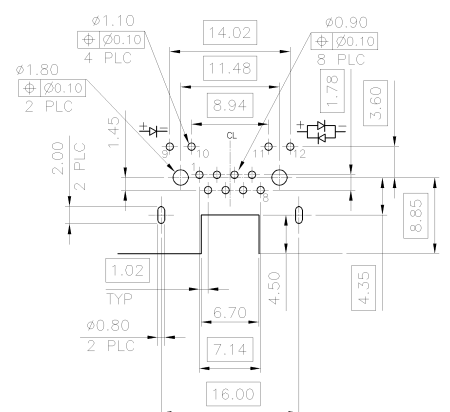
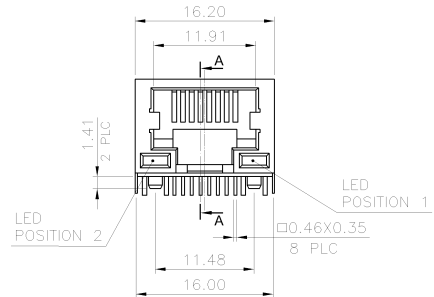
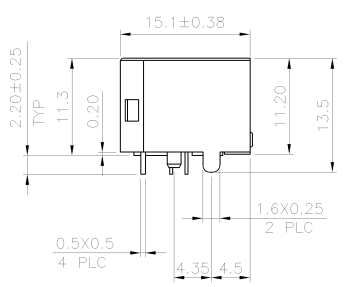
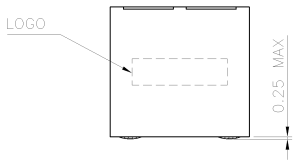
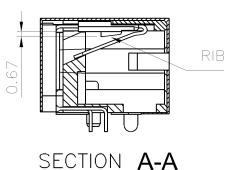

- NOTE:
- MATERIAL:  
HOUSING: PA46 WITH 30% GF, UL 94V-0, BLACK COLOR.  
CONTACTS: PHOSPHOR BRONZE.  
LED LIGHT: EPOXY RESIN.  
SHELL: BRASS.
  - FINISH:  
CONTACTS: (SEE TABLE) GOLD PLATED ON CONTACT AREA, GOLD FLASH ON SOLDER TAILS, WITH ENTIRE CONTACT UNDERPLATED 1.27µm [50µ] MIN. NICKEL.  
LED: 1.65µm [65µ] MIN. Ag PLATED.  
2.16µm [85µ] MIN. TIN PLATED.  
FORWARD CURRENT: 20mA.  
FORWARD VOLTAGE: 2.2 VOLTS TYPICAL.  
SHELL: 0.50µm [20µ] MIN. NICKEL PLATED.
  - LED MUST BE REFLOW COMPATIBLE TO FOLLOWING TEMPERATURE PROFILE (FOR 1 CYCLE): ABOVE 160°C FOR 120 SECONDS, PEAKING AT 220°C FOR 10 SECONDS.
  - LED DEFECT RATE IS 6000 PPM MAX. AFTER IIR REFLOW PROCESS AS NOTE 3.
  - WAVE SOLDER CAPABLE TO 265°C PER TE SPEC. 109-202, CONDITION B.
- ⚠️ OBSOLETE PARTS: OBSOLETE CIS STREAMLINING PER D.RENAUJID.SINISI

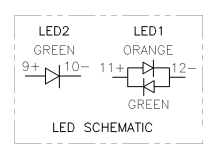
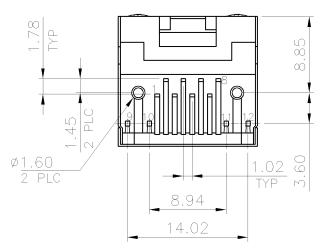

PACKAGE	POSITION 2	POSITION 1	MIN. GOLD THICKNESS	PART NUMBER
⚠️ OBSOLETE	TRAY	GREEN	ORANGE & GREEN	50µ" 4-1734324-4
				30µ" 4-1734324-3
				15µ" 4-1734324-2
			6µ" 4-1734324-1	

THIS DRAWING IS A CONTROLLED DOCUMENT.

DIMENSIONS: MM	TOLERANCES UNLESS OTHERWISE SPECIFIED:	DWN: A. WU 04MAR2008	Tyco Electronics Tyco Electronics Corporation Taipei, Taiwan				
	0 PLC ± 0.50	CHK: S. HOU 04MAR2008	<b>MODULAR JACK, RJ45, 8P8C, WITH LED &amp; SHIELD, DIP, REVERSE VERSION</b>				
	1 PLC ± 0.38	APVD: W. KODAMA 04MAR2008					
	2 PLC ± 0.25	NAME: PRODUCT SPEC					
	3 PLC ± 0.10	108-57535					
4 PLC ± -	ANGLES ± -	QUALIFICATION TEST REPORT	SIZE: A3	CAGE CODE: 00779	DRAWING NO: C-1734324	RESTRICTED TO: -	
MATERIAL: SEE NOTE	FINISH: SEE NOTE	WEIGHT: 4.5 GRAMS	CUSTOMER DRAWING		SCALE: -	SHEET: 3 of 7	REV: A1

4

3

2

1

THIS DRAWING IS UNPUBLISHED. RELEASED FOR PUBLICATION  
 © COPYRIGHT - BY TYCO ELECTRONICS CORPORATION. ALL RIGHTS RESERVED.

LOC	DIST	REVISIONS			
P	LTR	DESCRIPTION	DATE	DWN	APVD
SEE SHEET 1.					

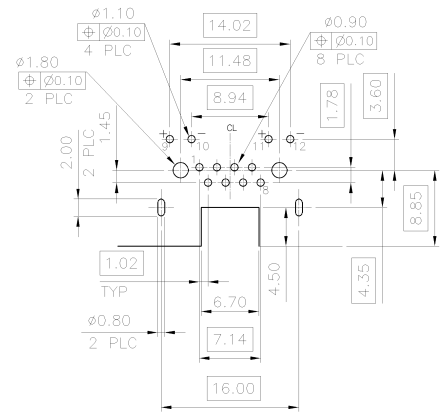
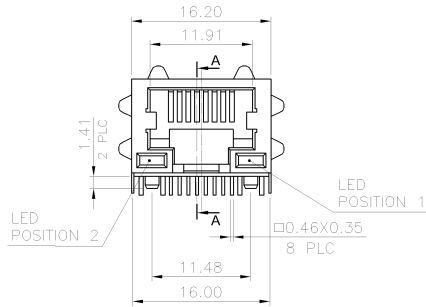
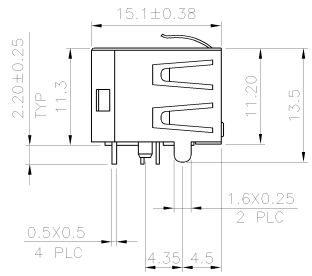
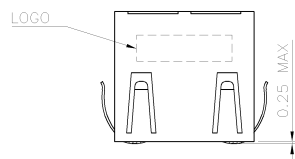
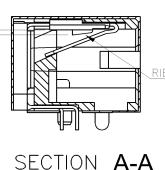

- NOTE:
- MATERIAL: PA46 WITH 30% GF, UL 94V-0, BLACK COLOR.  
 HOUSING: PA46 WITH 30% GF, UL 94V-0, BLACK COLOR.  
 CONTACTS: PHOSPHOR BRONZE.  
 LED LIGHT: EPOXY RESIN.  
 SHELL: BRASS.
  - FINISH:  
 CONTACTS: (SEE TABLE) GOLD PLATED ON CONTACT AREA, GOLD FLASH ON SOLDER TAILS, WITH ENTIRE CONTACT UNDERPLATED 1.27μm [50μ" MIN. NICKEL.  
 LED: 1.65μm [65μ" MIN. Ag PLATED.  
 2.16μm [85μ" MIN. TIN PLATED.  
 FORWARD CURRENT: 20mA  
 FORWARD VOLTAGE: 2.2 VOLTS TYPICAL.  
 SHELL: 0.50μm [20μ" MIN. NICKEL PLATED.
  - LED MUST BE REFLOW COMPATIBLE TO FOLLOWING TEMPERATURE PROFILE (FOR 1 CYCLE): ABOVE 160°C FOR 120 SECONDS, PEAKING AT 220°C FOR 10 SECONDS.
  - LED DEFECT RATE IS 6000 PPM MAX. AFTER IR REFLOW PROCESS AS NOTE 3.
  - WAVE SOLDER CAPABLE TO 265°C PER TE SPEC. 109-202, CONDITION B.
- ⚠️ OBSOLETE PARTS: OBSOLETE CIS STREAMLINING PER D.RENAUD/D.SINISI

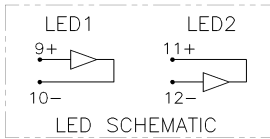
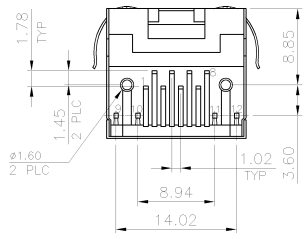

PACKAGE	TRAY	INDICATOR COLOR		MIN. GOLD THICKNESS	PART NUMBER
		POSITION 2	POSITION 1		
⚠️ OBSOLETE	⚠️ OBSOLETE	YELLOW	GREEN	50μ"	5-1734324-8
		YELLOW	GREEN	30μ"	5-1734324-7
⚠️ OBSOLETE	⚠️ OBSOLETE	GREEN	YELLOW	15μ"	5-1734324-6
		GREEN	YELLOW	6μ"	5-1734324-5
⚠️ OBSOLETE	⚠️ OBSOLETE	GREEN	YELLOW	50μ"	5-1734324-4
		GREEN	YELLOW	30μ"	5-1734324-3
⚠️ OBSOLETE	⚠️ OBSOLETE	GREEN	YELLOW	15μ"	5-1734324-2
		GREEN	YELLOW	6μ"	5-1734324-1

THIS DRAWING IS A CONTROLLED DOCUMENT.

DIMENSIONS: MM	TOLERANCES UNLESS OTHERWISE SPECIFIED:	DWN: A. WU 04MAR2008	Tyco Electronics Tyco Electronics Corporation Taipei, Taiwan	
0 PLC ± 0.50	1 PLC ± 0.38	CHK: S. HOU 04MAR2008	NAME: MODULAR JACK, RJ45, 8P8C, WITH LED & SHIELD, DIP, REVERSE VERSION	
2 PLC ± 0.25	3 PLC ± 0.10	APVD: W. KODAMA 04MAR2008	SIZE: A3 CAGE CODE: 00779 DRAWING NO: 1734324	
4 PLC ± -	ANGLES ± -	PRODUCT SPEC: 108-57535	RESTRICTED TO: -	
MATERIAL: SEE NOTE	FINISH: SEE NOTE	QUALIFICATION TEST REPORT: 501-57628	SCALE: - SHEET: 4 of 7 REV: A1	
CUSTOMER DRAWING		WEIGHT: 4.5 GRAMS	DRAWING NO: 1734324	

4

3

2

1

THIS DRAWING IS UNPUBLISHED. RELEASED FOR PUBLICATION  
 COPYRIGHT © BY TYCO ELECTRONICS CORPORATION. ALL RIGHTS RESERVED.

LOC	DIST	REVISIONS			
P	LTR	DESCRIPTION	DATE	DWN	APVD
SEE SHEET 1.					

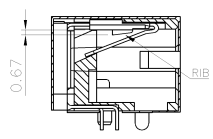

SECTION A-A

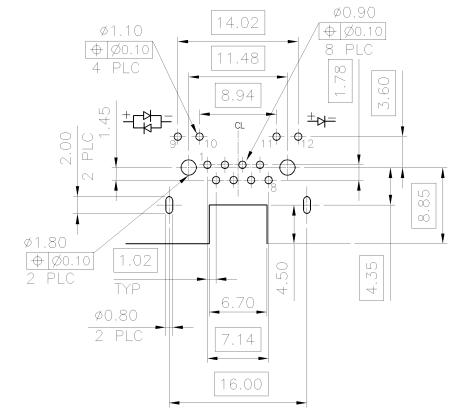
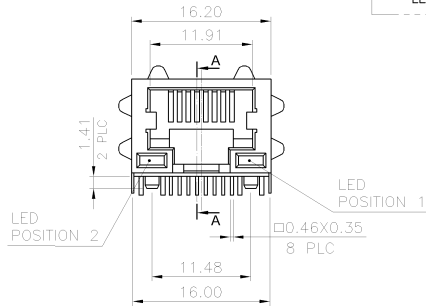
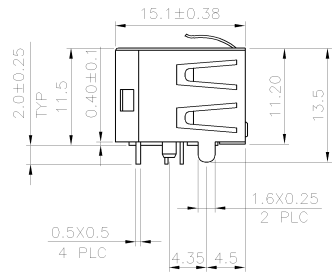
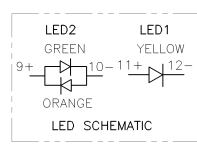
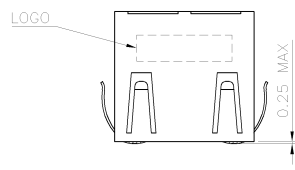

RECOMMENDED PCB LAYOUT (THICKNESS: 1.6mm)  
 DIMENSION TOLERANCE: 1 PLC: ±0.1 2PLC: ±0.05

- NOTE:
- MATERIAL:  
HOUSING: PA9T WITH 30% GF, UL 94V-0, BLACK COLOR.  
CONTACTS: PHOSPHOR BRONZE.  
LED LIGHT: EPOXY RESIN.  
SHELL: BRASS.
  - FINISH:  
CONTACTS: (SEE TABLE) GOLD PLATED ON CONTACT AREA, GOLD FLASH ON SOLDER TAILS, WITH ENTIRE CONTACT UNDERPLATED 1.27µm [50µ"] MIN. NICKEL.  
LED: 1.65µm [65µ"] MIN. Ag PLATED.  
2.16µm [85µ"] MIN. TIN PLATED.  
FORWARD CURRENT: 20mA.  
FORWARD VOLTAGE: 2.2 VOLTS TYPICAL.  
SHELL: 0.50µm [20µ"] MIN. NICKEL PLATED.
  - LED MUST BE REFLOW COMPATIBLE TO FOLLOWING TEMPERATURE PROFILE (FOR 1 CYCLE): ABOVE 160°C FOR 120 SECONDS, PEAKING AT 220°C FOR 10 SECONDS.
  - LED DEFECT RATE IS 6000 PPM MAX. AFTER IR REFLOW PROCESS AS NOTE 3.
  - REFLOW SOLDER CAPABLE TO 260°C PER TE SPEC. 109-201, CONDITION B.

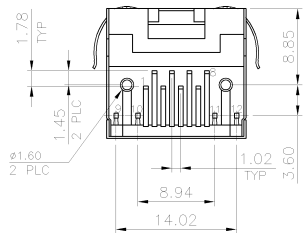

TAPE & REEL	GREEN & ORANGE	YELLOW	50µ"	6-1734324-8
			30µ"	6-1734324-7
			15µ"	6-1734324-6
			6µ"	6-1734324-5
			50µ"	6-1734324-4
			30µ"	6-1734324-3
			15µ"	6-1734324-2
			6µ"	6-1734324-1
PACKAGE	POSITION 2	POSITION 1	MIN. GOLD THICKNESS	PART NUMBER

THIS DRAWING IS A CONTROLLED DOCUMENT.

DIMENSIONS: MM	TOLERANCES UNLESS OTHERWISE SPECIFIED:	DWN: A. WU 04MAR2008	Tyco Electronics Tyco Electronics Corporation Taipei, Taiwan	
	0 PLC ± 0.50	CHK: S. HOU 04MAR2008	NAME: MODULAR JACK, RJ45, 8P8C, WITH LED & SHIELD, DIP, REVERSE VERSION	
	1 PLC ± 0.38	APVD: W. KODAMA 04MAR2008	SIZE: A3 CAGE CODE: 00779 DRAWING NO: 1734324	
	2 PLC ± 0.25	RESTRICTED TO: ---		
	3 PLC ± 0.10	SCALE: --- SHEET: 5 of 7 REV: A1		
4 PLC ± --	4 PLC ANGLES ± --	CUSTOMER DRAWING		
MATERIAL: SEE NOTE	FINISH: SEE NOTE	WEIGHT: 4.5 GRAMS		

4

3

2

1

THIS DRAWING IS UNPUBLISHED. RELEASED FOR PUBLICATION  
 © COPYRIGHT - ALL RIGHTS RESERVED.

LOC	DIST	REVISIONS				
P	LTR	DESCRIPTION	DATE	DWN	APVD	
DW	-	SEE SHEET 1.				

D  
C  
B  
A

D  
C  
B  
A

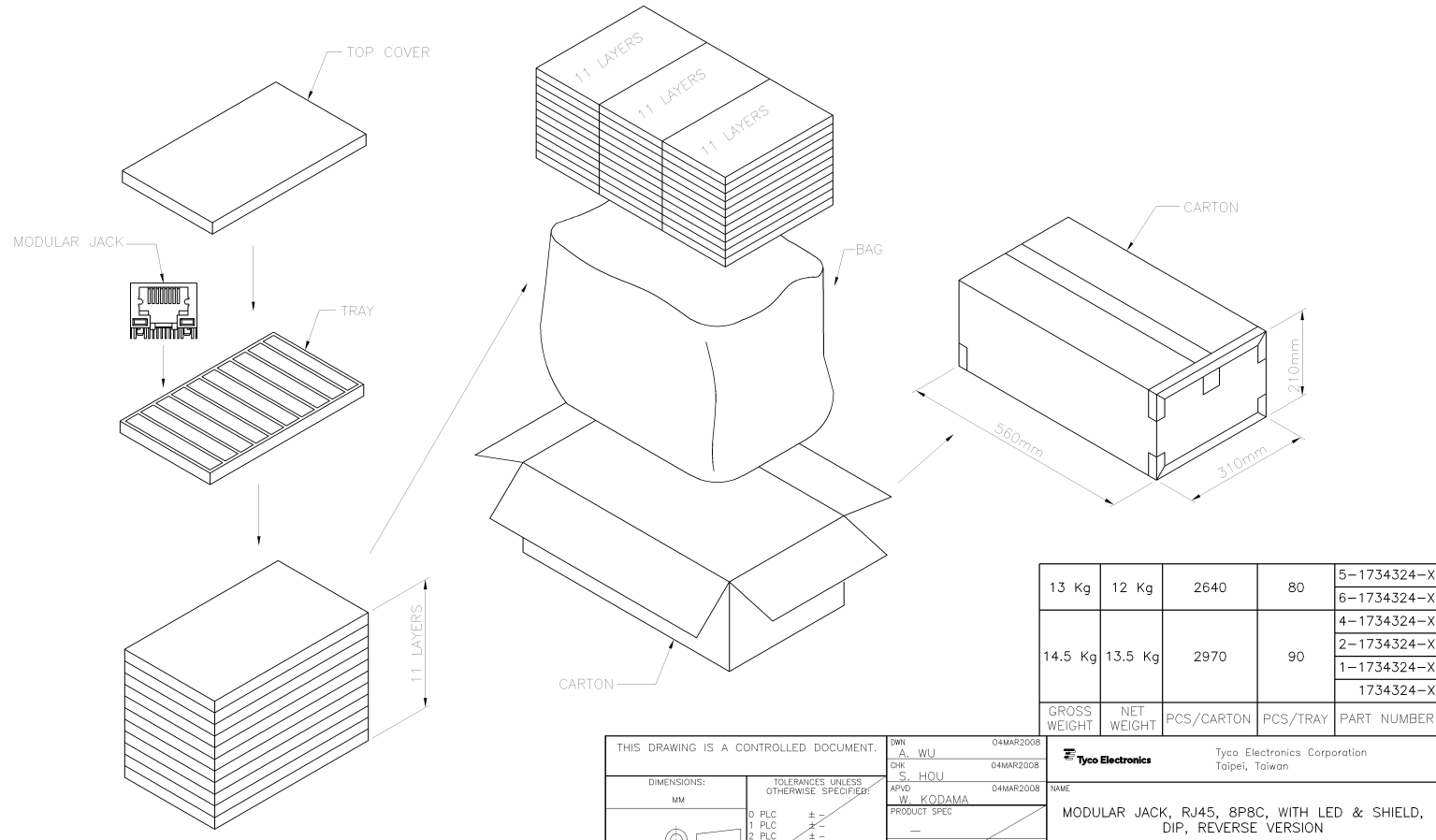

THIS DRAWING IS A CONTROLLED DOCUMENT.		DWN A. WU 04MAR2008	Tyco Electronics Tyco Electronics Corporation Taipei, Taiwan	
DIMENSIONS: MM	TOLERANCES UNLESS OTHERWISE SPECIFIED:	CHK S. HOU 04MAR2008	NAME W. KODAMA 04MAR2008	
	0 PLC ± -	PRODUCT SPEC	MODULAR JACK, RJ45, 8P8C, WITH LED & SHIELD, DIP, REVERSE VERSION	
	1 PLC ± -	APPLICATION SPEC	SIZE A3	CAGE CODE 00779
	2 PLC ± -	WEIGHT	DRAWING NO C-1734324	RESTRICTED TO
	3 PLC ± -			
	4 PLC ± -			
MATERIAL	FINISH	CUSTOMER DRAWING	SCALE	SHEET 6 of 7 REV A1

4

3

2

1

THIS DRAWING IS UNPUBLISHED. RELEASED FOR PUBLICATION  
 © COPYRIGHT - ALL RIGHTS RESERVED.

LOC	DIST	REVISIONS				
P	LTR	DESCRIPTION	DATE	DWN	APVD	
DW	-	SEE SHEET 1.				

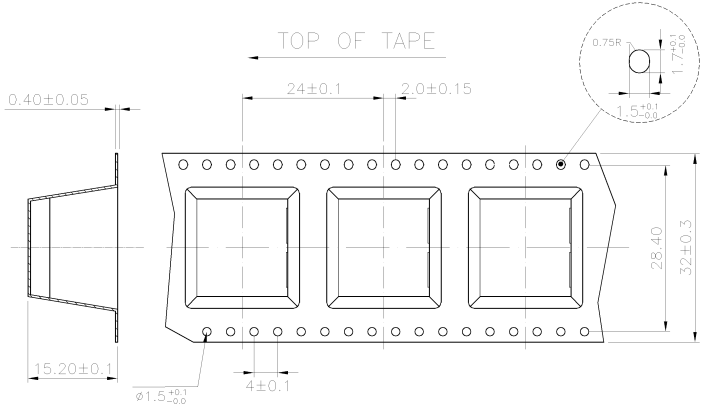
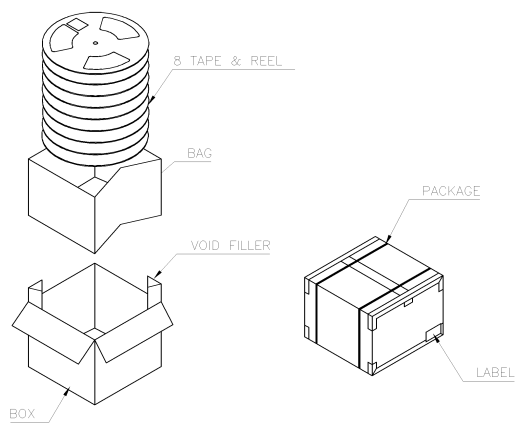
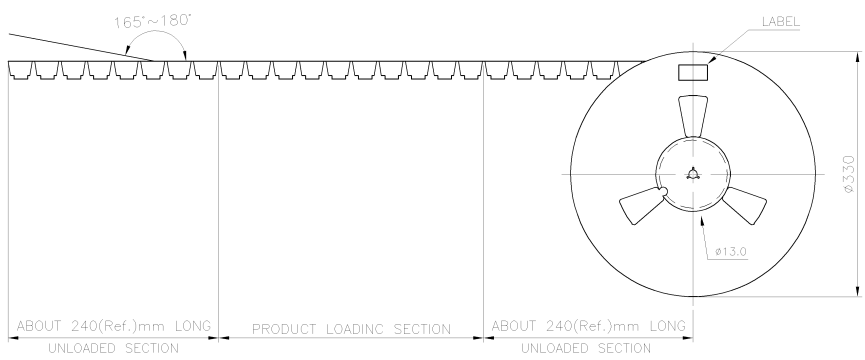

8.5 Kg	6.5 Kg	180	8	1440 PCS
GROSS WEIGHT	NET WEIGHT	PCS/REEL	REELS /BOX	QUANTITY

THIS DRAWING IS A CONTROLLED DOCUMENT.		DWN A. WU 04MAR2008	Tyco Electronics Tyco Electronics Corporation Taipei, Taiwan	
DIMENSIONS: MM	TOLERANCES UNLESS OTHERWISE SPECIFIED:	CHK S. HOU 04MAR2008	NAME W. KODAMA 04MAR2008	
	0 PLC ± - 1 PLC ± - 2 PLC ± - 3 PLC ± - 4 PLC ± - ANGLES ± -	APVD W. KODAMA 04MAR2008	PRODUCT SPEC -	
MATERIAL	FINISH	APPLICATION SPEC -	MODULAR JACK, RJ45, 8P8C, WITH LED & SHIELD, DIP, REVERSE VERSION	
		WEIGHT -	SIZE A3	RESTRICTED TO -
		CUSTOMER DRAWING	CAGE CODE 00779	DRAWING NO 1734324
		SCALE -	SHEET 7 of 7	REV A1

AMP 1470-19 REV 31MAR2000