

4

3

2

1

THIS DRAWING IS UNPUBLISHED. RELEASED FOR PUBLICATION
 COPYRIGHT 2010 BY TYCO ELECTRONICS CORPORATION. ALL RIGHTS RESERVED.
 LOC DIST DW

REVISIONS		DATE	DWN	APVD	
P	LTR	DESCRIPTION	DATE	DWN	APVD
C4		REVISED (ECR-11-005224, ADD PN 5-1734577-4)	11MAR'11	E.L.	W.K.

LED SCHEMATIC	
LED1	LED2
GREEN	YELLOW
9-	11-
+10	+12
FOR 1734577-X	

LED SCHEMATIC	
LED1	LED2
GREEN	GREEN
9-	11-
+10	+12
FOR 1-1734577-X	

LED SCHEMATIC	
LED1	LED2
RED	RED
GREEN	GREEN
9-	11-
+10	+12
FOR 2-1734577-X	

LED SCHEMATIC	
LED1	LED2
YELLOW	GREEN
ORANGE	
9-	11-
+10	+12
FOR 4-1734577-1	

LED SCHEMATIC	
LED1	LED2
RED	RED
YELLOW	GREEN
9-	11-
+10	+12
FOR 5-1734577-X	

- NOTE:
- MATERIAL:
 - HOUSING: PA46, WITH 30% GF, UL94 V-0, BLACK COLOR.
 - CONTACTS: PHOSPHOR BRONZE.
 - SHELL: BRASS.
 - LED SOLDER TAIL: STEEL.
 - FINISH:
 - CONTACTS: (SEE TABLE) GOLD PLATED ON CONTACT AREA, GOLD FLASH ON SOLDER TAIL AREA, 1.27um [50u"] MIN. NICKEL UNDERPLATING OVERALL. SHELL: 0.508um [20u"] MIN. NICKEL PLATED.
 - a POST DIPPED WITH TIN ON PCB GROUND TABS.
 - LED SOLDER TAIL: 2.159um [85u"] MIN. BRIGHT-TIN PLATED.
 - LED MUST BE REFLOW COMPATIBLE TO FOLLOWING TEMPERATURE PROFILE (FOR 1 CYCLE): ABOVE 160°C FOR 120 SECONDS, PEAKING AT 245°C FOR 20~40 SECONDS.
 - LED DEFECT RATE IS 6000PPM MAX. AFTER IR REFLOW PROCESS AS NOTE 3.
 - WAVE SOLDER CAPABLE TO 265°C PER TE SPEC 109-202, CONDITION B.
 - OBsolete PARTS: OBsolete CIS STREAMLINING PER D.RENAUD/D.SINISI

MODULAR JACK WITH LED

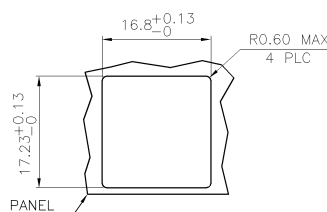
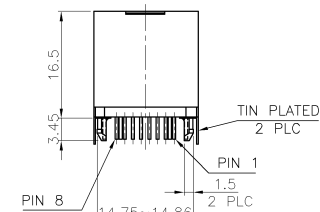
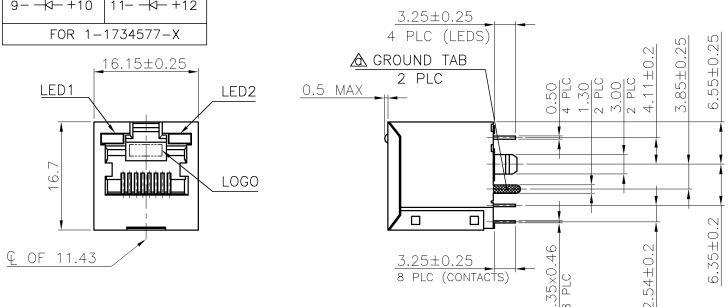

RECOMMENDED SUGGESTED PANEL CUTOUT

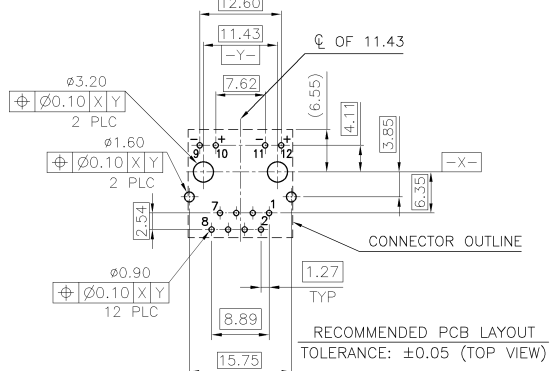

INDICATOR COLOR	LED2	LED1	MIN. GOLD THICKNESS	PART NUMBER
RED/GREEN	RED/YELLOW	1.27um [50u"]	5-1734577-4	
GREEN/ORANGE	YELLOW	0.762um [30u"]	4-1734577-1	
OBsolete	RED/GREEN	1.27um [50u"]	2-1734577-4	
	RED/GREEN	0.762um [30u"]	2-1734577-3	
OBsolete	RED/GREEN	0.381um [15u"]	2-1734577-2	
	GREEN	GREEN	0.152um [6u"]	2-1734577-1
OBsolete	GREEN	GREEN	1.27um [50u"]	1-1734577-4
	GREEN	GREEN	0.762um [30u"]	1-1734577-3
YELLOW	GREEN	0.381um [15u"]	4-1734577-2	
	GREEN	GREEN	0.152um [6u"]	1-1734577-1
YELLOW	GREEN	1.27um [50u"]	1734577-4	
	GREEN	GREEN	0.762um [30u"]	1734577-3
YELLOW	GREEN	0.381um [15u"]	1734577-2	
	GREEN	GREEN	0.152um [6u"]	1734577-1

THIS DRAWING IS A CONTROLLED DOCUMENT.

DIMENSIONS:	TOLERANCES UNLESS OTHERWISE SPECIFIED:	DWN B. HSING 21JUL2009	TE Connectivity MODULAR JACK CONNECTOR RJ45, 8P8C, VERTICAL, DIP TYPE
mm	0 PLC ±	CHK S. CHIEN 21JUL2009	
	1 PLC ±0.3	APVD W. KODAMA 21JUL2009	
	2 PLC ±0.2		
	3 PLC ±0.15		PRODUCT SPEC
	4 PLC ±		APPLICATION SPEC
	ANGLES ±°		
MATERIAL	FINISH	SIZE	CAGE CODE
SEE NOTE	SEE NOTE	A3	00779
		DRAWING NO	108-57527
		RESTRICTED TO	1734577
		SCALE	1 of 3
		SHEET	REV C4

CUSTOMER DRAWING

4

3

2

1

THIS DRAWING IS UNPUBLISHED. RELEASED FOR PUBLICATION
 © COPYRIGHT 2010 BY TYCO ELECTRONICS CORPORATION. ALL RIGHTS RESERVED.

LOC	DIST	REVISIONS			
P	LTR	DESCRIPTION	DATE	DWN	APVD
SEE SHEET 1.					

MODULAR JACK WITHOUT LED

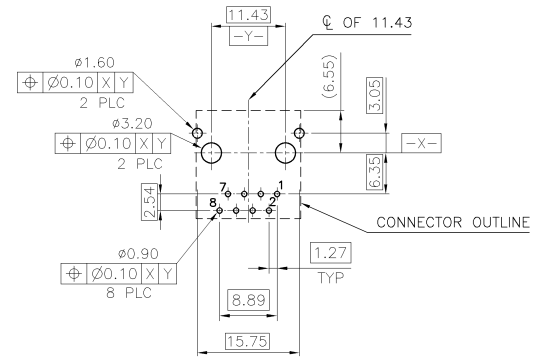
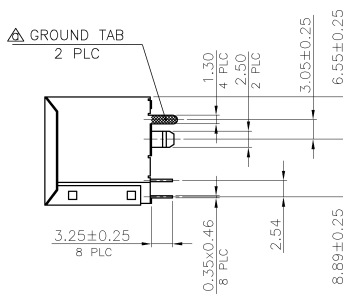
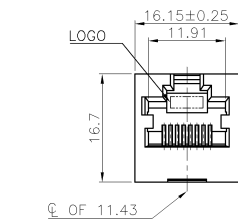

RECOMMENDED PCB LAYOUT
 TOLERANCE: ±0.05 (TOP VIEW)

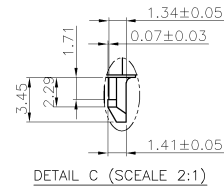
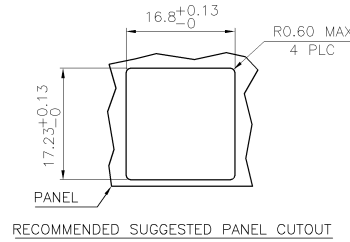
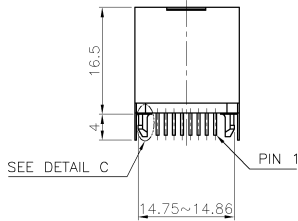

- NOTE:
- MATERIAL:
 HOUSING: PA46, WITH 30% GF, UL94 V-0, BLACK COLOR.
 CONTACTS: PHOSPHOR BRONZE.
 SHELL: BRASS.
 - FINISH:
 CONTACTS: (SEE TABLE) GOLD PLATED ON CONTACT AREA,
 GOLD FLASH ON SOLDER TAIL,
 WITH ENTIRE CONTACT UNDERPLATED
 1.27µm [50µ"] MIN. NICKEL.
 SHELL: 0.508µm [20µ"] MIN. NICKEL PLATED.
 POST DIPPED WITH TIN ON PCB GROUND TABS.
 - WAVE SOLDER CAPABLE TO 265°C PER TE SPEC 109-202, CONDITION B.
 - OBsolete PARTS: OBSOLETE CIS STREAMLINING PER D.RENAUD/D.SINISI

MIN. GOLD THICKNESS	PART NUMBER
1.27µm [50µ"]	3-1734577-5
1.27µm [50µ"]	3-1734577-4
0.762µm [30µ"]	3-1734577-3
0.381µm [15µ"]	3-1734577-2
0.152µm [6µ"]	3-1734577-1

THIS DRAWING IS A CONTROLLED DOCUMENT.		DWN	 TE Connectivity MODULAR JACK CONNECTOR RJ45, 8P8C, VERTICAL, DIP TYPE		RESTRICTED TO
DIMENSIONS: mm		CHK			NAME
TOLERANCES UNLESS OTHERWISE SPECIFIED:		APVD			PRODUCT SPEC
0 PLC ± - 1 PLC ± 0.3 2 PLC ± 0.2 3 PLC ± 0.15 4 PLC ± - ANGLES ± °		APPLICATION SPEC			SIZE
MATERIAL	FINISH	WEIGHT	CAGE CODE	DRAWING NO	RESTRICTED TO
		6.7 GRAMS	A300779	C-1734577	
		CUSTOMER DRAWING	SCALE	SHEET	REV
				2 of 3	C4

4

3

2

1

THIS DRAWING IS UNPUBLISHED. RELEASED FOR PUBLICATION
 © COPYRIGHT 2010 BY TYCO ELECTRONICS CORPORATION. ALL RIGHTS RESERVED.

LOC	DIST	REVISIONS				
P	LTR	DESCRIPTION	DATE	DWN	APVD	
		SEE SHEET 1.				

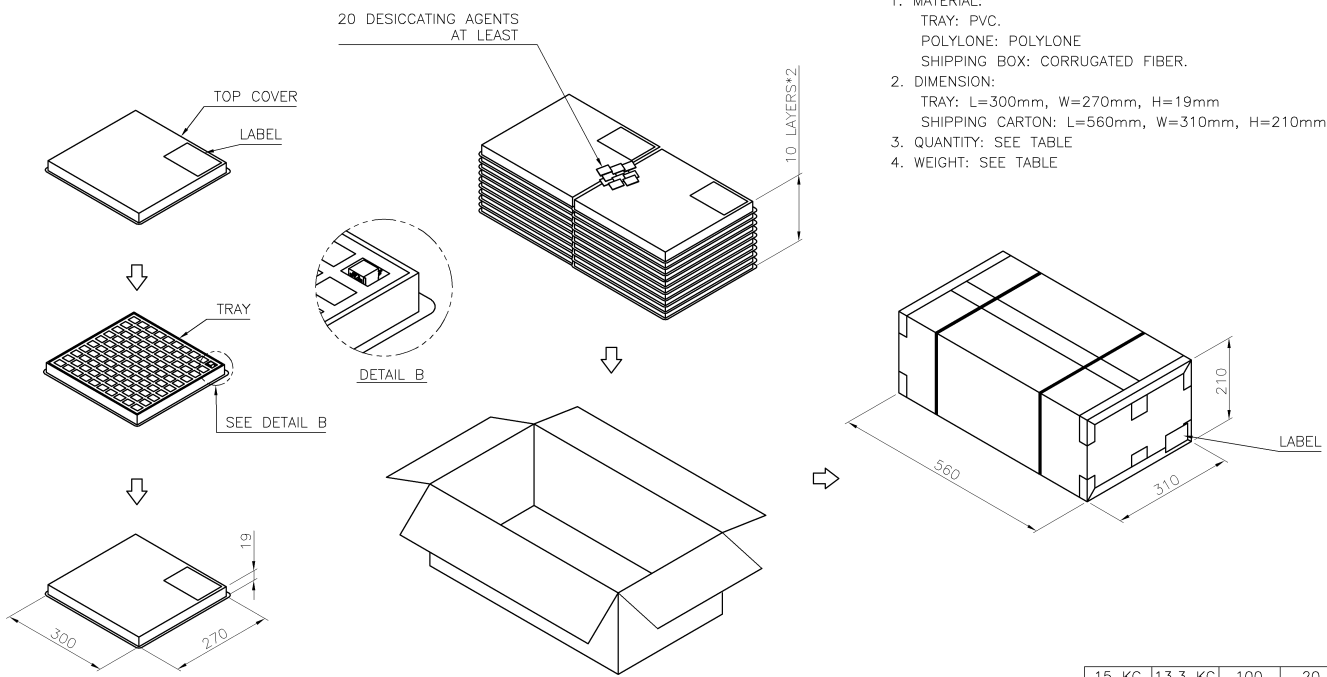

- NOTES:
- MATERIAL:
 TRAY: PVC.
 POLYLONE: POLYLONE
 SHIPPING BOX: CORRUGATED FIBER.
 - DIMENSION:
 TRAY: L=300mm, W=270mm, H=19mm
 SHIPPING CARTON: L=560mm, W=310mm, H=210mm
 - QUANTITY: SEE TABLE
 - WEIGHT: SEE TABLE

15 KG	13.3 KG	100	20	2000
GROSS WEIGHT	NET WEIGHT	PCS/TRAY	TRAY/BOX	PCS/BOX

THIS DRAWING IS A CONTROLLED DOCUMENT.

DIMENSIONS: mm	TOLERANCES UNLESS OTHERWISE SPECIFIED: 0 PLC ± 1 PLC ±0.3 2 PLC ±0.2 3 PLC ±0.15 4 PLC ± ANGLES ±°	DWN CHK APVD PRODUCT SPEC APPLICATION SPEC WEIGHT	NAME TE Connectivity MODULAR JACK CONNECTOR RJ45, 8P8C, VERTICAL, DIP TYPE
MATERIAL	FINISH	SIZE A3	CAGE CODE 00779
		DRAWING NO C-1734577	RESTRICTED TO
CUSTOMER DRAWING		SCALE	SHEET 3 of 3 REV C4