

4

3

2

1

THIS DRAWING IS UNPUBLISHED. RELEASED FOR PUBLICATION
 © COPYRIGHT BY TYCO ELECTRONICS CORPORATION. ALL RIGHTS RESERVED.

LOC	DIST	REVISIONS					
		F	LTR	DESCRIPTION	DATE	OWN	APPD
H	-	H	-	EH-1382-98	19-05-98	EVE	-
		J	-	SR10-0095-03	24-03-03	KV	-
		K	-	ECR-06-013127	31-05-06	MO	-

NOTES:

1. FOR APPLICATION INFORMATION SEE AMP SPEC. 114-19019.
 2. FOR PERFORMANCE REQUIREMENTS SEE AMP SPEC. 108-19064.
 3. TOLERANCES UNLESS OTHERWISE SPECIFIED: ±0.15.
- ⚠ FOR THIS PACKAGING METHOD THE TRUE POSITION OF THE SOLDER TINES IS NOT GUARANTEED.

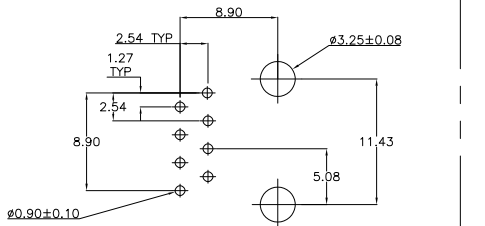
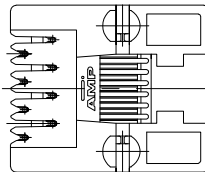
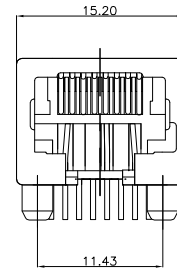
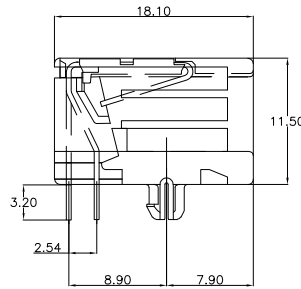
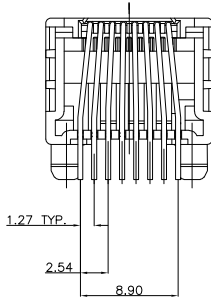
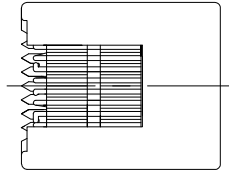

PRINTED CIRCUIT BOARD LAYOUT
 VIEW SHOWN IS CIRCUIT (NONCOMPONENT) SIDE OF BOARD.
 PRINTED CIRCUIT BOARD THICKNESS: 1.6 mm NOMINAL.
 TOLERANCES UNLESS OTHERWISE SPECIFIED:

⚠ 1000 PIECES BULK PACKAGED	8 POS./8 CONTACTS	1.2µm MIN. SEL. GOLD OVER 1.2µm MIN. NICKEL. SOLDER TINES: 2.5µm MIN. TIN OVER 1.2µm MIN. NICKEL.	HOUSING COLOR BLACK: PBT, UL 94V-0 CONTACT INSERT: PBT, UL 94V-0 CONTACTS: Ph BRONZE	2-215878-1
TAPE MOUNTED 700 PCS./REEL				215878-1
PACKAGING	REMARKS	FINISH	MATERIAL	ORDER NUMBER

THIS DRAWING IS A CONTROLLED DOCUMENT.		DIM: C.A. STERKEN CHK: W. BRUMMANS APD: L.V. SOEST PRODUCT SPEC: - APPLICATION SPEC: - WEIGHT: -	15 NOV 98 Tyco Electronics Corporation s-Hertogenbosch, Nederland.
DIMENSIONS: MM 0 P.L.C. ± - 1 P.L.C. ± - 2 P.L.C. ± - 3 P.L.C. ± - 4 P.L.C. ± - ANGLES: ± -	TOLERANCES UNLESS OTHERWISE SPECIFIED: 0 P.L.C. ± - 1 P.L.C. ± - 2 P.L.C. ± - 3 P.L.C. ± - 4 P.L.C. ± - ANGLES: ± -	SIZE: A2 CASE CODE: 00779 DRAWING NO: C-215878 CUSTOMER DRAWING	MODULAR JACK, 8 POS. 90° LOW PROFILE FOR PRINTED CIRCUIT BOARD RESTRICTED TO: - SCALE: - SHEET: 1 OF 1 REV: K

215878

A