

REVISIES		DATE	BY
LTR	DESCRIPTION		
A	EH10-0183-05	10 FEB 05	JvdH
-	-	-	-
-	-	-	-

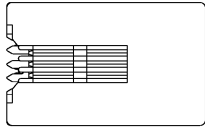

NOTE:  
 1 TOLERANCE UNLESS OTHERWISE SPECIFIED: ±0,15mm.

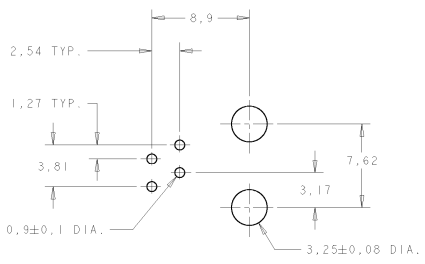
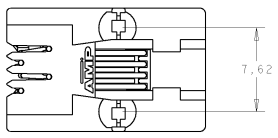
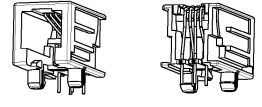
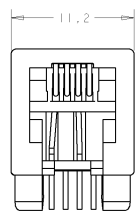
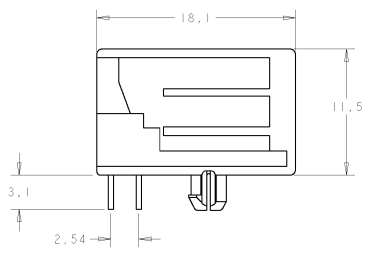
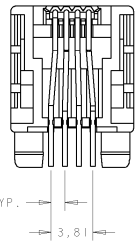

PRINTED CIRCUIT BOARD LAYOUT  
 (VIEW SHOWN IS CIRCUIT (NONCOMPONENT) SIDE OF BOARD.)  
 PRINTED CIRCUIT BOARD THICKNESS: 1,0 mm NOMINAL.  
 TOLERANCE UNLESS OTHERWISE SPECIFIED: ±0,05.

IN CONTACT AREA: 0,15µm SEEL, GOLD FLASH; OVER 1,2µm MIN. NICKEL; SOLDER FINISH; 2,5µm MIN. TIN; OVER 1,2µm MIN. NICKEL.	HOUSING, COLOR BLACK: PBT 20% GF, UL 94V-0 CONTACT INSERT: PBT, UL 94V-0 CONTACTS: PH. BRONZE	200 PCS IN A TRAY TAPE MOUNTED 1000 pcs./tray	1-1705949-1 1705949-1
FINISH	MATERIAL	PACKAGING	PARTNUMBER

THIS DRAWING IS A CONTROLLED DOCUMENT. For Tyco Electronics Nederland B.V. the applicable standard is EN 9100. For all other details, see the applicable standard of the relevant authority.		SAE JVDHELDEN	AMP Tyco Electronics Nederland B.V. 1705949-1
DIMENSIONS: mm		CHK P.WILLENS	DATE 1705949-1
SYMBOLS: 0 PLC 1 PLC 2 PLC 3 PLC 4 PLC 5 PLC 6 PLC 7 PLC 8 PLC 9 PLC ANGLES R R		PRODUCT SPEC JBR0CKSTEEG	DESCRIPTION MODULAR JACK SIDE ENTRY 4/4 FOR PRINTED CIRCUIT BOARD.
MATERIAL		APPLIC. SPEC 14-18019	WEIGHT A2 00779
FINISH		SCALE 4:1	SHEET 1 OF 1
		REV. NO. 00779	REV. A