

10 9 8 7 6 5 4 3 2 1

NOTES:
 1.MATERIAL:
 METAL SHELL: BRASS
 HOUSING: HIGH TEMP THERMOPLASTIC,UL94V-0,COLOR:BLACK
 INSERT: HIGH TEMP THERMOPLASTIC,UL94V-0,COLOR:BLACK
 TERMINAL: PHOSPHOR BRONZE
 2.PLATING:
 TERMINAL:
 CONTACT AREA: GOLD(Au),THICKNESS=50 MICROINCH/1.27 MICROMETER
 SOLDER TAIL: TIN(Sn),THICKNESS=100 MICROINCH MINIMUM,
 UNDER PLATE: NICKEL (Ni).
 METAL SHELL:
 SOLDER TAIL: TIN(Sn),THICKNESS=100 MICROINCH MINIMUM,
 UNDER PLATE: NICKEL (Ni),(SOLDERING AVAILABLE)
 SURFACE APPEARANCE: BRIGHT.
 3.RECOMMENDED PCB THICKNESS: 1.60±0.05
 4.PRODUCT SPECIFICATION REFER TO PS-48146-001
 5.TEST SUMMARY REFER TO TS-48146-001
 6.PACKAGING SPECIFICATION REFER TO PK-48146-001.
 7.LEAD FREE AND ROHS COMPLIANT PRODUCT.

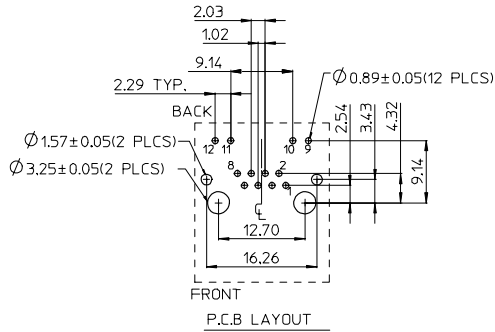
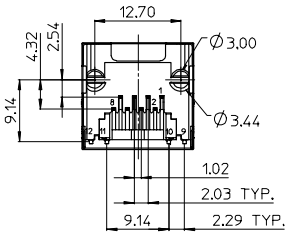
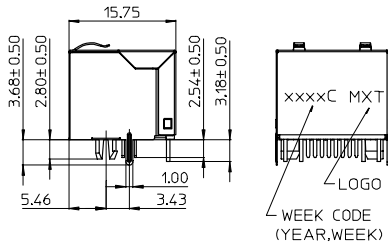
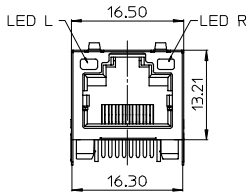

LED ELECTRICAL SPECIFICATION

PARAMETER	GREEN (TYP.)	AMBER (TYP.)	UNITS	TEST CONDITIONS
POWER DISSIPATION	105	100	mW	
REVERSE VOLTAGE	5	5	V	
PEAK WAVELENGTH	565	600	nm	IF=20mA
FORWARD VOLTAGE	2.2 MAX.=2.5	2.1 MAX.=2.5	V	IF=20mA

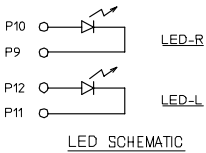

LED SCHEMATIC

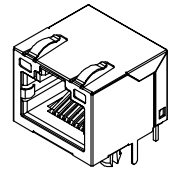
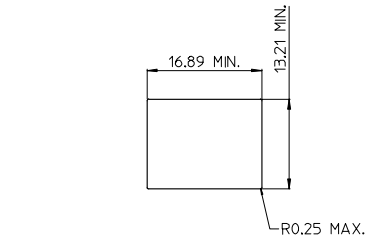

RECOMMENDED PANEL CUTOUT

P/N	LED COLOR	
	LEFT	RIGHT
48146-0001	GREEN	GREEN
48146-0011	GREEN	AMBER
48146-0010	AMBER	GREEN

ADD NEW P/N EC NO. SH2007-0138 DRAWN: LILIN CHKCD: CHIKO APPR: WWSCHANG 2006/09/12 2006/09/13 2006/09/13	QUALITY SYMBOLS	GENERAL TOLERANCES (UNLESS SPECIFIED)	DIMENSION STYLE	SCALE	DESIGN UNITS	THIRD ANGLE PROJECTION																		
	$\nabla=0$ $\nabla=0$	<table border="1"> <tr> <th></th> <th>mm</th> <th>INCH</th> </tr> <tr> <td>4 PLACES</td> <td>± ---</td> <td>± ---</td> </tr> <tr> <td>3 PLACES</td> <td>± ---</td> <td>± ---</td> </tr> <tr> <td>2 PLACES</td> <td>± 0.25</td> <td>± ---</td> </tr> <tr> <td>1 PLACE</td> <td>± 0.25</td> <td>± ---</td> </tr> <tr> <td colspan="3">ANGULAR ± 3°</td> </tr> </table>		mm	INCH	4 PLACES	± ---	± ---	3 PLACES	± ---	± ---	2 PLACES	± 0.25	± ---	1 PLACE	± 0.25	± ---	ANGULAR ± 3°			MM ONLY	1:1	METRIC	
		mm	INCH																					
	4 PLACES	± ---	± ---																					
3 PLACES	± ---	± ---																						
2 PLACES	± 0.25	± ---																						
1 PLACE	± 0.25	± ---																						
ANGULAR ± 3°																								
DESCRIPTION	DRAFT WHERE APPLICABLE MUST REMAIN WITHIN DIMENSIONS	SEE TABLE	TITLE	CATEGORY 5 MODULAR JACK 8 POSITION, 8 CONTACTS																				
REV			MATERIAL NO.	DOCUMENT NO.	MOLEX INCORPORATED																			
			SIZE	SD-48146-001																				
			THIS DRAWING CONTAINS INFORMATION THAT IS PROPRIETARY TO MOLEX INCORPORATED AND SHOULD NOT BE USED WITHOUT WRITTEN PERMISSION																					
						SHEET NO. 1 OF 1																		

9 8 7 6 5 4 3 2 1