

REVISIONS				
SYM	ZONE	ECN, ERN NO.	DATE	APPRD.
A		PROPOSAL	25/01/06	LCHAN

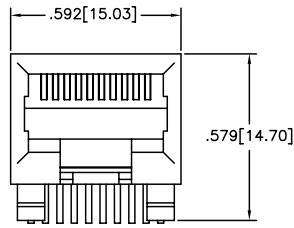

FRONT VIEW

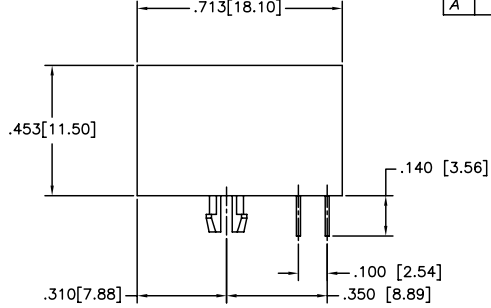

SIDE VIEW

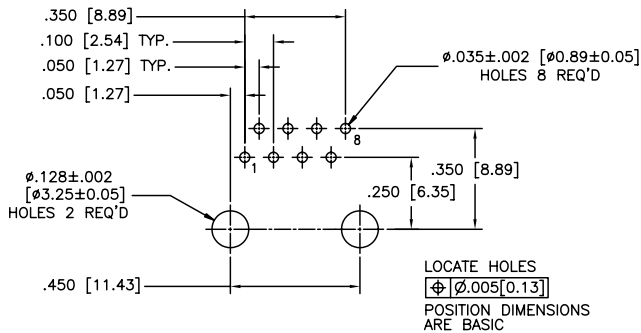

RECOMMENDED P.C.B. LAYOUT  
(COMPONENT SIDE OF BOARD)

**MATERIALS:**

PLASTIC HOUSING: ENGINEERING THERMOPLASTIC  
FLAMMABILITY RATING UL94V-0.

**CONTACTS:**

PHOSPHOR BRONZE  
PLATING: REFER PART NUMBER FOR GOLD  
THICKNESS ON MATING SURFACES.  
50 µ" [1.27 MICRONS]  
MIN. NICKEL UNDERPLATE.  
100 µ" [2.54 MICRONS]  
MIN. MATTE TIN ON CONTACT TAILS.

PART NUMBER: RJE05-188-0X10

**GOLD PLATING**

- 1 = 6 µINCH
- 2 = 15 µINCH
- 3 = 30 µINCH
- 4 = 50 µINCH

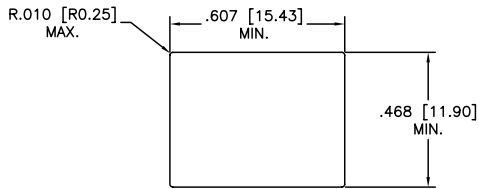

RECOMMENDED PANEL CUTOUT

THIS DOCUMENT CONTAINS PROPRIETARY INFORMATION AND SUCH INFORMATION  
MAY NOT BE DISCLOSED TO OTHERS FOR ANY PURPOSE OR USED FOR MANUFACTURING  
PURPOSES WITHOUT WRITTEN PERMISSION FROM AMPHENOL CANADA CORP.

DRAWN <i>Chigow</i>	DATE <i>25/01/06</i>	<b>Amphenol Canada Corp.</b>
DESIGNED		
CHECKED <i>LCHAN</i>	DATE <i>25/01/06</i>	TITLE RJE05 SERIES MODULAR JACK, 8 POSITION, 8 CONTACTS, UNSHIELDED, ULTRA LOW PROFILE--RoHS COMPLIANT
I. E. APPRD.		
Q. A. APPRD.		DWG DRAWING NO. P-RJE05-188-0X10
DWG. APPRD.		
ENG. REL. NO.		REV. A
REF.		
DIMENSIONS ARE IN <i>mm</i>	CODE ID. NO. 03554	SCALE
		WT. -----
		SURF. -----
		SHEET 1 OF 1