

REV	DATE	DESCRIPTION	BY	CHKD
AA	00			
E	02-08-2008			

- MATERIAL: HOUSING - PBT POLYESTER, COLOR: SEE TABLE  
 TERMINAL - 0.35[.0138] THICK PHOS BRONZE  
 PLATED WITH 1.27μm[.000050] THICK  
 HARD GOLD IN LOCALIZED GOLD PLATE AREA AND  
 2.03μm[.000080] THICK MATTE TIN IN SOLDER  
 AREA OVER 1.27μm[.000050] THICK NICKEL  
 UNDERPLATE.
- CAVITY CONFORMS TO FCC RULES AND REGULATIONS  
 PART 68, SUBPART F.
- BULK PACKAGED IN A TRAY.
- TERMINALS FOR 555165-2, -5 & -8 AND LOCATED IN  
 CENTER POSITIONS.

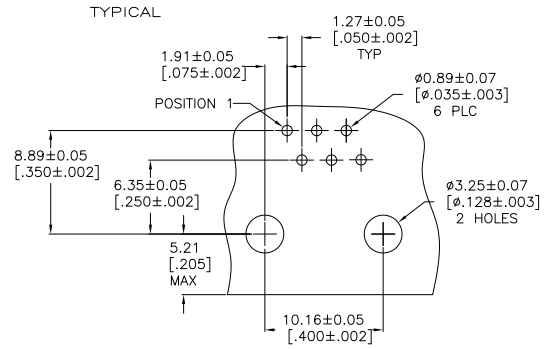
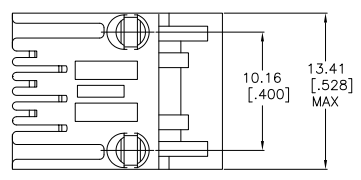
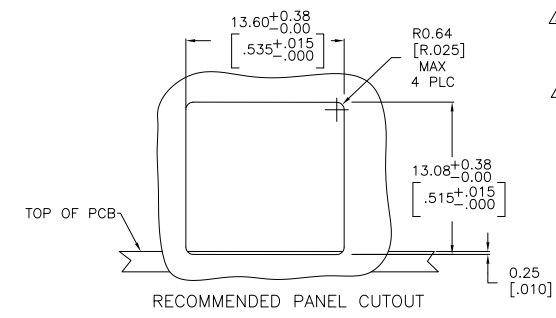
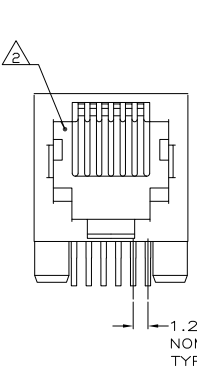
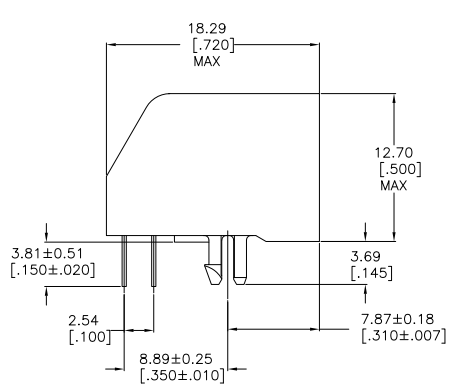

COLOR	TERMINALS REQUIRED	PART NUMBER
DEC GREY	4	555165-8
BLACK	2	555165-5
BLACK	4	555165-2
BLACK	6	555165-1

THIS DRAWING IS A CONTROLLED DOCUMENT.		DATE: 02/08/08		DRAWN BY: J. STEINBERGER		CHECKED BY: J. STEINBERGER		DATE: 02/08/08		DRAWN BY: J. STEINBERGER		CHECKED BY: J. STEINBERGER		DATE: 02/08/08	
DRAWING NO: 114-2048		REV: A		DATE: 02/08/08		DRAWN BY: J. STEINBERGER		CHECKED BY: J. STEINBERGER		DATE: 02/08/08		DRAWN BY: J. STEINBERGER		CHECKED BY: J. STEINBERGER	
CUSTOMER DRAWING		DATE: 02/08/08		DRAWN BY: J. STEINBERGER		CHECKED BY: J. STEINBERGER		DATE: 02/08/08		DRAWN BY: J. STEINBERGER		CHECKED BY: J. STEINBERGER		DATE: 02/08/08	