

THIS DRAWING IS UNPUBLISHED. RELEASED FOR PUBLICATION
 COPYRIGHT 19 BY AMP INCORPORATED. ALL RIGHTS RESERVED.

LOC	DIST	REVISIONS			
P	LTR	DESCRIPTION	DATE	DWN	APVD
C		ADDED 1/1 PER NPR C97-013, EC 0502-0039-97	27JAN97	CW	DW

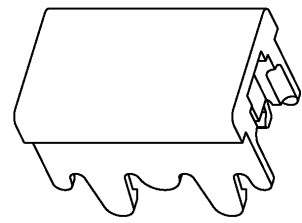
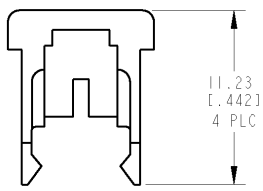
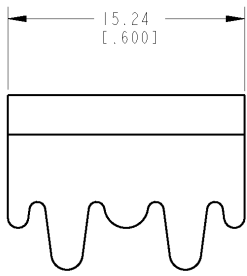

- 1 MATERIAL: POLYPHENYLENE MOLDING COMPOUND, NEMA GRAY.
- 2 PACKAGED 50 LOOSE PIECES PER POLYBAG.
- 3 PACKAGED 2500 LOOSE PIECES PER POLYBAG.

3	1-569332-1
2	569332-1
PACKAGED	PART NO.

<small>THIS DRAWING IS A CONTROLLED DOCUMENT FOR AMP INCORPORATED. IT IS SUBJECT TO CHANGE AND THE CONTROLLING ENGINEERING ORGANIZATION SHOULD BE CONTACTED FOR THE LATEST REVISION.</small>		DWN C. WHITT 23 JAN 97 CHK C. WHITT 23 JAN 97 APVD D. WILLIS 23 JAN 97	AMP AMP Incorporated Harrisburg, PA 17105-3608
DIMENSIONS: mm [INCHES]	TOLERANCES UNLESS OTHERWISE SPECIFIED: 0 PLC ± 1 PLC ± 2 PLC ± 3 PLC ±0.13 [.005] 4 PLC ± ANGLES ±	NAME STUFFER CAP, 110CONNECT PRODUCT SPEC - APPLICATION SPEC - WEIGHT -	SIZE A3 CAGE CODE 00779 DRAWING NO C-569332 RESTRICTED TO -
MATERIAL	FINISH -	CUSTOMER DRAWING	SCALE 4:1 SHEET 1 OF 1 REV C