

REV	ECN NO.	MODIFY CONTENT	DATE
A	ES.D0005.081	RELEASE	5/15-08
B	ES.D0005.042	PLATED SOLDER	05/07-09
C	ES.D0005.074	Modify PCB PAD Long	09/30-09

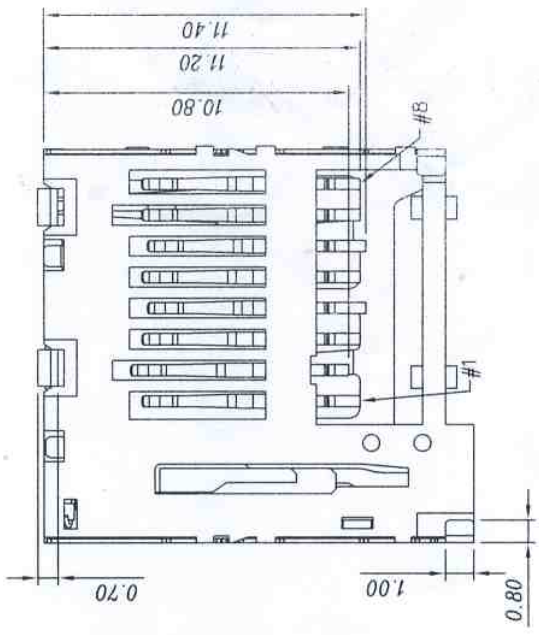

- Notes:
- All Dimensions are in Millimeters.
 - Material:
 - Housing: High Temperature Thermoplastic, UL94V-0, Black
 - Slide: High Temperature Thermoplastic, UL94V-0, Black
 - Contact: Phosphor Bronze
 - Detect Pin: Phosphor Bronze
 - Lock Pin: Stainless steel
 - Plated
 - Contact: 20u"Min, Au Plating in Contact Area
 - 1-3u"Min, Au Plated Solder Tail
 - 50u"Min Ni Under Plated Over All
 - Detect Pin: 1u"Min, Au Plated Over All
 - 50u"Min, Ni Under Plated Over All
 - Shell : 1-3u"Min, Au Plated Solder Tail
 - 50u"Min Ni Under Plated Over All
 - Specification:
 - 4.1. Electrical Characteristics:
 - 4.1.1.0. Contact Resistance: 100mΩ Max.
 - 4.1.1.1. Dielectric Withstanding Voltage: 500VAC Max With 1 Minute
 - 4.2. Mechanical Characteristics:
 - 4.2.1. Insulation Resistance: 1000 MΩ Min.
 - 4.2.2.0. Mating Force: $30N$ Max.
 - 4.2.2.1. Unmating Force: 1~30N.
 - 4.2.2.2. Durability: 10000 Cycles

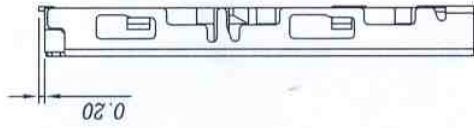
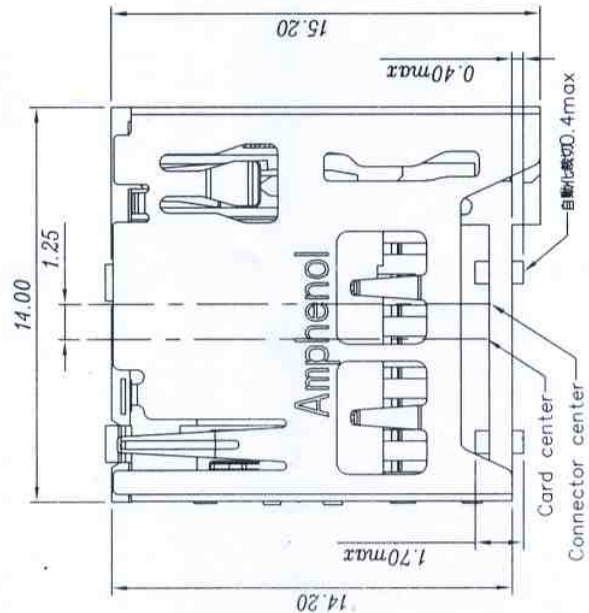
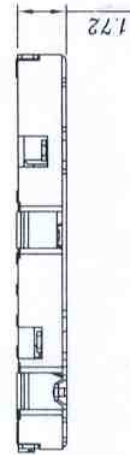
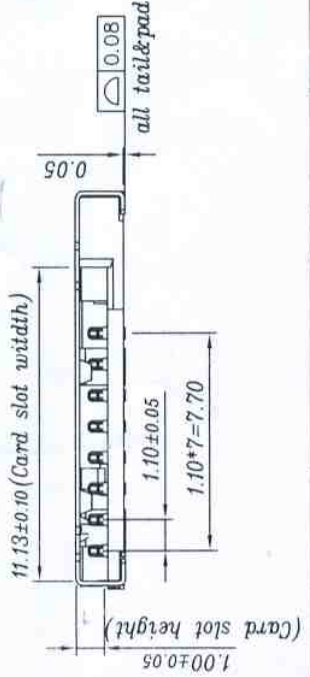

GENERAL	TOLERANCE	FILE NO.	10100581	PART NO.	1010058159	DRAWN	Jane Yu	MATERIAL	SCALE	4:1	
X ± 0.50	x ± 5'	REV.	C	TITLE	MICRO-SD_NORMAL_CLOSED CUSTOMER	CHECKED	<i>Henry Wang</i>	DATE	2009/09/30	UNIT	MM
X ± 0.38	x ± 2'	SIZE	A4	SHEET	1/2	APPROVED	<i>RYG</i>	Amphenol Shouhmin Industry			
XX ± 0.25	xx ± 1'										

REV	ECN NO.	MODIFY CONTENT	DATE
A	ES.D0905.081	RELEASE	5/15-08
B	ES.D0905.042	Modify PCB PAD Long	05/07-09
C	ES.D0905.074	Modify PCB PAD Long	09/30-09

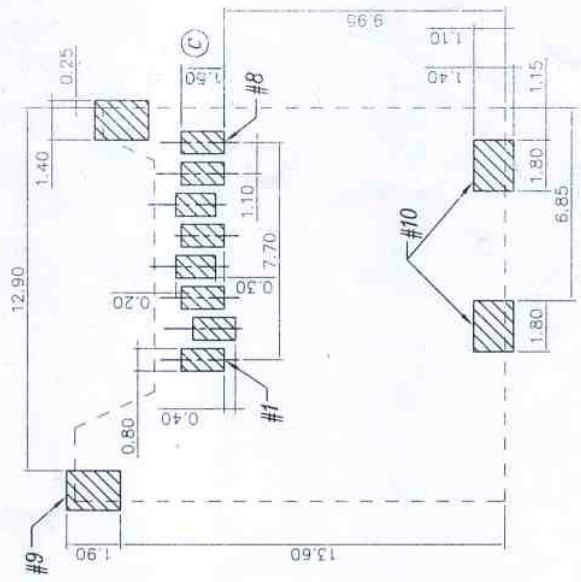

RECOMMENDED PCB LAYOUT
(ALL TOLERANCE IS ±0.05)

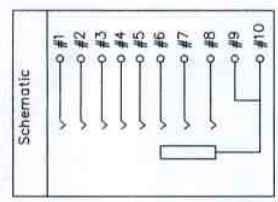
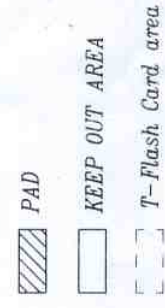

Pin Assignment

PIN NO.	NAME	TYPE	DESCRIPTION
1	DATA2	I/O/PP	DATA LINE(BIT 2)
2	CD/DAT3	I/O/PP	CARD DETECT/DATA LINE(BIT 3)
3	CMD	PP	COMMAND RESPONSE
4	VDD	S	SUPPLY VOLTAGE
5	CLK	I	CLOCK
6	VSS	S	SUPPLY VOLTAGE GROUND
7	DAT0	I/O/PP	DATA LINE(BIT 0)
8	DAT1	I/O/PP	DATA LINE(BIT 1)

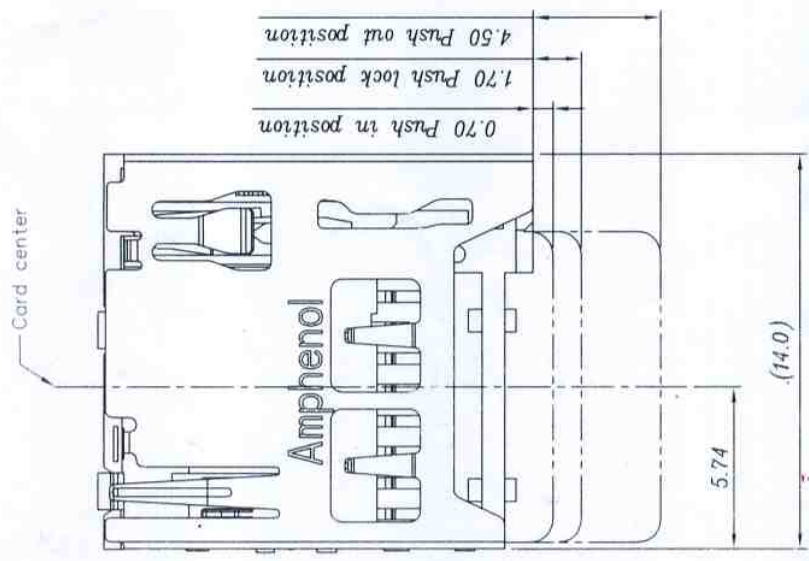

Relation Of Switch To T-Flash Card Attachment Condition

Card Attachment Condition	Card Detect Switch	Situation Depiction
Card Not Attached	Closed	#9
 Short
Card Attached	Open	#9
 Open

GENERAL TOLERANCE	FILE NO.	10100581	PART NO.	1010058159	DRAWN	Jane Yu	MATERIAL	SCALE	4:1	
X ± 0.50	x ± 5°	C	TITLE	MICRO-SD NORMAL CLOSED CUSTOMER	CHECKED	Henry Wang	DATE	2009/09/30	UNIT	MM
X ± 0.38	.x ± 2°		SHEET	2/2	APPROVED	[Signature]	Amphenol Shouhmin Industry			
XX ± 0.25	.xx ± 1°									