

REV.	QUANTITY	MODIFY CONTENT	DATE
B	PC 152030561	MODIFY (B)	2008/12/10
C	PC 1520312046	MODIFY (C)	2009/11/10

- NOTES:
1. MATERIAL: SEE TABLE
 2. PLATING: SEE TABLE
 3. DATE CODE: DAY MONTH YEAR
 4. ROHS COMPLIANT PRODUCT
 5. ELECTRICAL CHARACTERISTICS:
CURRENT RATING: 0.5A
WITHSTANDING VOLTAGE: 500V AC/DC
INSULATION RESISTANCE: 500M OHM MIN.
CONTACT RESISTANCE: 100M OHM MAX.
 6. MECHANICAL CHARACTERISTICS:
MATING CYCLES: 10000 CYCLES
ENVIRONMENTAL:
OPERATING TEMPERATURE: -20°C-80°C

REF. NO.	TOLERANCE	FILE NO.	REV.	SIZE	DATE	SCALE	DRWING	CHECKED	APPROVED	MATERIAL	DATE	QUANTITY	DRWING	SCALE	DATE
4-F-0-50	±0.5°	19100578	REV.	A4	19100578	1:1	Shirley Gao	Jane Yao	Jane Yao	Amphenol Shoufimin Industries	2008/12/10	1	Shirley Gao	1:1	2008/12/10

Jane Yao
2008

Amphenol Shoufimin Industries

REV.	EDN/NO.	APPR. / COMMENT	DATE
B	030502/061	MODIFY (B)	2008/09/24
C	030512/04E	MODIFY (C)	2008/12/10

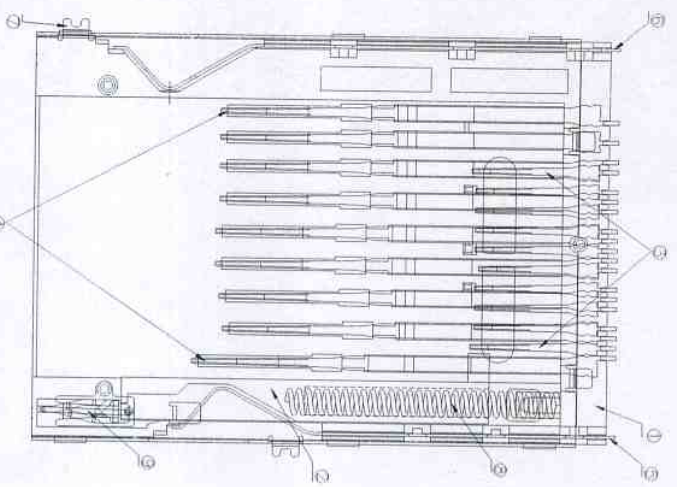

ITEM	TITLE	MATERIAL	PLATING
1	Housing	DURO COPPER FIBER CODE: BUCV/1831-12 ORDER: BUCV/1831-12	
2	Side	NON-DUROS FIBER FILLET ORDER: BUCV/1831-12	
3	MS Terminal	PROPOSED BRONZE	GOOD 15 MICRON PLATE IN CONTACT AREA. PAI PLATED 120 MICROINCHES. NICKEL UNDERPLATING OVERALL.
4	SD Terminal	PROPOSED BRONZE	GOOD 15 MICRON PLATE IN CONTACT AREA. NITRIUM PLATED 120 MICROINCHES ON CONTACT AREA. NICKEL UNDERPLATING OVERALL.
5	CD Terminal	PROPOSED BRONZE	GOOD 15 MICRON PLATE IN CONTACT AREA. NITRIUM PLATED 120 MICROINCHES ON CONTACT AREA. NICKEL UNDERPLATING OVERALL.
6	W/E Terminal	PROPOSED BRONZE	GOOD 15 MICRON PLATE IN CONTACT AREA. NITRIUM PLATED 120 MICROINCHES ON CONTACT AREA. NICKEL UNDERPLATING OVERALL.
7	Metal Shell	STAINLESS STEEL	NICKEL UNDERPLATING OVER ALL
8	Coil Spring	SW65	NICKEL PLATE OVERALL
9	Label	STAINLESS STEEL	
10	Major-1	POURMETRIC	
11	Major-2	POURMETRIC	

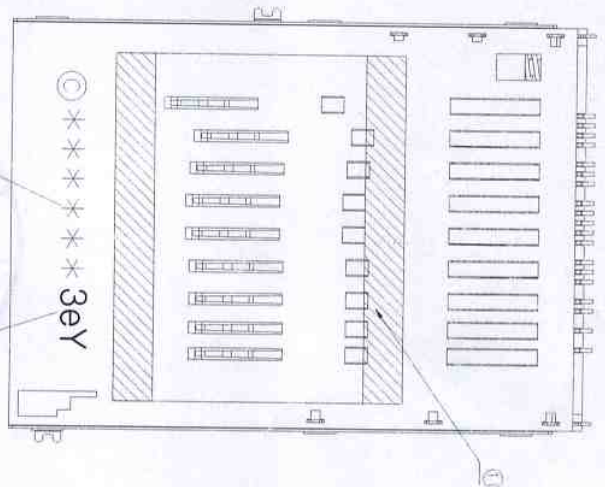

Pin assignments:

Pin No.	FUNCTION	SD/MISC	MS
P1	SD-DAT1	8P	
P2	SD-DAT0	7P	
P3	SD-GND	6P	
P4	MS-GND		1P
P5	MS-BS		2P
P6	SD-CLK	5P	
P7	MS-DAT1		3P
P8	MS-DAT0		4P
P9	SD-VCC		
P10	MS-DAT2		5P
P11	SD-GND		3P
P12	MS-INS		6P
P13	MS-DAT3		7P
P14	SD-CMD		3P
P15	MS-SCLK		8P
P16	MS-VCC		9P
P17	SD-DAT3		1P
P18	MS-GND		10P
P19	SD-DAT2		9P

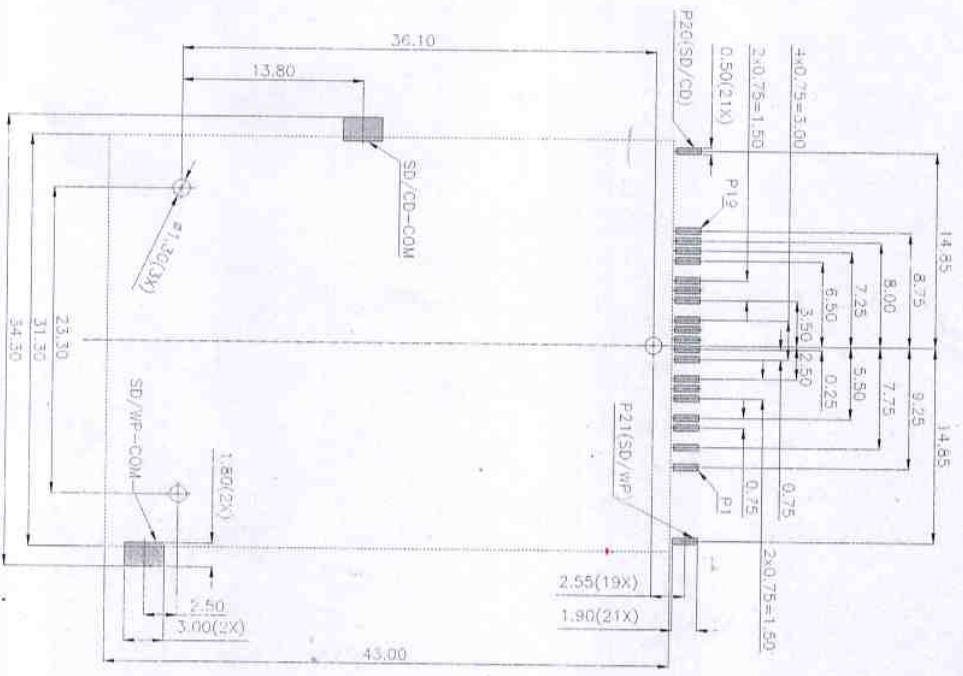

ECB LAYOUT
Note: All tolerance is ±0.05

GENERAL TOLERANCE FILE NO. 10109578

REV. X 1.5' REV. X 1.2' SIZE A4
PART NO. 1010057889 DRAWN Shirley Gao
TITLE 3 in 1 P/P CARO COMB. BOTTOM MOUNT EVEN TYPE CHECKED
SHEET 2 OF 2 APPROVED
DATE 2008/12/10 UNITS MM
SDALE 1:1
Amphenol Shouhmin Industry

Jane 12-08
Shirley Gao