

REVISED FOR FABRICATION		REVISIONS			
REV	BY	DATE	DESCRIPTION	APP'D	CHK'D
1	K		REVISED PER ECR-10-007858		LSF

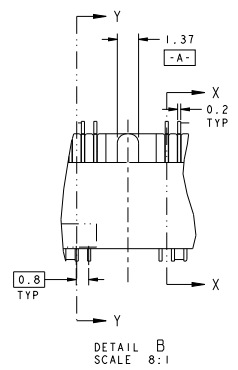
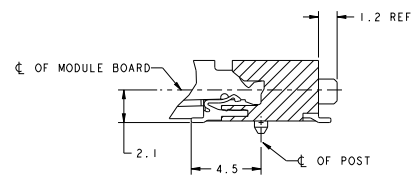
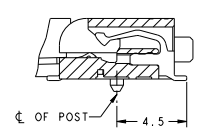
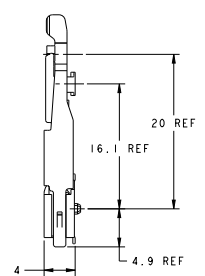
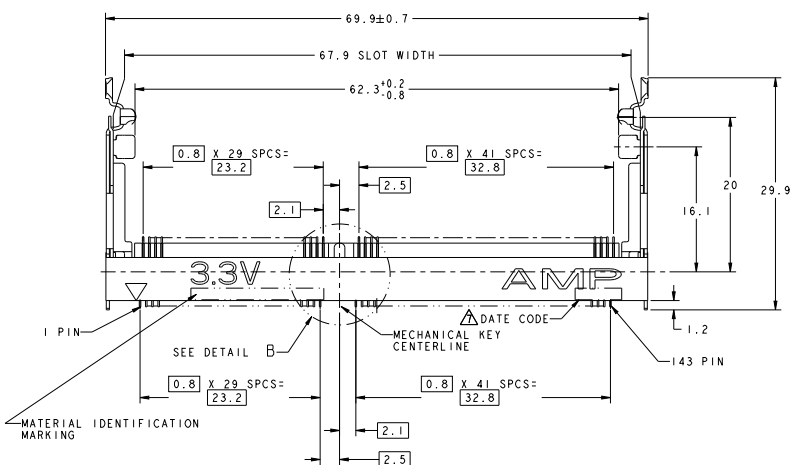
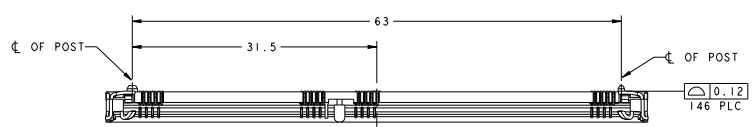

- △ MATERIAL, HOUSING, HIGH TEMPERATURE PLASTIC, UL94V-0, NAT. CONTACT: COPPER ALLOY. LATCH: STAINLESS STEEL, TIN PLATING.
- △ FINISH: CONTACT AREA: 0.00025 MIN GOLD PLATING ON 0.001 MIN ALL OVER NICKEL. SOLDERING AREA: 0.00005 MIN TO 0.00030 MAX GOLD PLATING.
- 3. TOLERANCES NON-ACCUMULATIVE.
- △ FINISH: CONTACT AREA: 0.00025 MIN GOLD PLATING ON 0.001 MIN ALL OVER NICKEL. SOLDERING AREA: BRIGHT TIN LEAD PLATING.
- △ PACKAGED 12 PIECES PER HARD TRAY.
- △ PART PACKED PER EIA IS-704 STANDARD. REEL DIAMETER SHALL BE 330mm. TAPE WIDTH SHALL BE 88mm AND TAPE PITCH SHALL BE 36mm.
- △ DATE CODE (4-DIGITS), LOCATED AS SHOWN. TO BE INTERPRETED AS FOLLOWS:
 DIGIT # 1 - LAST DIGIT OF YEAR.
 DIGITS # 2 AND # 3 - CALENDAR WEEK.
 DIGIT # 4 - DAY OF THE WEEK (WITH SUNDAYS AS DAY 1).

AVAILABLE	REMARKS	FINISH	POWER SUPPLY	POS	PART NUMBER
NIL	AVAILABLE	△	DRAM 3.3V	144	6-390114-1 △
NIL	AVAILABLE	△	DRAM 3.3V	144	3-390114-1 △
390114-1	NOT AVAILABLE	△	DRAM 3.3V	144	390114-4
NIL	AVAILABLE	△	DRAM 3.3V	144	390114-1

DRAWING NO: 114-1114 REV: A DATE: 11-11-88 DESIGNED BY: [blank] CHECKED BY: [blank] APPROVED BY: [blank]	DRAWING NO: 114-1114 REV: A DATE: 11-11-88 DESIGNED BY: [blank] CHECKED BY: [blank] APPROVED BY: [blank]	DATE: 6-20-87 BY: SORVAL TITLE: 144 POSITION, LOW PROFILE FOR DIMM TYPE MODULE PART NO: 00779-390114 CUSTOMER DRAWING	1140 ELECTRONICS SINGAPORE
---	---	---	-------------------------------

REV	DATE	DESCRIPTION	BY	CHK	APP
1		SEE SHEET 1			

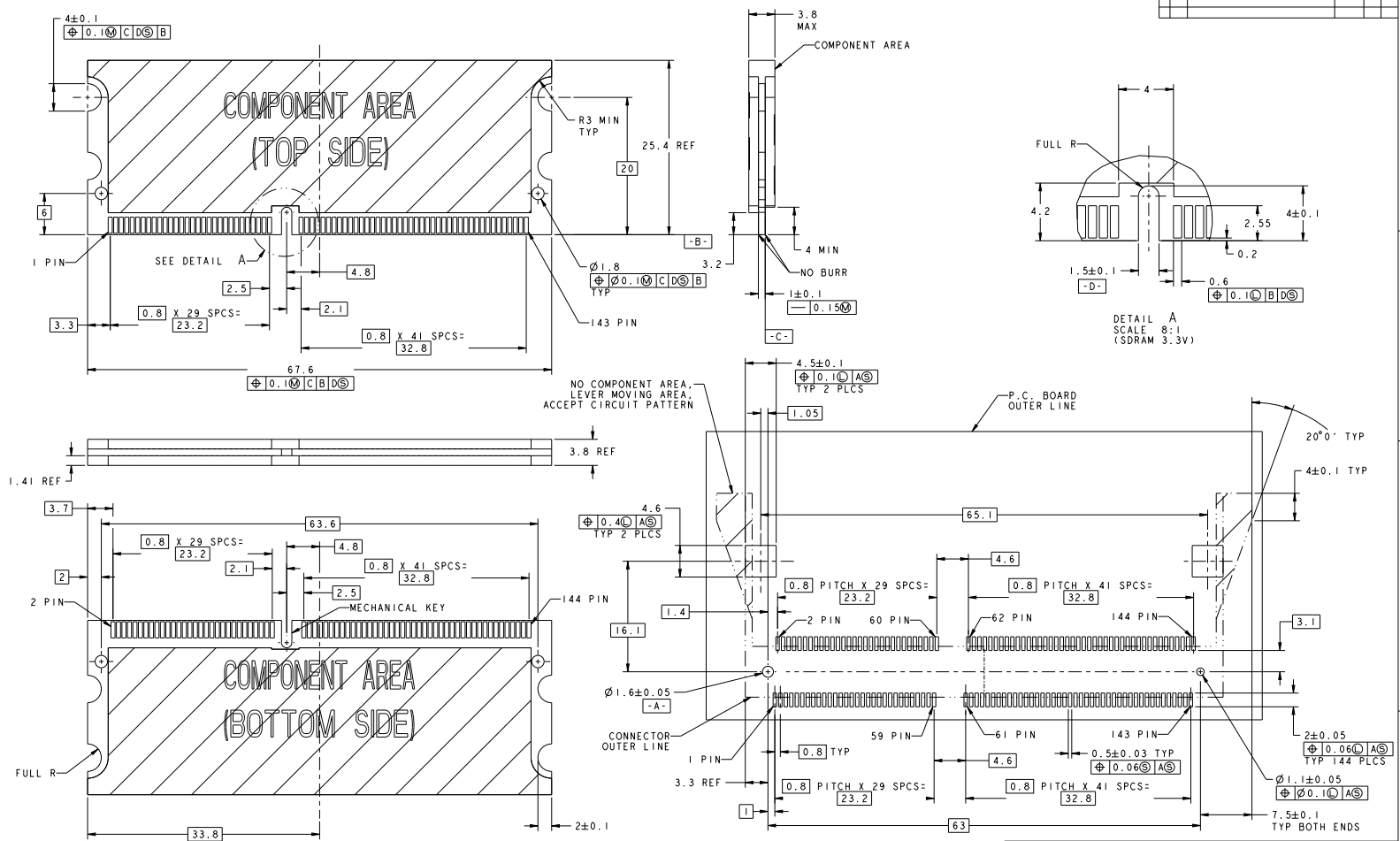

DRAWING NO: 114-1114 REV: A DATE: 15 SEP 2008 BY: JAP INCORPORATED	DRAWING NO: 114-1114 REV: A DATE: 15 SEP 2008 BY: JAP INCORPORATED	DRAWING NO: 114-1114 REV: A DATE: 15 SEP 2008 BY: JAP INCORPORATED	DRAWING NO: 114-1114 REV: A DATE: 15 SEP 2008 BY: JAP INCORPORATED	DRAWING NO: 114-1114 REV: A DATE: 15 SEP 2008 BY: JAP INCORPORATED	DRAWING NO: 114-1114 REV: A DATE: 15 SEP 2008 BY: JAP INCORPORATED
---	---	---	---	---	---