

REV	DATE	DESCRIPTION	BY	CHK	APP
1		REVISED PER ECR-10-007858	M		

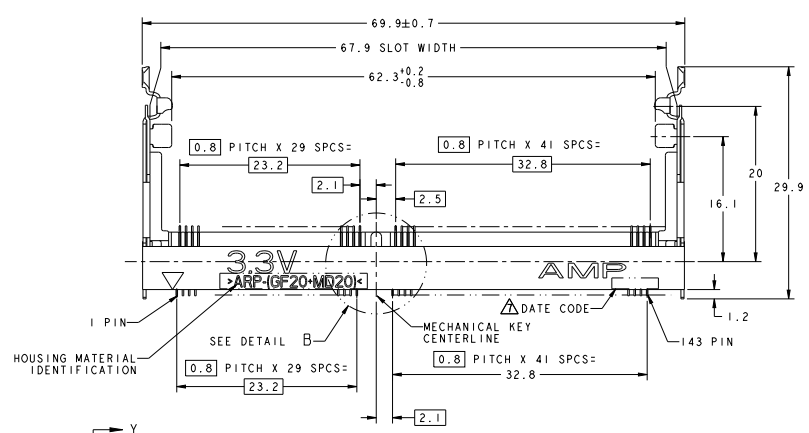

- △ MATERIAL:
HOUSING: HIGH TEMPERATURE PLASTIC, UL94V-0, NAT.
CONTACT: COPPER ALLOY
LATCH: SUS301 STAINLESS STEEL PLATING.
- △ FINISH: CONTACT AREA: 0.00025 MIN GOLD PLATE ON 0.001 MIN ALL OVER NICKEL
SOLDERING AREA: 0.00005 MIN TO 0.00030 MAX GOLD PLATE.
- 3. TOLERANCES NON-ACCUMULATIVE.
- △ PACKAGED 12 PIECES PER HARD TRAY.
- △ FINISH: CONTACT AREA: 0.00025 MIN GOLD PLATE ON 0.001 MIN ALL OVER NICKEL
SOLDERING AREA: BRIGHT TIN LEAD PLATE.
- △ PART PACKAGED PER EIA-18704 STANDARD. REEL DIAMETER SHALL BE 330mm. TAPE WIDTH SHALL BE 88mm AND TAPE PITCH SHALL BE 36mm.
- △ DATE CODE (4-DIGITS), LOCATED AS SHOWN. TO BE INTERPRETED AS FOLLOWS:
DIGIT # 1 - LAST DIGIT OF YEAR.
DIGITS # 2 AND # 3 - CALENDAR WEEK.
DIGIT # 4 - DAY OF THE WEEK (WITH SUNDAYS AS DAY 1).

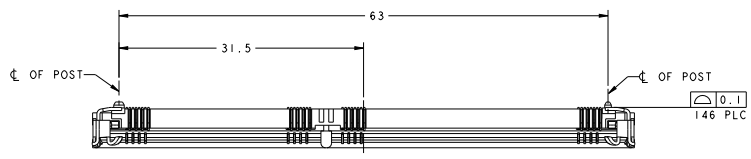
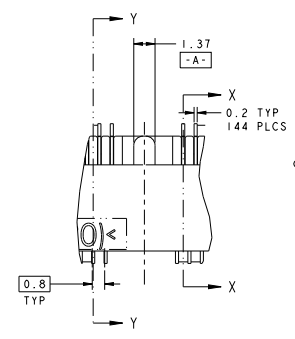
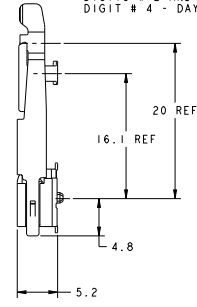

DETAIL B
SCALE 8:1

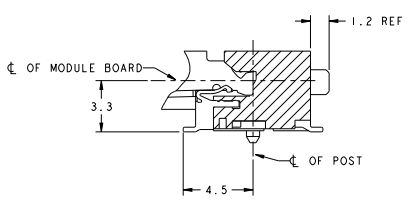

SECTION X-X
ROTATED 90° CCW
SCALE 8:1

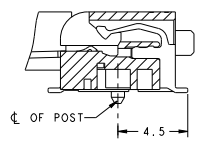

SECTION Y-Y
ROTATED 90° CCW
SCALE 8:1

NIL	AVAILABLE	△	DRAM 3.3V	I44	6-390113-1	△
3-390113-1	NOT AVAILABLE	△	DRAM 3.3V	I44	3-390113-4	△
NIL	AVAILABLE	△	DRAM 3.3V	I44	3-390113-1	△
390113-1	NOT AVAILABLE	△	DRAM 3.3V	I44	390113-4	
NIL	AVAILABLE	△	DRAM 3.3V	I44	390113-1	

SUPERSEDED BY	REMARKS	FINISH	POWER SUPPLY	POS	PART NUMBER

SYMBOL	mm	DESCRIPTION	DATE	BY	APP
1	0.8	0.8mm PITCH	8/20/97	M	
2	1.37	1.37mm HEIGHT	8/20/97	M	
3	0.2	0.2mm TYPICAL PITCH	8/20/97	M	
4	1.2	1.2mm REFERENCE HEIGHT	8/20/97	M	
5	4.5	4.5mm POST DIAMETER	8/20/97	M	
6	3.3	3.3mm BOARD THICKNESS	8/20/97	M	
7	0.1	0.1mm TOLERANCE	8/20/97	M	
8	0.8	0.8mm PITCH	8/20/97	M	
9	0.8	0.8mm PITCH	8/20/97	M	
10	0.8	0.8mm PITCH	8/20/97	M	
11	0.8	0.8mm PITCH	8/20/97	M	
12	0.8	0.8mm PITCH	8/20/97	M	
13	0.8	0.8mm PITCH	8/20/97	M	
14	0.8	0.8mm PITCH	8/20/97	M	
15	0.8	0.8mm PITCH	8/20/97	M	
16	0.8	0.8mm PITCH	8/20/97	M	
17	0.8	0.8mm PITCH	8/20/97	M	
18	0.8	0.8mm PITCH	8/20/97	M	
19	0.8	0.8mm PITCH	8/20/97	M	
20	0.8	0.8mm PITCH	8/20/97	M	
21	0.8	0.8mm PITCH	8/20/97	M	
22	0.8	0.8mm PITCH	8/20/97	M	
23	0.8	0.8mm PITCH	8/20/97	M	
24	0.8	0.8mm PITCH	8/20/97	M	
25	0.8	0.8mm PITCH	8/20/97	M	
26	0.8	0.8mm PITCH	8/20/97	M	
27	0.8	0.8mm PITCH	8/20/97	M	
28	0.8	0.8mm PITCH	8/20/97	M	
29	0.8	0.8mm PITCH	8/20/97	M	
30	0.8	0.8mm PITCH	8/20/97	M	
31	0.8	0.8mm PITCH	8/20/97	M	
32	0.8	0.8mm PITCH	8/20/97	M	
33	0.8	0.8mm PITCH	8/20/97	M	
34	0.8	0.8mm PITCH	8/20/97	M	
35	0.8	0.8mm PITCH	8/20/97	M	
36	0.8	0.8mm PITCH	8/20/97	M	
37	0.8	0.8mm PITCH	8/20/97	M	
38	0.8	0.8mm PITCH	8/20/97	M	
39	0.8	0.8mm PITCH	8/20/97	M	
40	0.8	0.8mm PITCH	8/20/97	M	
41	0.8	0.8mm PITCH	8/20/97	M	
42	0.8	0.8mm PITCH	8/20/97	M	
43	0.8	0.8mm PITCH	8/20/97	M	
44	0.8	0.8mm PITCH	8/20/97	M	
45	0.8	0.8mm PITCH	8/20/97	M	
46	0.8	0.8mm PITCH	8/20/97	M	
47	0.8	0.8mm PITCH	8/20/97	M	
48	0.8	0.8mm PITCH	8/20/97	M	
49	0.8	0.8mm PITCH	8/20/97	M	
50	0.8	0.8mm PITCH	8/20/97	M	
51	0.8	0.8mm PITCH	8/20/97	M	
52	0.8	0.8mm PITCH	8/20/97	M	
53	0.8	0.8mm PITCH	8/20/97	M	
54	0.8	0.8mm PITCH	8/20/97	M	
55	0.8	0.8mm PITCH	8/20/97	M	
56	0.8	0.8mm PITCH	8/20/97	M	
57	0.8	0.8mm PITCH	8/20/97	M	
58	0.8	0.8mm PITCH	8/20/97	M	
59	0.8	0.8mm PITCH	8/20/97	M	
60	0.8	0.8mm PITCH	8/20/97	M	
61	0.8	0.8mm PITCH	8/20/97	M	
62	0.8	0.8mm PITCH	8/20/97	M	
63	0.8	0.8mm PITCH	8/20/97	M	
64	0.8	0.8mm PITCH	8/20/97	M	
65	0.8	0.8mm PITCH	8/20/97	M	
66	0.8	0.8mm PITCH	8/20/97	M	
67	0.8	0.8mm PITCH	8/20/97	M	
68	0.8	0.8mm PITCH	8/20/97	M	
69	0.8	0.8mm PITCH	8/20/97	M	
70	0.8	0.8mm PITCH	8/20/97	M	
71	0.8	0.8mm PITCH	8/20/97	M	
72	0.8	0.8mm PITCH	8/20/97	M	
73	0.8	0.8mm PITCH	8/20/97	M	
74	0.8	0.8mm PITCH	8/20/97	M	
75	0.8	0.8mm PITCH	8/20/97	M	
76	0.8	0.8mm PITCH	8/20/97	M	
77	0.8	0.8mm PITCH	8/20/97	M	
78	0.8	0.8mm PITCH	8/20/97	M	
79	0.8	0.8mm PITCH	8/20/97	M	
80	0.8	0.8mm PITCH	8/20/97	M	
81	0.8	0.8mm PITCH	8/20/97	M	
82	0.8	0.8mm PITCH	8/20/97	M	
83	0.8	0.8mm PITCH	8/20/97	M	
84	0.8	0.8mm PITCH	8/20/97	M	
85	0.8	0.8mm PITCH	8/20/97	M	
86	0.8	0.8mm PITCH	8/20/97	M	
87	0.8	0.8mm PITCH	8/20/97	M	
88	0.8	0.8mm PITCH	8/20/97	M	
89	0.8	0.8mm PITCH	8/20/97	M	
90	0.8	0.8mm PITCH	8/20/97	M	
91	0.8	0.8mm PITCH	8/20/97	M	
92	0.8	0.8mm PITCH	8/20/97	M	
93	0.8	0.8mm PITCH	8/20/97	M	
94	0.8	0.8mm PITCH	8/20/97	M	
95	0.8	0.8mm PITCH	8/20/97	M	
96	0.8	0.8mm PITCH	8/20/97	M	
97	0.8	0.8mm PITCH	8/20/97	M	
98	0.8	0.8mm PITCH	8/20/97	M	
99	0.8	0.8mm PITCH	8/20/97	M	
100	0.8	0.8mm PITCH	8/20/97	M	

REV	DATE	DESCRIPTION	BY	CHK	APP
1		SEE SHEET 1			

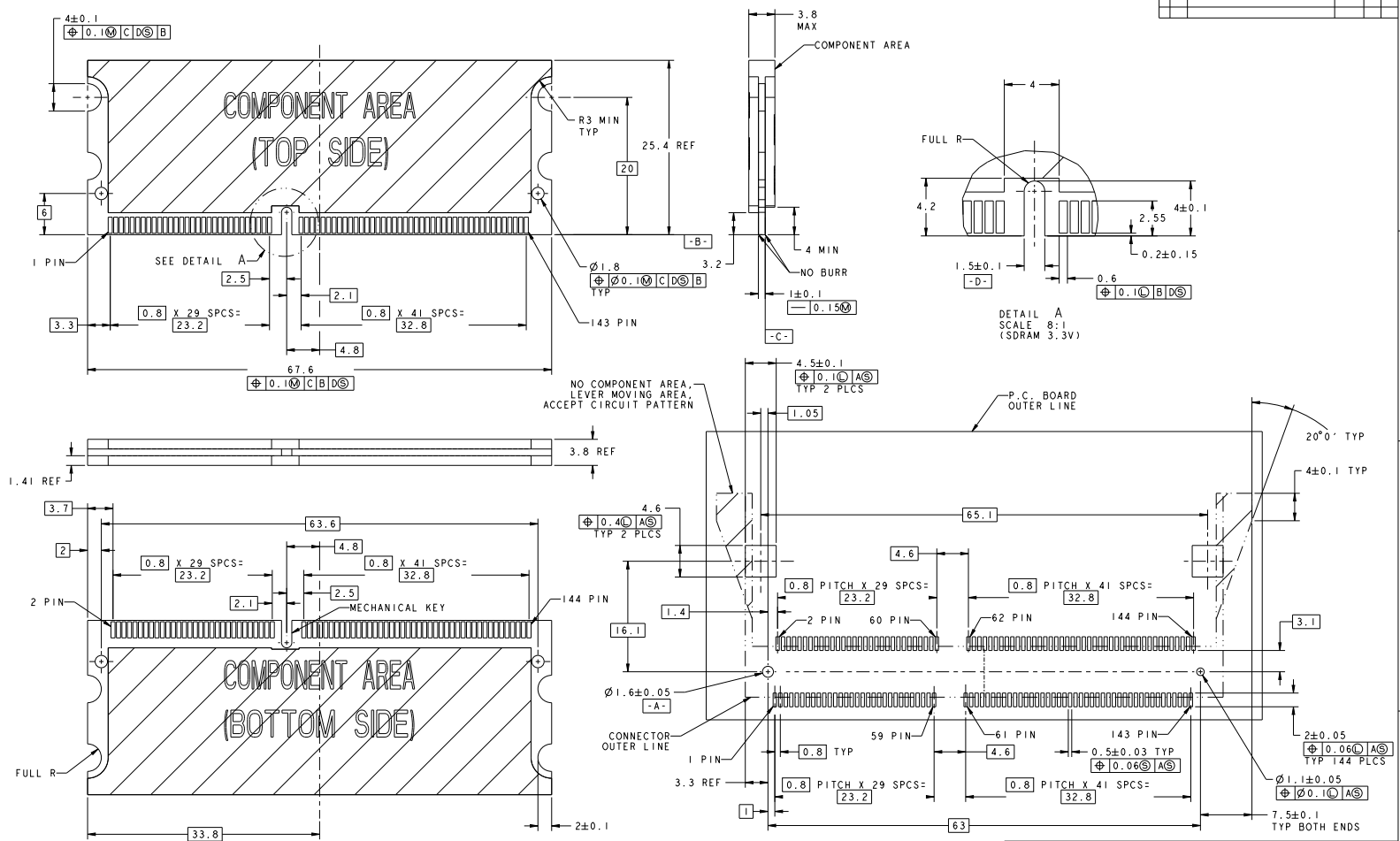

1100 ELECTRONICS SINGAPORE 1100 ELECTRONICS SINGAPORE 1100 ELECTRONICS SINGAPORE	1100 ELECTRONICS SINGAPORE 1100 ELECTRONICS SINGAPORE 1100 ELECTRONICS SINGAPORE	1100 ELECTRONICS SINGAPORE 1100 ELECTRONICS SINGAPORE 1100 ELECTRONICS SINGAPORE	1100 ELECTRONICS SINGAPORE 1100 ELECTRONICS SINGAPORE 1100 ELECTRONICS SINGAPORE
---	---	---	---